

**38000 GALLON
Septic Tank**

Single Compartment

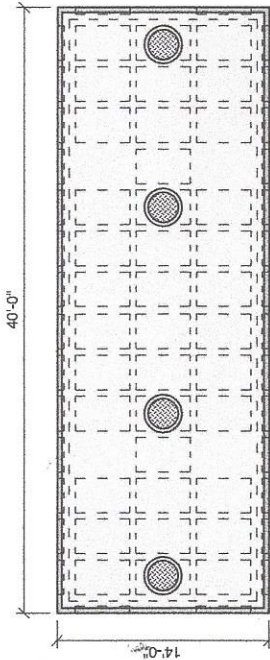

Top View

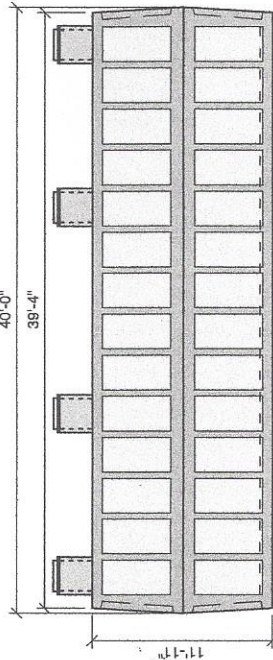

Side View

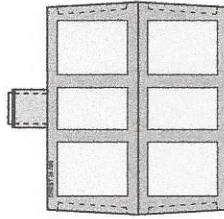

End View

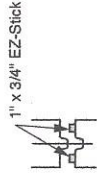

**Typical Tongue
& Groove Joint**

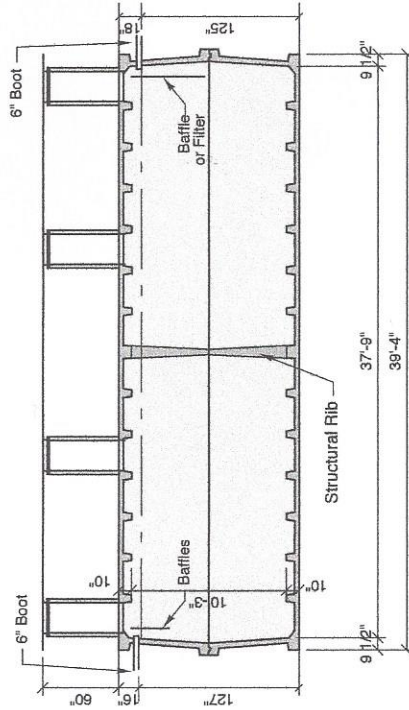

Section A-A

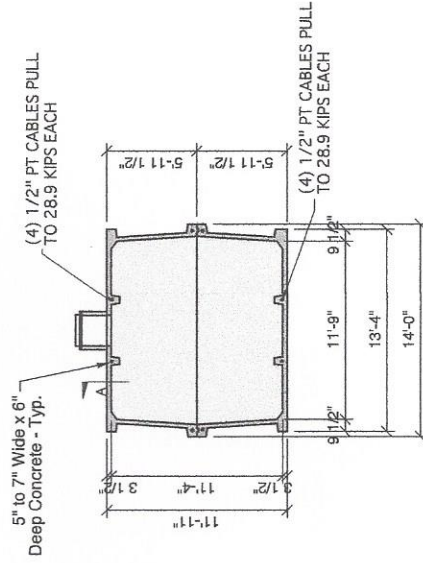

Section Thru Tank

Notes:
 Concrete - 6000 PSI
 Joint Sealant - High Grade EZ-Stick
 Labels - Warning signs located on all manholes
 Installation - See separate installation guide
 Baffles Installed
 Rubber Gaskets - Press Seal
 Tank Designed To ASTM C-1227-10 and ASTM 1613-10
 Tank Weights - 82,000 Lbs - Top Section
 82,000 Lbs - Bottom Section

Crest Precast, Inc.
 La Crescent, MN & Barneveld, WI
 600-668-6045

Model	1-20-16	Drawn By	KGT
Date		Revised	

Project: **38,000 Gallon Tank**

Contractor:

MODEL 38000