



## BXUV.U387 Fire Resistance Ratings - ANSI/UL 263

Page Bottom

### Fire Resistance Ratings - ANSI/UL 263

See General Information for Fire Resistance Ratings - ANSI/UL 263

**Design No. U387**

February 01, 2010

**Bearing Wall Rating — 1 HR**

**Load Restricted for Canadian Applications — See Guide [BXUV7](#)**

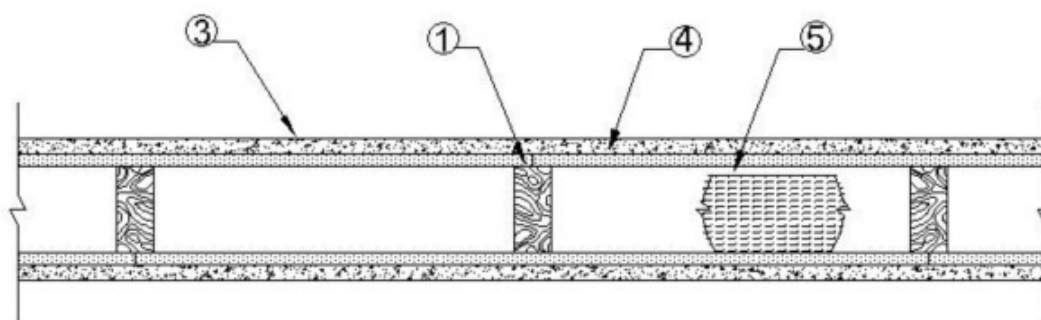

1. **Wood Studs** — Nom 2 by 4 in. spaced 16 in. OC max, effectively firestopped.
2. **Joints and Nail-Heads** — (**Not Shown**) — Exposed joints covered with joint compound and paper tape. Joint compound and paper tape may be omitted when square edge boards are used. As an alternate, nom 3/32 in. thick gypsum veneer plaster may be applied to the entire surface of Classified veneer baseboard with the joints reinforced with paper tape. Nailheads exposed or covered with joint compound.
3. **Gypsum Board\*** — 5/8 in. thick gypsum panels, with beveled, square, or tapered edges, applied either horizontally or vertically. Gypsum panels fastened to framing with 2 in. long Type W coarse thread gypsum panel steel screws spaced a max 8 in. OC, with last screw 1 in. from edge of board.

**AMERICAN GYPSUM CO** — Types AGX-1, Type AGX-11 or Type AG-C.

**BEIJING NEW BUILDING MATERIALS PUBLIC**

**LTD CO** — Type DBX-1.

**CERTAINEED GYPSUM INC** — Type 1, Type SF3, FRPC, ProRoc Type C, ProRoc Type X or Type EGRG

**CERTAINEED GYPSUM CANADA INC** — ProRoc Type C, ProRoc Type X or ProRoc Type Abuse-Resistant

**CANADIAN GYPSUM COMPANY** — Type AR, Type C, Type FCV, Type IP-AR, Type IPC-AR, Type IP-X1, Type IP-X2, Type SCX, Type SHX, Type WRC or Type WRX .

**GEORGIA-PACIFIC GYPSUM L L C** — Type 5, Type 6, Type 9, Type C, Type DGG, Type GPFS1, Type GPFS2, Type GPFS6, Type DS, Type DAP, Type DD, Type DA.

**LAFARGE NORTH AMERICA INC** — Type LGFC2, Type LGFC3, Type LGFC6, Type LGFC-C, Type LGFC6A, Type LGFC2A or Type LGFC-C/A.

**NATIONAL GYPSUM CO** — Type FSK, Type FSK-G, Type FSW, Type FSW-2, Type FSW-3, Type FSW-5, Type FSW-G, Type FSK-C, Type FSW-C or Type FSMR-C.

**PABCO BUILDING PRODUCTS L L C, DBA**

**PABCO GYPSUM** — Types C, PG-2, PG-3, Types PG-3W, PG-5W, Type PG-4, Type PG-6, Types PG-3WS, PG-5WS, Types PG-5, PG-9 or Type PG-C.

**PANEL REY S A** — Type PRX.

**SIAM GYPSUM INDUSTRY (SARABURI) CO LTD** — Type EX-1.

**TEMPLE-INLAND** — Type X, Veneer Plaster Base - Type X, Water Rated - Type X, Sheathing - Type X, Soffit - Type X.

**UNITED STATES GYPSUM CO** — Type AR, Type SCX, Type C, Type WRX, Type WRC, Type IP-X1, Type FCV, Type IP-X2, Type SHX, Type FRX-G, Type IP-AR, Type IPC-AR.

**USG MEXICO S A D E C V** — Type AR, Type C, Type WRX, Type WRC, Type IP-X1, Type FCV, Type IP-X2, Type SHX, SCX, Type IP-AR, Type IPC-AR.

4. **Mineral and Fiber Board** — 1/2 in. thick 4 ft wide, square edge, applied vertically to both sides of the assembly. Installed with 2 in. long Type W bugle head coarse thread gypsum board screws.

**BLUE RIDGE FIBERBOARD INC** — SoundStop

5. **Batts and Blankets\*** — 3-1/2 in thick glass fiber or mineral wool insulation shall be placed to completely fill the stud cavities and may be friction fit or secured to the studs with staples, nails or screws.

**CERTAINTED CORP**

**GUARDIAN FIBERGLASS INC**

**JOHNS MANVILLE INTERNATIONAL INC**

**KNAUF INSULATION GMBH**

**OWENS CORNING HT INC, DIV OF OWENS**

**CORNING** — Corning Fiberglas Corp.

**ROCK WOOL MANUFACTURING CO** — Delta Board.

**ROXUL INC**

**THERMAFIBER INC** — Type SAFB.

5A. **Glass Fiber Insulation** — (As an alternate to Item 5) — 3-1/2 in. thick glass fiber batts with a minimum density of 0.65 pcf either generic or bearing the UL Classification Marking as to Surface Burning and/or Fire Resistance, placed to fill the interior of the wall, friction fit or mechanically attached to the face of the studs. See **Batts and Blankets** (BKNV or BZJZ) Categories for names of Classified companies.

5B. **Fiber, Sprayed\*** — (Not Shown) As an Alternate to Items 5 and 5A - Spray applied granulated mineral fiber material. The fiber is applied with water to completely fill the enclosed cavity in accordance with the application instructions supplied with the product. See **Fiber, Sprayed** (BNST).

**AMERROCK PRODUCTS L P** — Rockwool

\*Bearing the UL Classification Mark

Last Updated on 2010-02-01

---

[Questions?](#)

[Print this page](#)

[Notice of Disclaimer](#)

[Page Top](#)

Copyright © 2011 Underwriters Laboratories Inc.®

The appearance of a company's name or product in this database does not in itself assure that products so identified have been manufactured under UL's Follow-Up Service. Only those products bearing the UL Mark should be considered to be Listed and covered under UL's Follow-Up Service. Always look for the Mark on the product.

UL permits the reproduction of the material contained in the Online Certification Directory subject to the following conditions: 1. The Guide Information, Designs and/or Listings (files) must be presented in their entirety and in a non-misleading manner, without any manipulation of the data (or drawings). 2. The statement "Reprinted from the Online Certifications Directory with permission from Underwriters Laboratories Inc." must appear adjacent to the extracted material. In addition, the reprinted material must include a copyright notice in the following format: "Copyright © 2011 Underwriters Laboratories Inc.®"

An independent organization working for a safer world with integrity, precision and knowledge.

