

Main Capitol Basement and Lower (Concourse) Level East Wing

Commonwealth Avenue

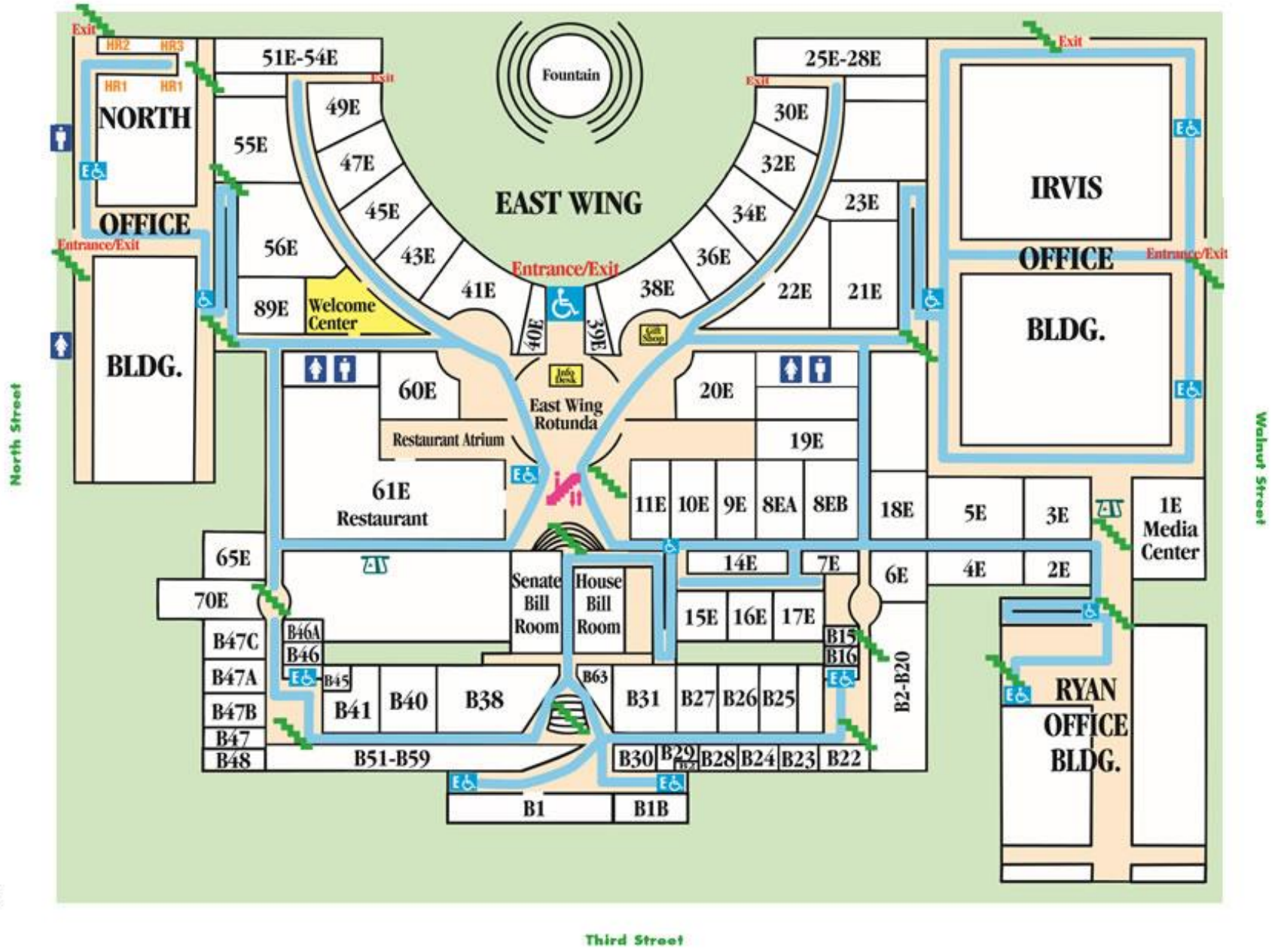

KEY:

-  Access
-  HR Hearing Room
-  ATM
-  Escalator
-  Ladies Restroom
-  Interior Walkway
-  Accessible Elevator
-  Elevator
-  Stairs
-  Men's Restroom
-  Accessible Walkway

Commonwealth Avenue

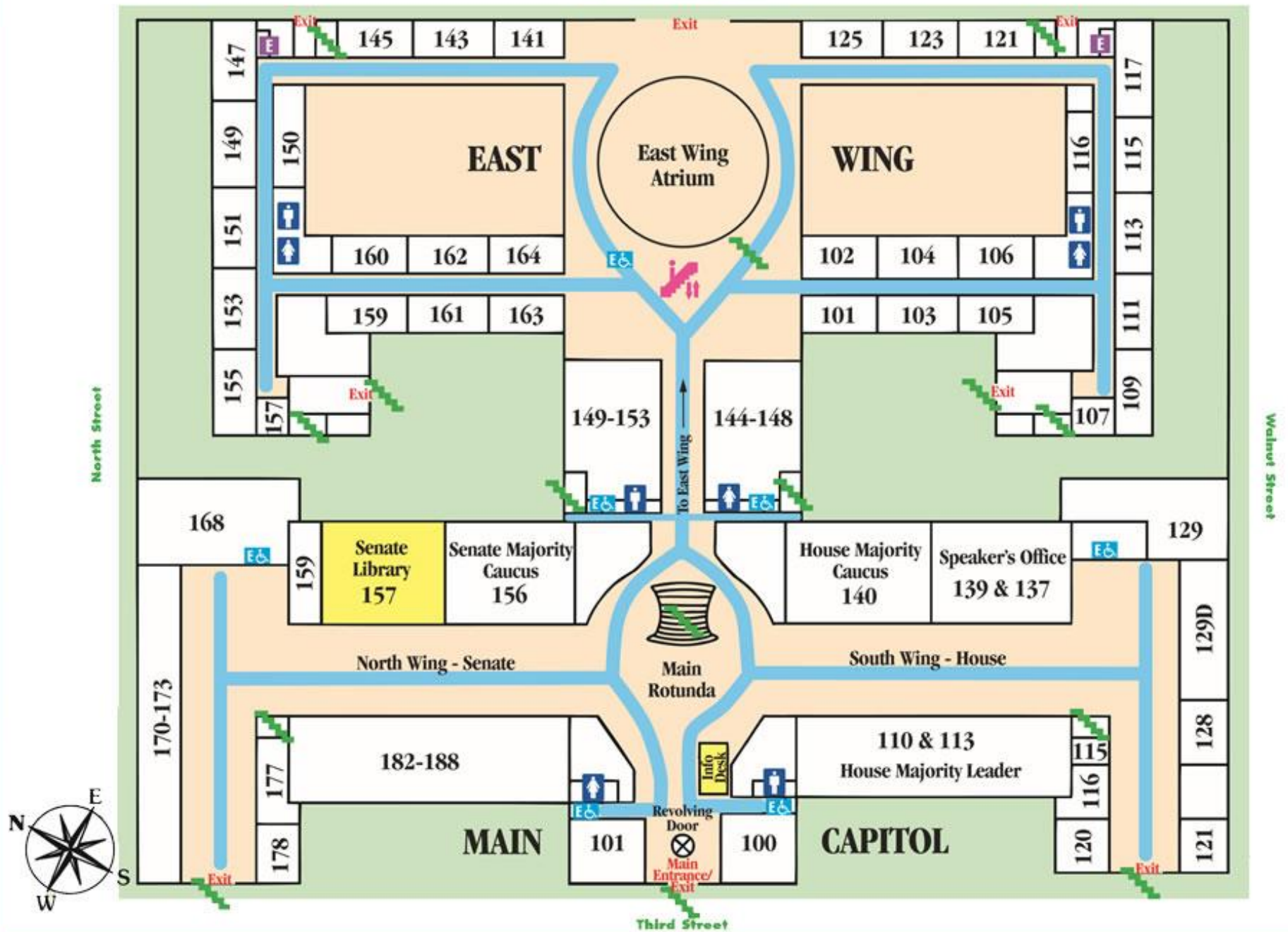

Main Capitol First Floor and Upper Level East Wing

Room Locations for the Capitol and East Wing

| | North Wing Senate | South Wing House | Front & Rear Rotunda | East Wing |
|---------------------------|-------------------|------------------|---|--|
| Basement | 38-59 | 2-31 | B1B, B1, B2, Vending Machines, Bill Rooms | Lower Level South: 1E-39E Lower Level North: 40E-89E & Welcome Center |
| First Floor | 156-188 | 110-140 | 100, 101 (front) 144-153 (back) | Upper Level: 101-125 (south) 141-164 (north) |
| E-Floor (Entresol) | 531-549A | 508-517 | 519-528 (back) | |
| Second Floor | 264-299 | 225-238 | 200-202 (front) 216-245, Mail Room | |
| Third Floor | 337-366 | 304-316 | 300 (north) 302 (south) 322-333 | |
| Fourth Floor | 451-468 | 406A-428 | 401, Senate & House Galleries (front), Supreme Court Room, 431-439 (back) | |
| Fifth Floor | 632-648 | 603 - 629 | 600-602 (front) 629-630 | |