

# PERSONALIZED SUPPORT THAT FEELS LIKE A DREAM. THIS IS CLOUDSWAP™ TECHNOLOGY.

## Velour Cover

- Made with 100% polyester
- Soft, plush finish that promotes breathable comfort

## PlushCell™ Memory Foam

- High-density plush memory foam
- Conforms and adapts to your wrists and elbows while alleviating pressure

## High-Density Support Plate

- Optimal firmness
- Designed specifically for Secretlab TITAN Evo

The Secretlab PlushCell™ Memory Foam Armrest Top you hold is created as part of our CloudSwap™ family of hot-swappable armrests, designed specifically for your Secretlab TITAN Evo chair.

Made for those who crave the softest touch. Secretlab PlushCell™ armrests feature tri-layered construction for a high-performance blend of ultra-soft and supportive comfort. Enjoy breathability, pillow-like softness, and sturdy base support all at once — perfect for hours of work or play.

Go forth and experience the next level of comfort.

## INSTALLATION GUIDE

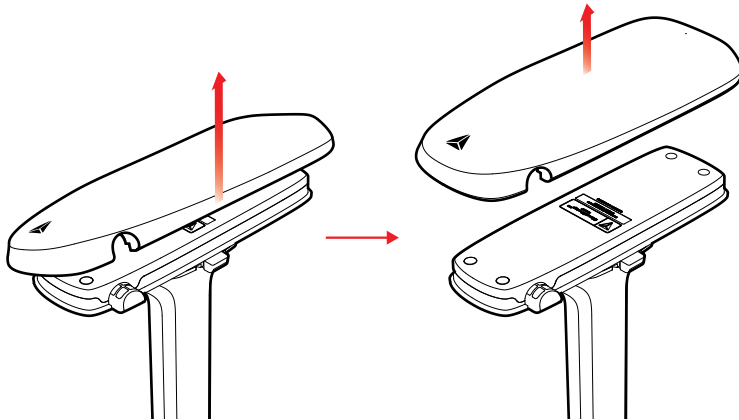
**01. Detaching the armrest tops**

To detach the armrest top, grip the armrest top in the middle and gently lift the inner edge of the armrest at an angle. The armrest top should then pop out.

**Note:**

Only for CloudSwap™ Compatible Armrest Tops.

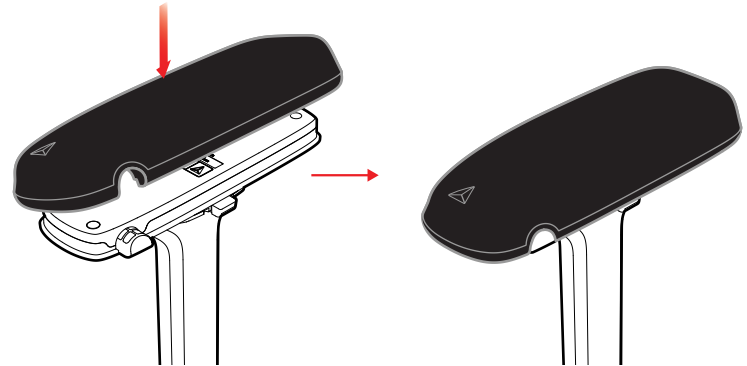
**02. Installing the Memory Foam Armrest Tops**

Grip the middle section of the new armrest top and set the outer edge down at an angle. Next, gently lower the inner edge of the armrest top. The armrest top should snap in place over the armrest mechanism.

**Note:**

Only for CloudSwap™ Compatible Armrest Tops.

## AFTERCARE GUIDE

**Do not use your armrests outside of its intended usage**

Improper use can damage your armrest or even cause injuries. To ensure your safety, please always follow the given instructions.

**General Cleaning**

Like all fabrics, velour may become dirty over time. For general cleaning, dust the velour surface gently with a clean, dry cloth. Do not rub the velour harshly to avoid damaging it.

**Avoid contact with all liquids**

Velour is not water-resistant. Spills should be immediately blotted up with a dry cloth or paper towel. Do not rub the fabric, as this may cause the stain to set.

**Do not use abrasive scrubbers or harsh cleaners**

Avoid the use of alcohol-based cleaners, abrasive cleaners as they can damage the velour fabric on the armrest top.

**Do not abuse it**

Even the toughest of armrests will not be able to stand up to rough and inappropriate use. Keep your armrests away from heavy objects, impacts, drops and sharp objects.

**Avoid heat**

Avoid the use of a hair dryer or any other heat source to dry the product. Always leave to air dry.

**Need any help?**

For additional support and full warranty terms and conditions, please scan the QR code or visit our website

[secretlab.co/support](https://secretlab.co/support)

**Other Languages**

To view this manual in the following languages, please scan the QR Code to the left.

Pour consulter ce manuel dans les langues suivantes, veuillez scanner le QR code à gauche.

Um dieses Handbuch in den folgenden Sprachen anzuzeigen, scannen Sie bitte den QR-Code auf der linken Seite.

Scan de QR-code naar links om deze handleiding in de volgende talen te bekijken.

本マニュアルを以下の言語でご覧になるには、左のQRコードをスキャンしてください。

이 설명서를 다음 언어로 보시려면 왼쪽에 있는 QR 코드를 스캔하세요.

เพื่อดูคู่มือนี้ในภาษาต่าง ๆ โปรดสแกน QR Code ที่อยู่ด้านซ้าย

Để xem số tay hướng dẫn này bằng ngôn ngữ khác, vui lòng quét Mã QR ở bên trái.

Untuk melihat panduan ini dalam bahasa lainnya, silakan scan QR code di sebelah kiri.

لعرض هذا الدليل باللغات التالية، يرجى إجراء مسح ضوئي لرمز الاستجابة السريعة QR الموضح على الجانب