

OWNER'S / OPERATOR'S MANUAL

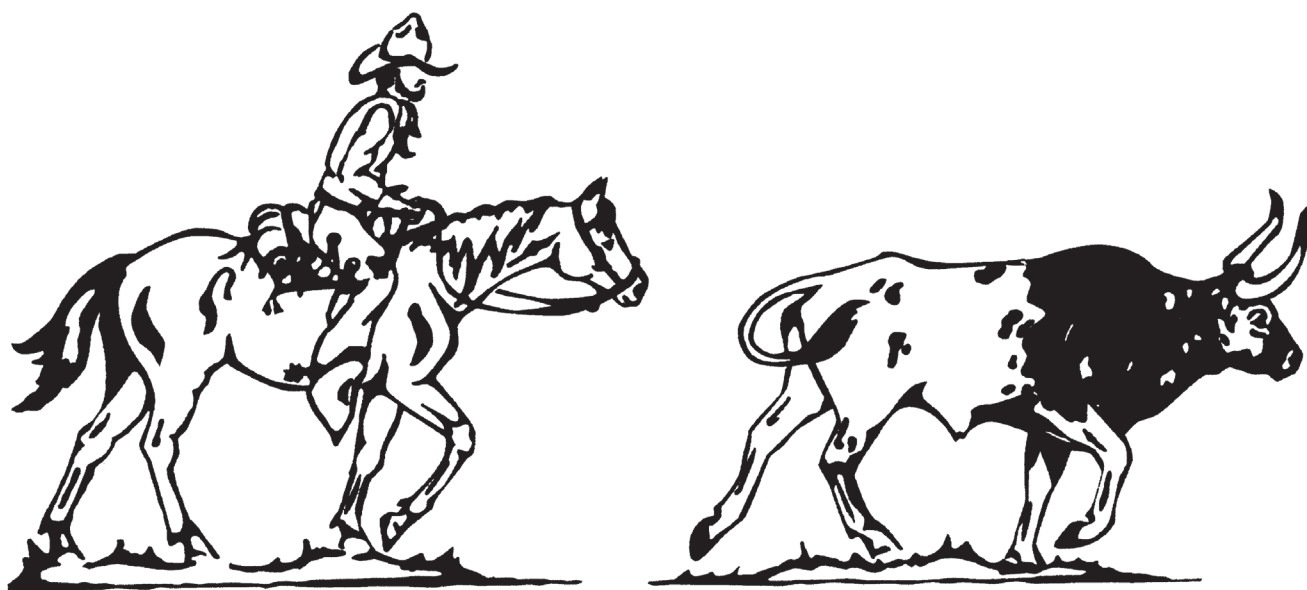

DURALITE

For Models AL15, AL 20, AL25, AL30 & AL35

DURALITE TRAILERS, LLC

Duralite Aluminium Livestock Trailer



Introduction

To our customer:

This manual has been prepared to help you operate and maintain your new Duralite Trailer safely. Should you have any questions, contact a Duralite factory representative immediately for a clear explanation. We thank you for your patronage and confidence in us through the purchase of your new Duralite Trailer.

Effective Date: April 10, 2007

▼ Warning ▼

DO NOT operate or service this trailer without reading and understanding this operators manual. If manual is lost, contact the factory for a new one.

▼ TAKE NOTE! This safety-alert symbol found throughout this manual is used to call your attention to instructions involving your personal safety and the safety of others. Failure to follow these instructions can result in injury or death.

If ownership of this trailer changes, this manual should accompany the trailer.

Table of Contents

| <u>Description</u> | <u>Page No.</u> |
|--|------------------------|
| Assistance & Reporting Safety Defects | 26 |
| Axle Assembly | 20 |
| Break Operation & Trouble Shooting Guide | 19 |
| Certification Label | 4 |
| Certificate of Warranty & Environmentally Consumable Goods . . . | 24 |
| Electrical Brake Assembly | 16-17 |
| Electrical & Wiring Diagrams | 14-15 |
| Extended Warranty Schedule | 25 |
| General Specifications | 15 |
| Hub & Drum Assembly | 18 |
| Introduction | 1 |
| Maintenance Schedule | 12 |
| Notice & Operating Instructions | 10 |
| Parts List | 23 |
| Pre-Trip Inspection & Maintenance Instructions | 11 |
| Safety Section | 6-9 |
| Slipper Spring Assembly | 21 |
| Warning & Table of Contents | 3 |
| Warranty Registration Form | 5 |
| Wheel Mounting | 13 |

CERTIFICATION LABEL

Located on the left front side of the trailer.

| | | | | |
|--|--|--|--|---|
| DATE | | | | Manufactured By DURALITE TRAILERS, LLC CLARK, SOUTH DAKOTA 57225 |
| GVWR/ PNBV | | LBS. UNIFORMLY DISTRIBUTED KG. UNIFORMÉMENT RÉPARTI | | |
| GAWR/ PNBE | | LBS. ALL AXLES KG. TOUS LES ESSIEUX | | |
| GAWR/ PNBE | | LBS. MAXIMUM PER AXLE KG. MAXIMUM PAR ESSIEUX | NO. OF AXLES NOMBRE D'ESSIEUX | |
| TIRES PNEU | | RATING ESTIMATION | RIMS JANTE | AT À |
| | | | | PSI COLD KGS/COLD |
| This vehicle conforms to all applicable U.S. Federal motor vehicle safety standards in effect on the date of manufacture shown above. This vehicle conforms to all applicable standards prescribed under the Canadian motor vehicle safety regulations in effect on the date of manufacture. - ce vehicule est conforme a toutes les normes qui lui sont applicables en vertu du reglement sur la securite des vehicules automobiles du canada en vigueur a la date de sa fabrication. | | | | |
| VIN / NIV | | | | |
| TYPE | | BODY / CHÂSSIS | | MODEL / MODÈLE |

GVWR (Gross Volume Weight Rating) Uniformly distributed, is the structural capability of the trailer when supported by the hitch and axles with the load uniformly distributed throughout the cargo space.

GAWR (Gross Axle Weight Rating) Is the structural capability of the lowest rated member of the running gear component parts; Hangers, springs, axle, hub, bearings, brakes, drum, wheels, or tires. This means if the axle is rated at 7000 lb but the tire is rated at 2780 lb single at 75 PSI cold and there are two tires per axle, the result is 2780 lb x 2 = 5560 lb. The GAWR shall be 5560 lb per axle. The tire being the lowest rated member. Another example would be, if the axle assembly was rated at 7000 lb and the wheel was rated at 3045 lb 80 PSI cold, the tire rated at 3460 lb single at 120 PSI cold, the wheel would be the lowest rated member. There are two wheels per axle, 2 x 3045 lb = 6090 lb. The GAWR shall be 6090 lb per axle.

AWR (Axle Weight Rating) Is the axle manufacture's rating of the structural capability of the axle bare beam, bearings, hub drum, brakes and springs.

Warranty Registration Form and Dealer Inspection Report

WARRANTY REGISTRATION

This form shall be filled by the dealer and signed by both dealer and buyer at time of delivery and within **fifteen days** of sale of trailer. Return white copy to: Duralite Trailers, LLC., 100 Warren Road, PO Box 255, Clark, SD 57225. **Failure to comply results in dealership assuming responsibility,**

Buyer's Name

Dealer's Name

Drivers License (SD)

Address

Address

City, State, Zip Code

City, State, Zip Code

()

Phone

()

Phone

Model _____ Vin _____ Delivery Date _____

Dealer Inspection Report

_____ Fasteners Tight

_____ Jack Operation

_____ Wheel Bolts Tight

_____ Gate Locks

_____ Tire Pressure

_____ Adjust Hitch Coupler

_____ Lights

_____ Brakes

_____ Decals & Reflector Tape

_____ Safety Chain

_____ Hitch Pins

_____ Review Operating & Safety

Inspected By _____ Date _____

I have thoroughly instructed the buyer on the above described trailer, review included the "Operators Manual Content", equipment care, adjustments, safe operation and applicable warranty policy.

Date _____ Dealer's Signature _____

The above trailer and "Operators Manual" have been received by me and I have been thoroughly instructed as to care, adjustments, safe operation and applicable warranty policy.

Date _____ Buyer's Signature _____

| | | |
|--------------|--------|----------|
| White | Canary | Pink |
| Manufacturer | Dealer | Customer |

SAFETY SECTION

Safety Alert Symbol Explanation



This Symbol Means
Attention!
Become Alert!
Your Safety Is Involved

Signal Words Explanation

DANGER: Indicates an imminently hazardous situation that, if not avoided, will result in death or serious injury. The word **DANGER** is in white letters on a Red background.

WARNING: Indicates a potentially hazardous situation that, if not avoided, could result in death or serious injury. The word **WARNING** is in Black letters on an Orange background.

CAUTION: Indicates a potentially hazardous situation that, if not avoided, could result in minor or moderate injury. It may also be used to alert against unsafe practices. The word **CAUTION** is in Black letters on a Yellow background.

ATTENTION: Indicates operational instructions, maintenance messages, lubrications, etc. The word **ATTENTION** is in Black letters on a Green background.

Keep safety signs clear and legible. Replace signs if missing or damaged. Refer to parts section for this purpose. Equip repaired trailers with new or updated safety signs.

The following are illustrations of safety signs and their location on a Duralite Livestock Trailer.

* Located on the left rear corner

ATTENTION

Be sure upper and lower cams are engaged when closing rear gate. Failure to do so will damage gate.

* Located on the left front side

ATTENTION

A loaded trailer must ride level. Use adjustable coupler for this purpose. Failure to level trailer may result in damage to tires, bearings and/or axles.

* Located on the left rear corner

ATTENTION

Roll-up tailgate must be in lower position before opening rear gate.

* Located on the left front side

⚠ CAUTION

DO NOT EXCEED MANUFACTURER'S VEHICLE WEIGHT RATINGS OR LOADING RECOMMENDATIONS.

* Located on the left rear corner

⚠ ATTENTION

Tailgate must be in closed position with latches secured when trailer is in use. Failure to do so may result in damage to trailer and/or injury to cargo.

* Located on the left front side

⚠ WARNING



Do not operate or service this trailer without reading & understanding the operators manual. If manual is lost contact the factory for a new one.

* Located on Breakaway Kit

SAFETY BREAKAWAY SYSTEM WILL NOT OPERATE UNLESS CONNECTED TO A POWER SOURCE EQUIVALENT TO OR GREATER THAN AUTO TYPE 12 VOLT 12 AMP HOUR WET CELL BATTERY.

* The following decal is vendor supplied with their product.

DUAL PIN

⚠ CAUTION

U.S. PATENT NUMBER: 5,423,518

SPRING LOADED DROP LEG



LOCKED POSITION TO LOWER LEG: **UNLOCKED POSITION**

1. Lower handle to released position with hand or foot.
2. Place foot on drop leg shoe and lower to desired extension.
3. Raise handle to locked position with hand or foot, then lift foot from shoe slowly. (Drop leg will automatically lock in next hole position.)
4. Rotate crank to extend leg until desired height is obtained.

TO RETRACT LEG:

1. Rotate crank to retract leg to minimum retracted position.

⚠ WARNING: Spring force can retract drop leg with impact. Keep hand and feet clear of impact area.

2. To raise drop leg, lower handle to released position with hand or foot. (Drop section will automatically retract.)

3. Raise handle to locked position with hand or foot.

* Located on the centergate

⚠ CAUTION

Center gate must be in closed position with latches secured when trailer is in use. Failure to do so may result in damage to trailer and/or injury to cargo.

* Located in center of left fender

⚠ CAUTION

Check wheel nuts after initial 50 to 100 miles of service. Torque to 90-95 PSI and periodically thereafter. Failure to do this results in damage and/or personal injury.

* Located on the left front side



* Located on the left rear corner



* Located on neck gate



! NOTICE !

DO NOT exceed the load ratings for your trailer.

DO NOT exceed the load ratings for your tow vehicle.

The towing vehicle and its attachments for towing trailers, such as but not limited to, hitch ball, hitch ball mounting bracket, safety chain hookup, brake controller, electrical connections, wiring harness and the correct installation of those and other attachments shall be the sole responsibility of the owner of the towing vehicle.

Duralite strongly recommends that the owner of the towing vehicle consult the maker of the vehicle for its capability and limitations for towing trailers of the size and weight category of the trailer to be towed. Attachments to the towing vehicle for the purpose of towing a trailer shall be installed by a qualified person according to vehicle maker's specifications and State and Federal regulations that may apply.

OPERATING INSTRUCTIONS

Attaching trailer to towing vehicle:

The trailer shall be connected to the towing vehicle by means of a ball and coupler. The ball is part of the towing vehicle. The coupler is part of the trailer hitch assembly. With towing vehicle properly located to the trailer, lower the hitch coupler over the ball by means of the trailer jack. With coupler completely engaged to the ball, install lock pin in coupler and hook latch on lock pin.

Coupler MUST BE PROPERLY LOCKED TO THE BALL

Connect safety chain(s) securely to tow vehicle. Connect electrical cable to tow vehicle, a 6 way female plug is provided on the cable. Retract drop leg on jack and crank to its highest position. Place crank handle in its carrier.

READ INSTRUCTIONS ON JACK DECAL

Check: All lights are in working order.

Test: Electric Brakes

Check: All gates and doors are closed and latched securely.

Check: Level of trailer. A trailer must ride level when loaded at maximum rated load, use adjustable coupler for this purpose. To adjust the coupler, disconnect trailer from towing vehicle and move towing vehicle away. Located on the right side of the coupler are three square head cup point set screws with jam nuts. Release jam nuts, hold bottom part of coupler and loosen set screws. Move bottom part of coupler up or down to desired position. Retighten set screws gradually, going from one set screw to the next several times, so set screws are uniformly tight. Tighten jam nuts and hitch trailer to towing vehicle.

PRE-TRIP INSPECTION

▼ **WARNING!** Be careful when making any inspections, hookups, and repairs to avoid personal injury. Park on level surface, make sure parking brakes are set or wheel chocks are in place to avoid movement of the trailer which could result in bodily injury.

- Check and clean all lights and reflectors.
- Check operation of brakes.
- Check tires for cuts or abnormal wear.
- Check air pressure in tires, inflate to pressure stated on the sidewall of the tire.
- Check wheels for cracks and breakage.
- Check wheel lug nuts, tighten to 90 ft. lbs. tork.
- Check all gate and door locks and hinges.
- Clean debris from around gate and door frames.

▼ **CAUTION** gate and door locks and hinges that show excessive wear should be replace immediately.

- Check for broken or loose bolts and rivets.
- Check for broken springs and hanger parts.
- Check for broken or loose bolts and parts on hitch.

▼ **WARNING** Replace loose or broken parts immediately. Failure to do so could result in injury or death.

MAINTENANCE INSTRUCTIONS

Do not use sand, salt or other abrasive materials for bedding, they will cause damage to the trailer.

Wash trailer inside and out as often as possible with car soap.

***NOTICE** Acid washing will damage the trailer.

MAINTENANCE SCHEDULE

| Item | Function | Break-In Service | Every Use | Monthly | 3 month / 3000 miles | 6 month / 6000 miles |
|-------------------------|---|--|-----------|---------|----------------------|----------------------|
| Brakes | Test that they are operational | Before first trip | ▼ | | | |
| Brake Adjustment | Adjust to proper operating clearance | After first 200 miles | | | ▼ | |
| Brake Hangers | Inspect for wear and current draw | | | | | ▼ |
| Brake Assembly | Adequate lubrication | | | | | ▼ |
| Brake Lining | Inspect for wear and contamination | | | | | ▼ |
| Brake Cylinders | Inspect for leaks and sticking | | | | | ▼ |
| Brake Lines | Inspect for cracks, leaks or kinks | | | | | ▼ |
| Brake Shoes | Inspect for brake drag | Every 50 miles for the first 200 miles | | | ▼ | |
| Trailer Brake Wiring | Inspect for bare spots, fray, etc on wires | | | | | ▼ |
| Brake Controller | Inspect for correct amperage and modulation | Before first trip | | | ▼ | |
| Breakaway Systems | Check battery for charge, switch placement, etc | | ▼ | | | |
| Hangers | Inspect welds | | | | | ▼ |
| Hinges | Lubrication | | | ▼ | | |
| Hull / Drum | Check for abnormal wear or scoring | | | | | ▼ |
| Jack | Lubrication | | | ▼ | | |
| Seals | Inspect for leakage, damage or wear | | | | | |
| Springs | Inspect for wear, loss or arch | Check after first 500 miles | | | | ▼ |
| Spring Eye Bushing | Inspect for wear | | | | | ▼ |
| Suspension Parts | Inspect for bending, loose fasteners, wear | Check after first 500 miles | | | | ▼ |
| Tire Inflation Pressure | Inflate to mfg's specifications | | ▼ | | | |
| Tire Condition | Inspect for cuts, wear, bulging, etc | | ▼ | | | |
| Wheels | Inspect for cracks, dents or distortion | Every 50 miles for the first 200 miles | | ▼ | | |
| Wheel Bearings and Cups | Inspect for corrosion, wear or damage | | | | | ▼ |
| Wheel Bolts & Nuts | Tighten to specified torque values | Every 50 miles for the first 200 miles | ▼ | | | |
| | | | | | | |

WHEEL MOUNTING

It is important to maintain proper torque specifications to provide safe and secure attachment of the wheel to the hub/drum. Be sure to use wheel nuts that are compatible with the coin in the wheel. Improperly torqued wheel nuts can cause the wheel to separate from the wheel mounting surface during operation. This could result in property damage, serious personal injury, or loss of life.

- * Start all lug bolts and nuts by hand to prevent cross threading.
- * Tighten lug bolts and nuts in three stages using a cross star pattern.
- * Wheel nut torque requirements vary depending on the size and manufacturer of the wheel. Always use the wheel manufacturer's recommendation but do not exceed 120 ft/lbs on 1/2" studs/ Unless otherwise specified by the wheel manufacturer, use a final torque of 85 – 90 ft/lbs, never exceed wheel manufacturer's recommendations.
- * Tighten each lug nut in the order shown to the torque shown in the chart.

TORQUE STAGES

| 1 st Stage | 2 nd Stage | 3 rd Stage |
|-----------------------|-----------------------|-----------------------|
| 20 / 25 | 55 / 60 | 85 / 95 |
| Ft. lbs. | Ft. lbs. | Ft. lbs. |

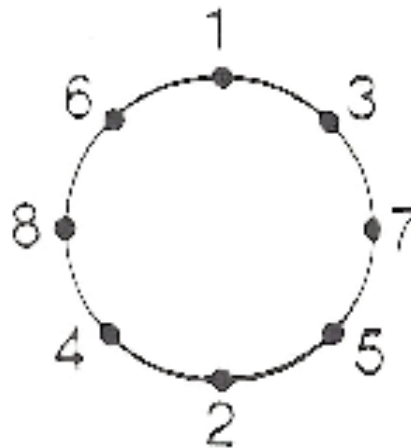

▲ **CAUTION!** Do not operate trailer with less than the required number of attaching bolts or nuts for wheels.

ELECTRICAL DIAGRAM

Terminal Block: Located on Hitch Coupler Assembly

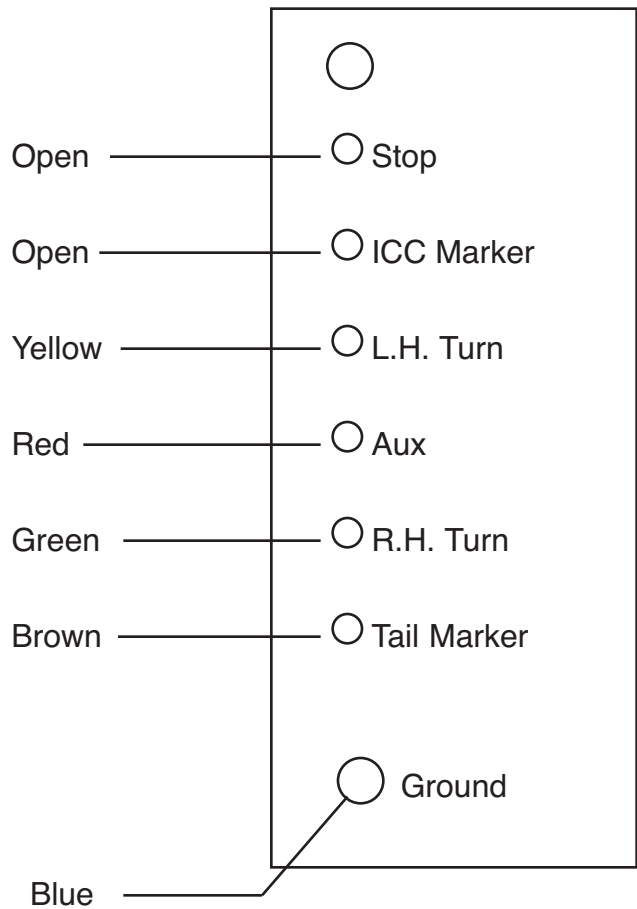

7 - Way RV

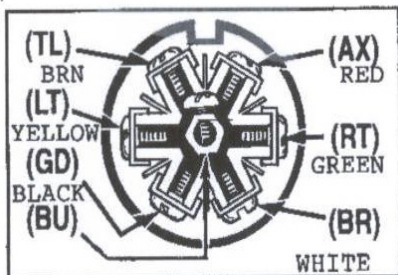

6 - Way Silver

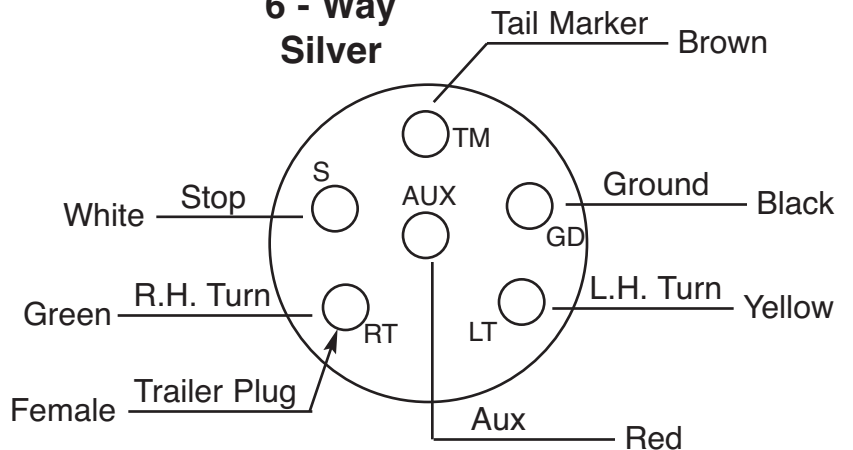

WIRING DIAGRAM

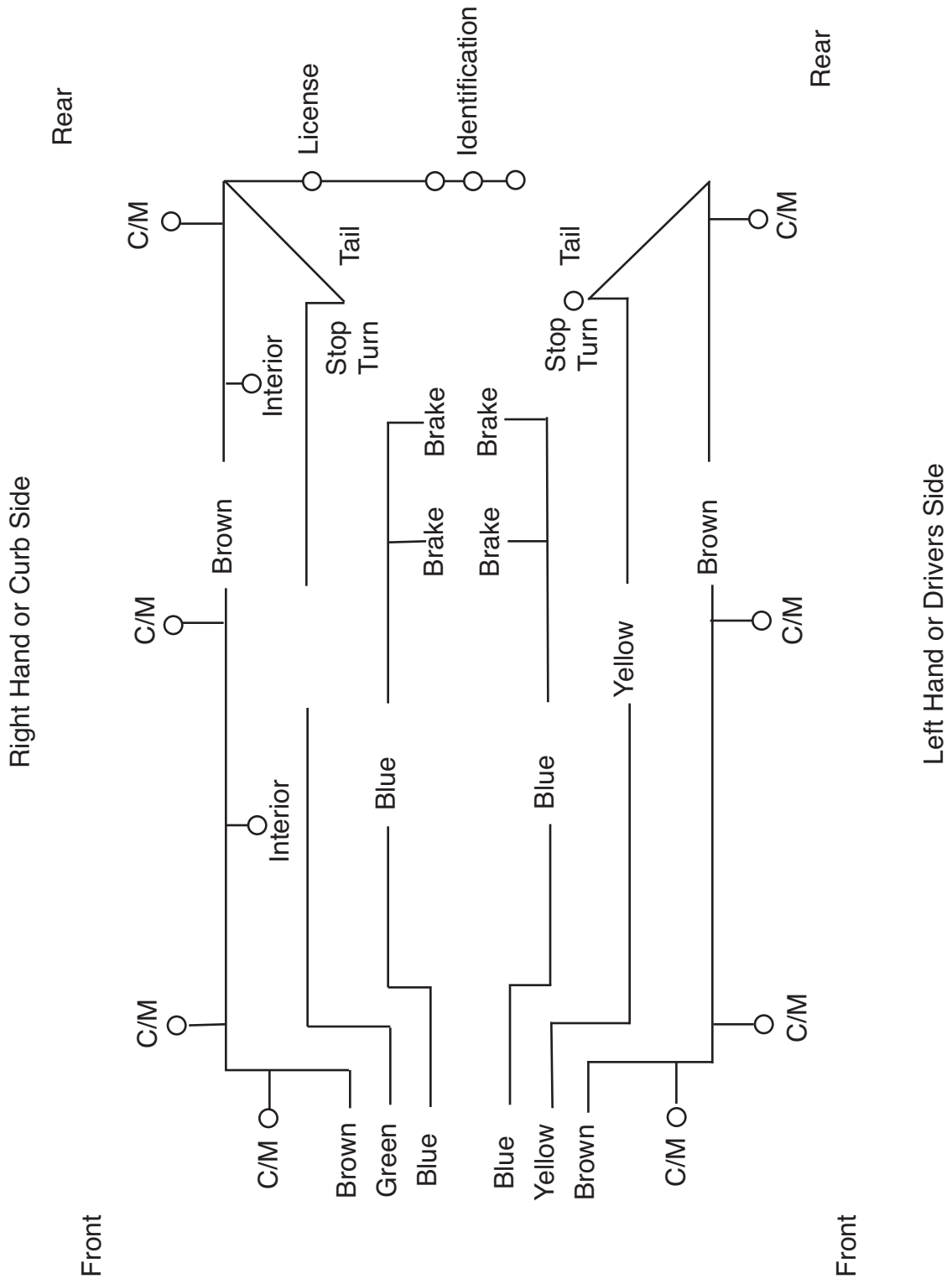

The trailer brake is basically the same as your automobile brake. The major difference is the automobile uses hydraulic pressure to expand the brake shoes while your trailer uses an electric circuit.

When the electrical circuit is complete, high capacity electromagnets are energized and attracted to the armature surface on the brake drum. Due to the rotation of the drum, the electromagnets move the magnet lever arm in the same direction. This movement causes the actuation block to push the primary brake shoe against the drum. The force of the primary shoe in turn pushes the secondary brake shoe in contact with the drum.

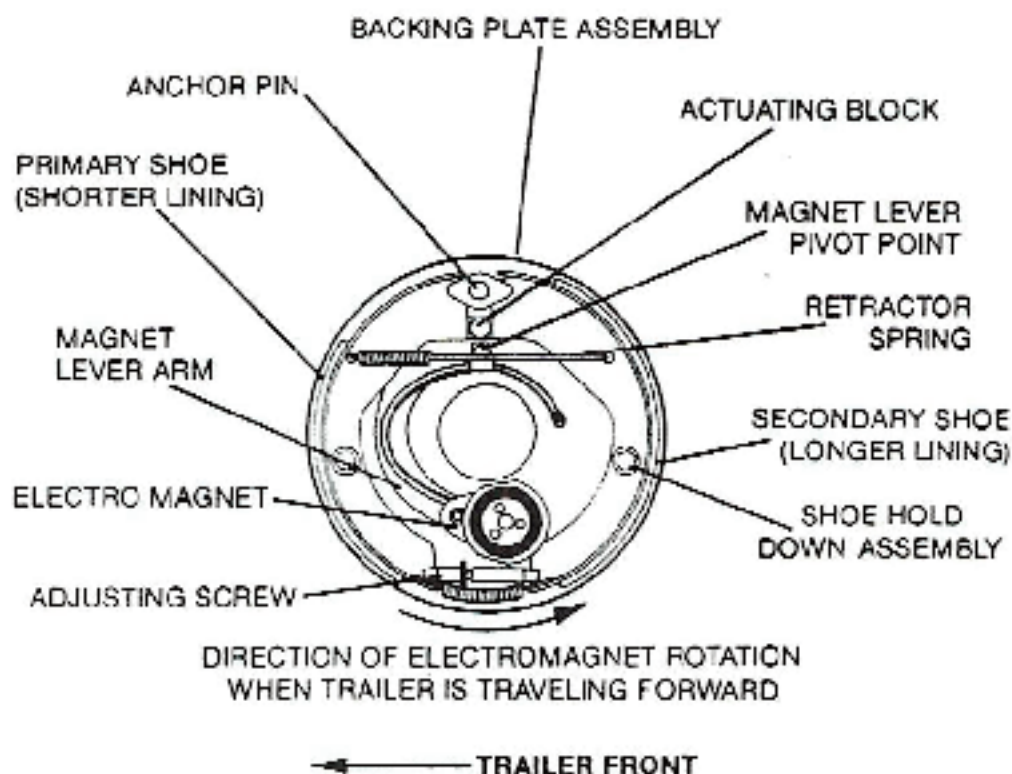

AL-KO ELECTRIC BRAKES 7000 LB. GROUP

Service Replacement Parts 12" x 2" Electric Brake

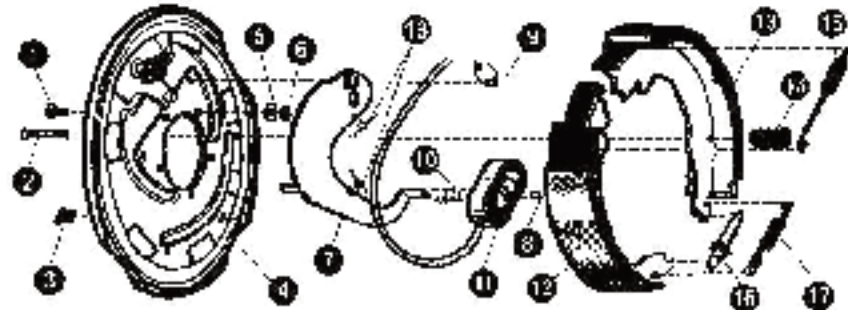

| No. | Brake Part Description | AL-KO Part # | Hayes Part # |
|------------|------------------------------------|---------------------|---------------------|
| 0 | RH Brake Assembly Complete | 303233.1 | 00208712 |
| 0 | LH Brake Assembly Complete (Shown) | 303233.2 | 00208713 |
| 1 | Brake Mounting Stud, 3/8" -24 | 303989 | 090701 |
| 2 | Shoe Hold Down Pin | 508094 | 09001100 |
| 3 | Plug Adjuster Slot | 508089 | 090932 |
| 4 | Backing Plate Assembly | --- | --- |
| 5 | Brake Lock Washer 3/8" | 303334 | 090532 |
| 6 | Brake Mounting Nut 3/8" -24 | 303333 | 090025 |
| 7 | RH Lever Assembly | 508113 | 00283200 |
| 7 | LH Lever Assembly (Shown) | 508114 | 30283100 |
| 8 | Clip, Wire & Magnet | 508092 | 09080815 |
| 9 | Strain Relief, Wire | 508090 | 092715 |
| 10 | Magnet Spring | 508103 | 090522 |
| 11 | Magnet Assembly (White Wire) | 508111 | W1144 Kit |
| 12 | Primary Shoe & Lining | 508120 | SL120 Kit |
| 13 | Secondary Shoe & Lining | 508127 | SL120 Kit |
| 14 | Shoe Hold Down Spring | 508093 | 10443 |
| 15 | Shoe Retract Spring | 508090 | 090527 |
| 16 | Adjuster Screw Assembly | 508110 | 00272401 |
| 16 | Adjuster Screw Socket | 508080 | 00272801 |
| 17 | Adjuster Screw Spring | 508095 | 090520 |
| 18 | Clip, Wire Retainer | 508183 | --- |

AL-KO HUB / DRUM 7000 LB. GROUP

Service Replacement Parts 12" Hub/Drum Service

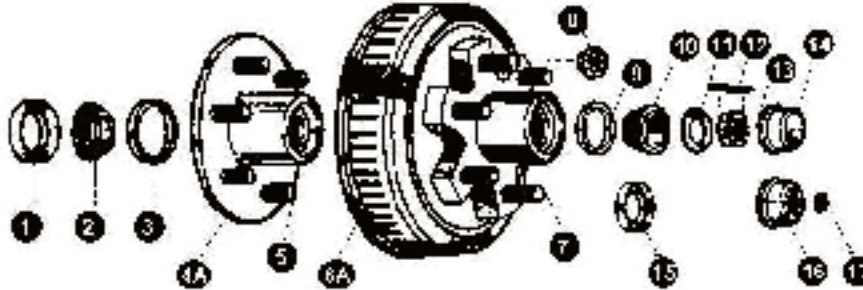

***6 bolt pattern show – 8 bolt is standard application**

| No. | Hub Part Description | AL-KO Part # | Hayes Part # |
|------------|---|---------------------|---------------------|
| 1 | Grease Seal 2 1/4 Shaft | 303198 | 09103304 |
| 1 | Grease Seal 2 1/8 Shaft | 508208 | 09103304D |
| 2 | Inner Bearing Cone 25580 | 303190 | 093703 |
| 3 | Inner Bearing Cone 25520 | 303911 | 093701 |
| 4A | 8 on 0.5" Bolt Circle | 303902 | 09080448 |
| 5 | Stud 1/2" -20 | 303907 | 09251525 |
| 0 | Hub & Drum w/Cups & Studs | --- | --- |
| 0A | 8 on 0.5" Bolt Circle (for 14125A) | 303230 | 09089204 |
| 7 | Stud 1/2" -20 | 303909 | 09251512 |
| 8 | Wheel Nut, 1/2-20 00° Cone | 303203 | 090808 |
| 9 | Outer Bearing Cup (14270) for 8 on 0.5" BC | 303915 | 093719 |
| 10 | Outer Bearing Cup (14125A) for 8 on 0.5" BC | 303397 | 093720 |
| 11 | Spindle Washer 1" x 2" OD | 508320 | 09050901 |
| 12 | Cotter Pin | 303258 | 091901 |
| 13 | Spindle Nut 1" -14 | 303257 | 090801 |
| 14 | Grease Cap for 14125A Bearing | 303419 | 092110 |
| 15 | Grease Seal Dhl Lip Spring 2 1/4 (UL) | 303497 | 09103304 |
| 15 | Grease Seal Dhl Lip Spring 2 1/8 (UL) | 508209 | 09103304L |
| 16 | Grease Cap for 15123 Bearing (UL) | 303490 | 09210102 |
| 16 | Grease Cap for 14125A Bearing (UL) | 303775 | 09210103 |
| 17 | Rubber Plug (UL) | 508007 | 09213011 |

Brakes Trouble Shooting Guide

NO BRAKES

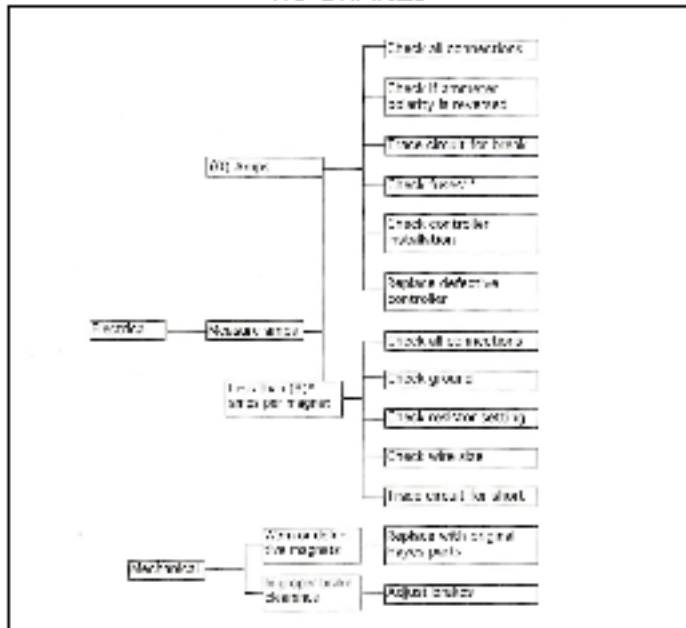

WEAK BRAKES

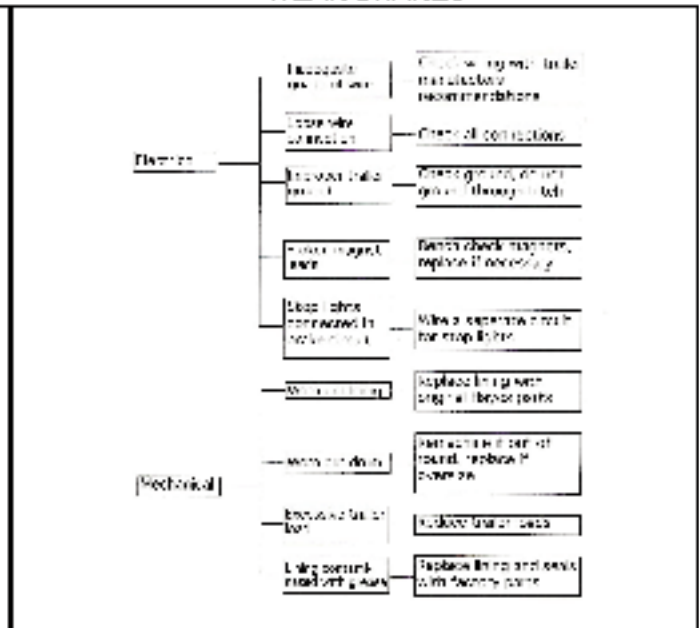

NOTE: If resetting type of fuse is used, an intermittent braking may result if there is a short in the wiring.

Brakes on new trailers may require repeated brake application during the first 25 miles of travel to "hurnish" the lining material. The hurnish process assures a proper match between lining material and drum surface. It also allows the magnet to seat itself to the armature plate. These brake hurnish applications should be made at 1/2 to 1 mile intervals while traveling at 20-30 mph with out overheating the brake system. Overheating occurs when brakes begin to fade. Do not "hurn-in" your brakes by dragging them!

LOCKING BRAKES

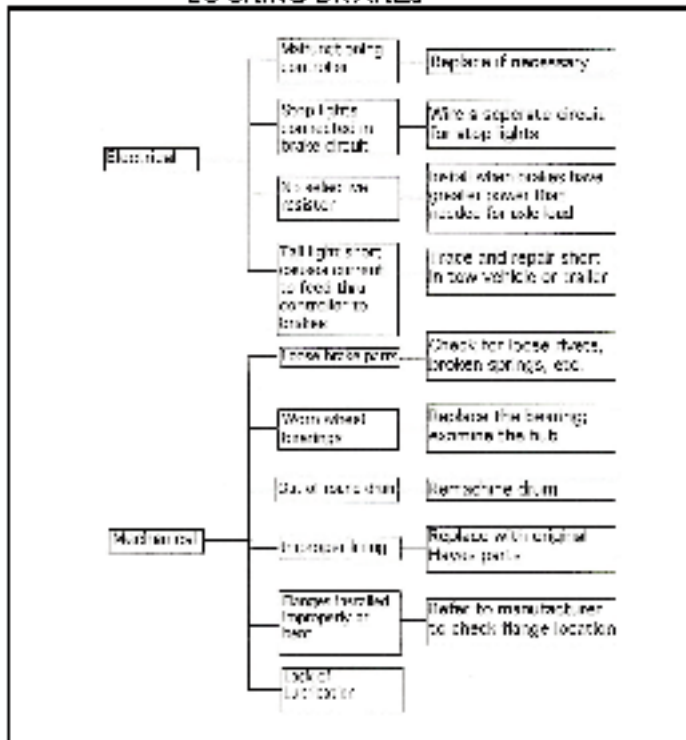

INTERMITTENT OR SURGING BRAKES

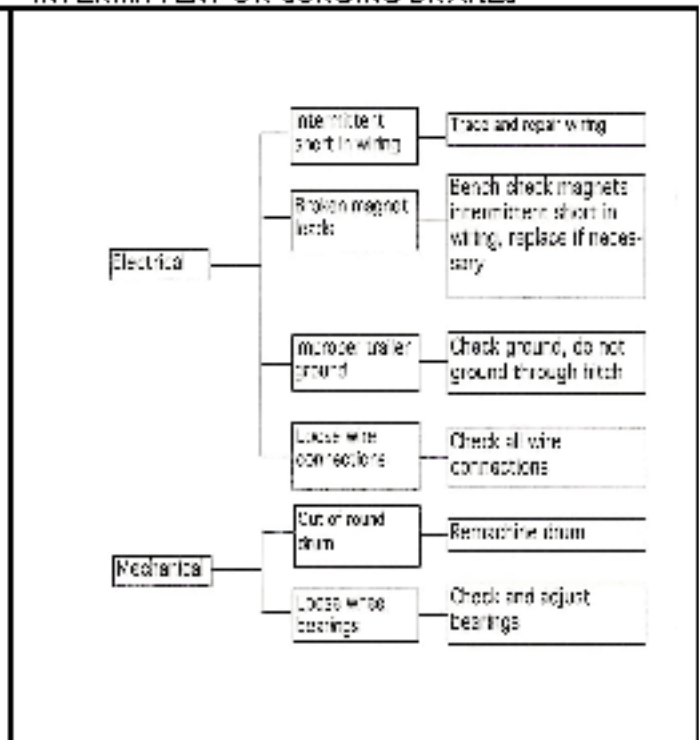

AL-KO AXLE ASSEMBLIES 7000 LB.

STANDARD DROP AXLE

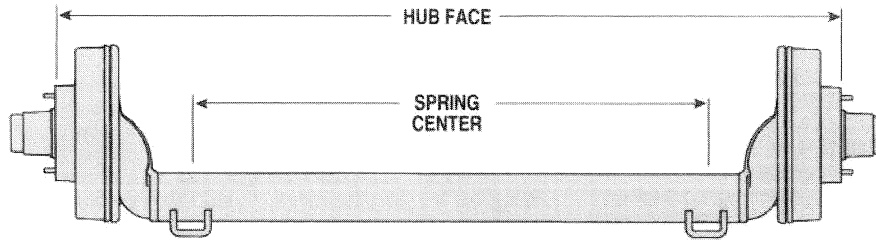

6000 & 7000 Pound Axle Specifications
 Standard with 3" diameter tubing, 1/4" wall thickness and 4" drop.
 * Hub Face dimensions are 94"
 * Spring Center Dimensions are 77 1/2"

7000 LB. Torsion

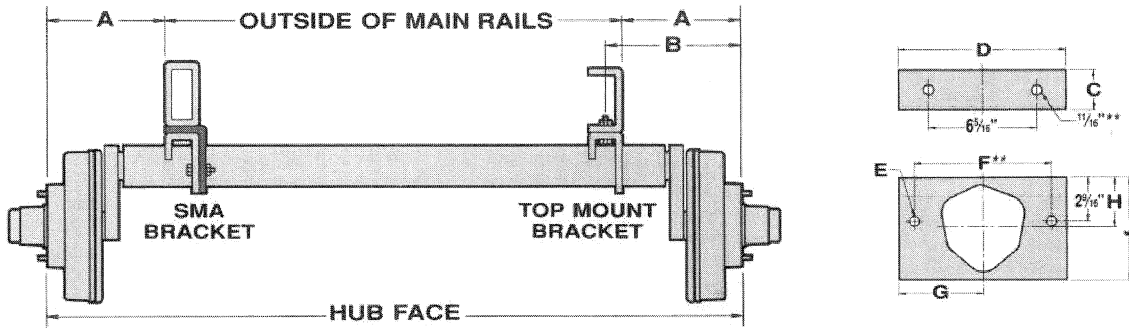

* **Diagram A:** Hub Face dimensions are 94"

* **Diagram B:** Bracket Center to Hub Face Dimensions are 16 1/2"

| | |
|--|--|
| | <h3>Training Arms</h3> <ul style="list-style-type: none"> • All measurements are in inches and are calculated from the bottom of the frame. • A minus sign indicates that the spindle is above the top of the frame. • Allow an additional 3" above the full load dimensions for fender clearance. • Add .25" to start angle dimensions for side mounting. • Add .5" to start angle dimensions for high profile top mounting. • Add .75" to start angle dimensions for high profile side mounting. |
|--|--|

AL-KO SLIPPER SPRING ASSEMBLY

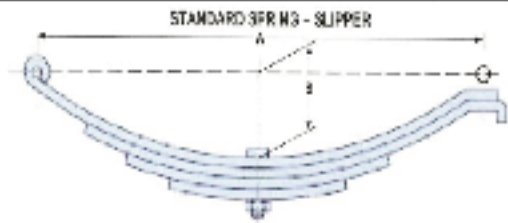
| | |
|--|---|
| <p>Pound Capacity 4000 lb. Number of Leaves 7 Free Length 'A' 25 7/8" Width 2" Free Arch 'B' 2.83"</p> |  <p>*Standard number of leaves is 7, diagram above shows 5.</p> |
|--|---|

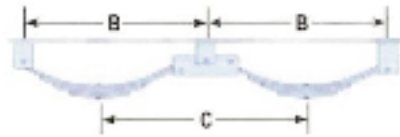

Tandem Slipper Spring Setup

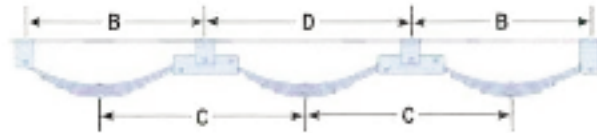

Triple Slipper Spring Setup

| Parts Listing | | |
|--------------------------------|--------------------|-------------------|
| <i>Description</i> | <i>Tandem Qty.</i> | <i>Triple Qty</i> |
| Equalizer Bar | 2 | 4 |
| Front Hanger | 2 | 2 |
| Center Hanger | 2 | 4 |
| Rear Hanger | 2 | 2 |
| Equalizer Bolt 4 1/2" x 7/8" | 2 | 4 |
| Slotted Nut for Equalizer 7/8" | 2 | 4 |
| Spring Eye Bolt 9/16" x 3 1/2" | 4 | 8 |
| Lock Nut 9/16" | 4 | 8 |
| Shackle Bolt 7/16" x 3 1/2" | 4 | 8 |
| Lock Nut 7/16" | 4 | 8 |
| Cotter Pin 1/8" | 2 | 4 |
| Grease Zerk | 2 | 4 |
| Spring Eye Rubber Bushing | 4 | 8 |
| Equalizer Rubber Bushing | 2 | 4 |

GENERAL SPECIFICATIONS

Wheel Nut Torque

| ATTACHMENT | TO | FT. LBS. TORQUE |
|----------------|---------------------|-----------------|
| Flange Nut 3/4 | Dual Wheel to Hub | 375 -425 |
| Flange Nut 5/8 | Dual Wheel to Hub | 275 -325 |
| Cone Nut 5/8 | Single Wheel to Hub | 175 – 225 |
| Cone Nut 9/16 | Single Wheel to Hub | 120 – 140 |
| Cone Nut 1/2 | Single Wheel to Hub | 80 - 95 |

- Tighten wheel bolts or nuts every 50 miles for the first 200 miles and after every change in wheel mounting.

| Description | Size | Torque ft. lbs. | Use |
|----------------------------|-------|-----------------|-------------|
| U-Bolt | 1/2" | 40 – 60 | 4.5K – 7.0K |
| | 1/2" | 40 – 60 | 3.5K |
| | 9/16" | 60 – 80 | |
| | 5/8" | 80 – 90 | 8K |
| Backing Plate Nuts & Bolts | 3/8" | 20 – 40 | 2.5K – 3.5K |
| | 7/16" | 20 – 40 | 2.5K - 3.5K |
| | 1/5" | 85 – 90 | 8K |
| Suspension Nuts & Bolts | 3/8" | Snug fit | |
| | 9/16" | Snug fit | |
| | 7/8" | Snug fit | |
| | 1" | 130 - 150 | |

- Unless otherwise specified. Torque specifications are only applied to fixed clearance applications such as clamped rubber bushings and shoulder bolts. All others are assembled with a snug fit to prevent excessive binding of suspension parts.

LUBRICANT

Grease = High Temperature EP Grease

Oil = SAE 90

ELECTRICAL

Magnet Amperage (at least 12 volts)

4.5K Centerline Brake = 2.25 amps

All others = Approximately 3.0 amps

PARTS LIST

| Electrical | Hitch & Jack | Latches & Hinges | Miscellaneous | Undercarriage |
|-----------------------------|----------------------|-----------------------|-----------------------------|--------------------------------|
| Red LED Clearance Light | 2 5/16" Coupler | Neck Gate Latch | Red / White Reflective Tape | 7k Torsion Axle |
| Amber LED Clearance Light | 2 5/16" Auto Coupler | Neck Gate Hinge | Nylon Glides | 235/80R16 Tire |
| Clear Interior Light | Lock Pin | Side Door Latch | Decals | 7K Spring Axle |
| Red STT LED Light | 3/4" Set Screw | Side Door Hinge | 3/8" Poly Rope | Center Cap |
| Clear Rear Load Light | 5/16" Chain | Tailgate Latch | Pulley | Equalizer 7K |
| License Plate Light | Slip Hook | Tailgate Hinge | | Equalizer Bolt |
| Fender Light LED | Dualpin Jack | Center Gate Slamlatch | | Equalizer Nut |
| Fender Light Base | Jack Handle | Center Gate Hinge | | Equalizer Bushing |
| Grommet –Oval, Small, Large | Cross pipe 42" | | | Rubber Spring Bushing (Lg Eye) |
| Light Switch | | | | Tie Plates |
| Terminal Block | | | | U – Bolt |
| 6-way Female Plug | | | | U – Bolt Nut |
| 7- way RV Plug | | | | Lug Nut |
| 6 Wire Cable | | | | 7 Leaf Slipper |
| Aluminum Light Covers | | | | Front Hanger |
| Breakaway Kit | | | | Center Hanger |
| | | | | Rear Hanger |

- **Parts for trailers built before the year 2004 are available, but not listed. Contact Duralite Trailers for assistance.**

CERTIFICATE OF WARRANTY

The following warranty shall govern as to each new Duralite trailer sold during the period of time and upon the conditions set out in the Extended Warranty Schedule.

To the original owner: Parts which upon examination by Duralite Trailers, LLC are determined to have been defective in material and or workmanship under normal use, maintenance and service, shall be repaired or replaced by Duralite Trailers, LLC at its factory in accordance with the Extended Warranty Schedule as it appears on the next page. Said parts claimed to be defective in material and or workmanship must be brought to the attention of Duralite Trailers, LLC by written notification within 10 days of discovery and any repairs or replacements must be commenced within 30 days thereafter.

Transportation of the trailer to and from the factory shall be the responsibility of the owner. Except for the above warranty, it is agreed and understood that no other warranty, expressed, implied or statutory is made by Duralite Trailers, LLC and that we do not make an implied warranty of merchantability or fitness. The foregoing shall be the owners sole and exclusive remedy whether in contract, tort or otherwise and Duralite Trailers, LLC shall not be liable for damages to property or injury to persons. In no event shall it be liable for incidental or consequential damages or commercial losses. Duralite Trailers, LLC does not make any warranties, representations or promises, expressed or implied, as to the quality or performance of its product other than those set forth above. This warranty does not apply to and no warranty is made by Duralite Trailers, LLC except as to its title, regarding any purchased components, attachments and accessories manufactured, supplied and or furnished by others such as but not limited to: tires, wheels, suspensions, axles, bearings, brakes, hangers, jacks, lights, and wire or any non standard features or items specified by the buyer. Nor does this warranty expand, enlarge upon, or alter in any way, the warranties provided by the makers and supplies of such component parts and accessories.

This warranty shall not apply with respect to any claimed defect, which in the judgment of Duralite Trailers, LLC has risen from repairs or alterations no authorized or performed by Duralite Trailers, LLC from owner misuse, negligence or accident, from owner operation at a speed exceeding state laws and or road conditions, or from loading beyond the trailer's rated load capacity and or legal weight limits. All repairs and replacements are made and furnished subject to the same terms, conditions, warranty, disclaimer of warranty and limit of liability and remedy as apply to each new trailer sold.

ENVIRONMENTALLY CONSUMABLE GOODS

There is no warranty on light fixtures, light bulbs, lens covers, wire, decals, paint on steel parts, reflector tape, hub caps, tie loops, pulleys, vents, rope, rubber or composite door stops.

EXTENDED WARRANTY SCHEDULE

Per written warranty conditions covering defect in material and workmanship as to construction and assembly and installation only.

| SEVEN YEARS | ONE YEAR | VENDOR WARRANTY APPLIES |
|--------------------|--------------------|--------------------------------|
| Side Walls | Gates | Axles |
| Front Walls | Gate Latches | Suspensions |
| Neck Frame | Gate Hinges | Brake Assemblies |
| Rear Frame | Doors | Hub Assemblies |
| Cross members | Door Latches | Wheels |
| Aluminum Floor | Door Hinges | Tires |
| Roof Bows | Tire Carriers | Drop Leg Jacks |
| Roof Sheet | Rollup Gates | Breakaway Kits |
| | Rollup Tracks | |
| | Aluminum Nose | |
| | Hitch Assembly | |
| | Rubber Bumper | |
| | Hanger Brackets | |
| | Auto Hitch Coupler | |
| | Vents | |

WHERE TO GET ASSISTANCE

Should you need assistance concerning your trailer, you may contact:

Duralite Trailers, LLC
41632 109th Street
Britton, SD 57430
1-800-437-89317

REPORTING SAFETY DEFECTS

If you believe that your vehicle has a defect which could cause a crash or could cause injury or death, you should immediately inform the National Highway Safety Administration (NHTSA), in addition to notifying Duralite Trailers, LLC.

If NHTSA receives similar complaints, it may open an investigation, and if it finds a safety defect exists in a group of vehicles, it may order a recall and remedy campaign. However, NHTSA cannot become involved in individual problems between you and Duralite Manufacturing, LLC.

To contact NHTSA, you may either call the Auto Safety Hotline toll free at 1-800-424-9393 or 336-0123 in the Washington DC area or write to: NHTSA, U.S. Dept. of Transportation, Washington, D.C. 20590. You can also obtain information about motor vehicle safety from the hotline.