

CLICK ANYWHERE on THIS PAGE to RETURN to CONDENSATE PUMPS at InspectApedia.com

961736

www.rectorseal.com

Rectorseal® 2601 Spenwick Drive, Houston, TX 77055 (800) 231-3345

LIMITED WARRANTY. Rectorseal® warrants to the original consumer purchaser ("Purchaser") of its product, EZ Trap®, that it is free from defects in material or workmanship. It within two years (24 months) from the date of the original consumer purchase this product shall prove to be defective, it shall be repaired or replaced at Rectorseal's option. Your original receipt of purchase is required to determine warranty eligibility. This warranty does not cover replacement labor or any cost, claim or incident to any defect nor does it cover freezing or any other consequential damages. The sole liability of the manufacturer under this warranty is limited to the replacement of defective product. Product damaged by improper use, accident, neglect, alteration, abuse or improper installation is excluded from this warranty.



Eliminates standing water and freezing problems. Sized for use in ductless mini-split applications. Use on any mini-split evaporator with gravity drain. Permits free condensate flow while blocking odors, noise and insects.

Application



EZT180
Product Code 83180



U.S. Patent Numbers 5,069,042 5,522,229

EZ TRAP®

EZT180
Product Code 83180

Scan for more info



Mini Waterless In-Line Condensate Trap

Kit Contents

- Mini Trap (1)
- Rubber Adapter (1)
- Cleaning Label (1)

EZT180

TRAP MUST BE INSTALLED VERTICALLY – WIDE END UP AND NARROW END DOWN. FOR CONDENSATE TO FLOW. INCORRECT INSTALLATION WILL CAUSE BACK-UP OF CONDENSATE.

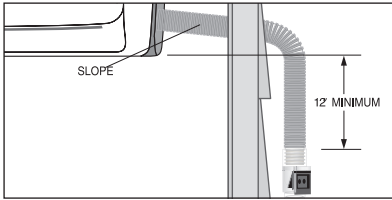

To ensure proper condensate drainage:

- The drain hose must exit the mini-split with a slope
- Trap must be installed a minimum of 12" below the unit
- Trap must be installed vertically (wide end up)
- Where possible, install Trap within 6 ft. of ground to facilitate inspection and cleaning.

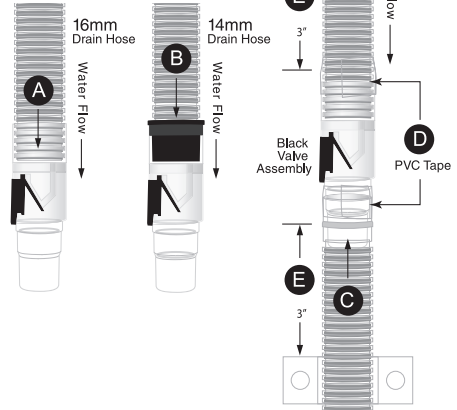

INSTALLATION INSTRUCTION:

1. Insert the end of inlet drain hose into the top of the Trap (Wide End) and seat firmly.
Note: Trap fits 5/8" (16mm) inlet drain hose snugly. (A) Use Rubber Adapter (provided) when using 9/16" (14mm) inlet drain hose only. (B)
2. Insert end of outlet drain hose into the bottom of Trap (Narrow End) and seat firmly. (C)
3. Wrap inlet and outlet connection with PVC Tape. (D) DO NOT GLUE THE TRAP
4. Fit Hose/Trap assembly to wall with 2 pipe brackets 3" from Trap. NOTE: Ensure that Black Valve Assembly is perpendicular to or facing away from wall to facilitate cleaning. (E)

Maintenance:

- Clean Trap annually or more often if required.
- Ensure that bleed holes of the Trap are not blocked.
- Remove Trap before cleaning cooling coil with chemical cleaner.

Important:

- Install in accordance with RectorSeal instructions as well as all applicable local plumbing and drainage codes.
- Use EZT180 with mini-split air conditioner applications only.
- EZT180 is designed for use with non-kinking corrugated PE Drain Hose (DH-16). Thin wall vinyl hose kinks easily and should not be used for this application.
- Trap is not required if condensate pump is fitted.

