

4 ft. Euro Install

Note: Clamps and Hardware are inside posts. Remove parts from the bottom of post.

Required Tools for Euro System Install

Hammer, tape measure, chalk or marker, shovel, post hole digger, wheel barrow, adjustable wrench, M8 hex key, hack saw, rotary cutting tool or bolt cutting tool, electric drill, 1/16 in., 5/16 in. & 3/8 in. drill bits. Masonry drill bits, anchors and additional hardware may be needed to install flange post.

1. Install Posts

Use in-ground post when installing in ground with concrete.
Use flange post when surface mounting on concrete or wood.

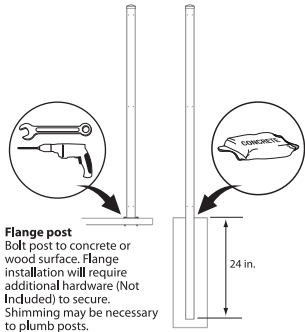

In-ground post

Dig holes for post approximately 8 in. in diameter and 24 in. to 30 in. deep. The depth will be determined by local codes / weather zones. Mark the ground line on posts with a marker or chalk. Installed post height should be 49-1/2 in. Post must be plumb. Fill in hole with a continuous pour of concrete. Trowel the top so it slopes away from the post for water to run off.

Flange post

Bolt post to concrete or wood surface. Flange installation will require additional hardware (Not Included) to secure. Shiming may be necessary to plumb posts.

2. Measure Gate Opening

Posts for the gate opening must be set 48 in. apart measured from center of post to center of post or 46 in. from inside edge to edge. Posts must be plumb. Let the posts cure before you install panels.

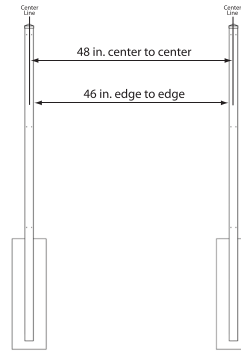

3. Post Offset

Set the remaining posts at 72 in. on center or 70 in. inside edge to inside edge. Shorter spans must be in 1-7/8 in. intervals. See Step 7 for panel cutting. Washers are used when panel is mounted to one side only.

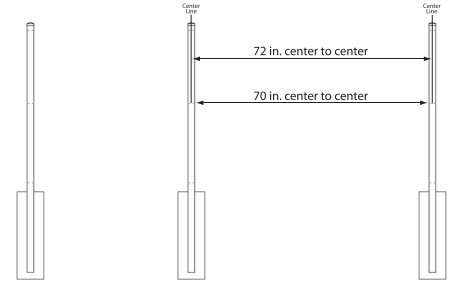

4. Install First Panel

Mount Panel to post with clamps, nuts and bolts.
NOTE: Place the extending tab on the clip in the down position for install. It is only used in the up position on a 90° corner.

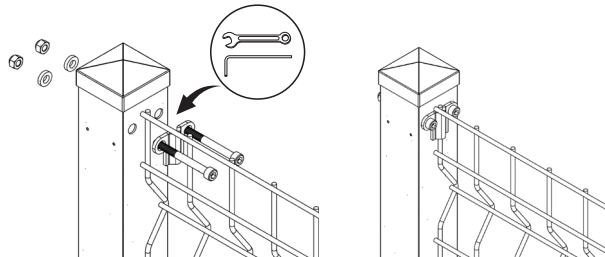

6. Corner Installation

Mount panel to corner post. Holes must be drilled in the post to mount a panel at a 90° angle corner. Dimples mark the spot to drill.

NOTE: Flip the clip with the tab up on the side of the post that has been drilled. This will keep the fence panels in line and level.

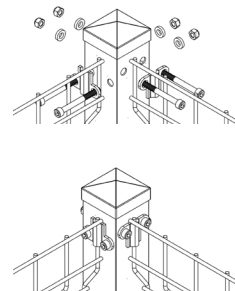
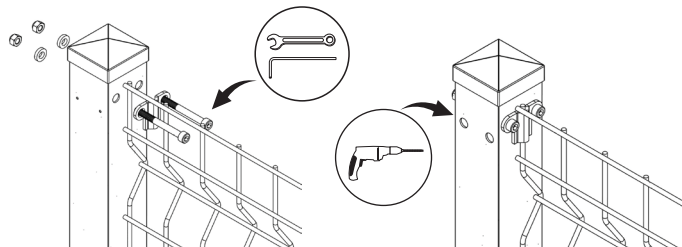

5. Continue Installing Panels

Mount 2 panels - Bolt through clamps on both sides of the post.

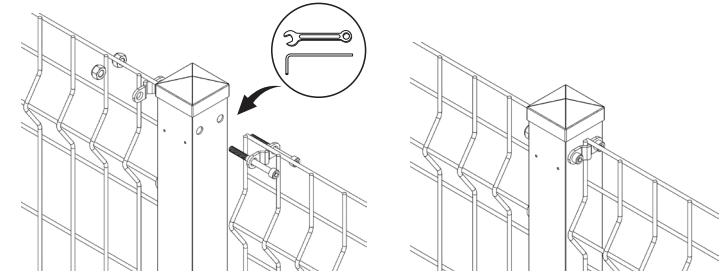

7. Cut Panel

If you are going to install a span less than 6 ft. The panel must be cut in 1-7/8 in. increments ending with a vertical wire. Panel can be cut with a rotary cutting tool, hack saw or bolt cutting tool.
Caution: Use safety eye protection.
Caution: Cut edge may be sharp

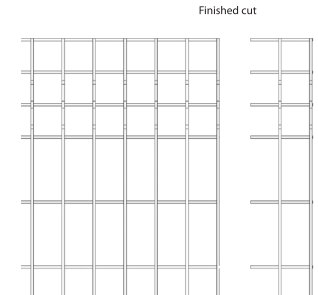

8. Installing Acute Angle Corners

If you want to install a corner that is less than a 90° corner you must measure the post placement from the face or the corner post, 70 in. between inside of posts. You will have to mount the panel in the same fashion as shown in Step 6. Post must be drilled for this installation.

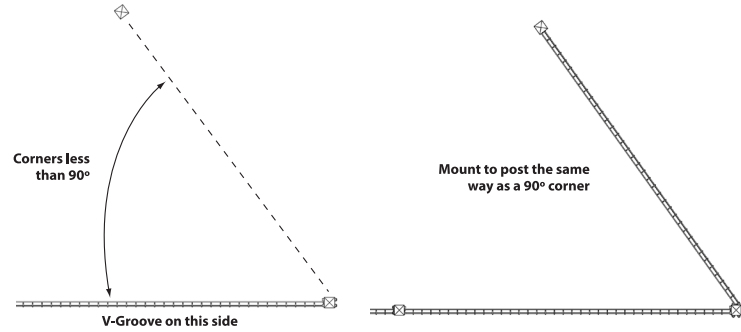

9. Installing Obtuse Angle Corners

If you want to install a corner that is greater than a 90° corner you must measure the post placement from the side or the corner post, 70 in. between inside of posts. You will have to mount the panel in the same fashion as if you were mounting panel in a straight line, not like a corner install. Note: Installation with multiple non 90° angles may require panel orientation to be reversed.

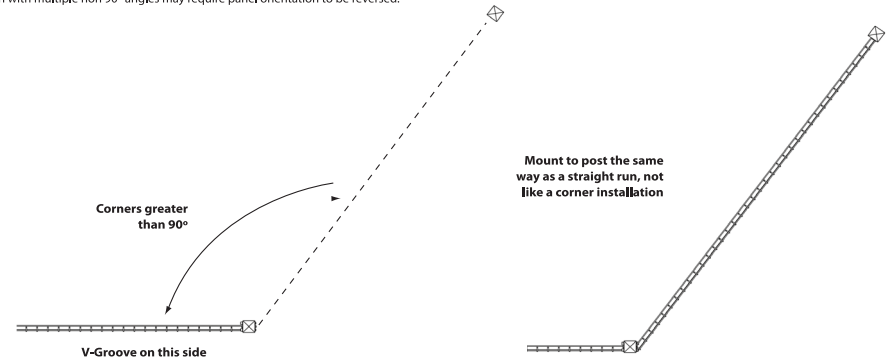

10. Gate Install

Start the gate installation by mounting post side of hinge system. Mark the holes by holding the top hinge 8.75 in. from cap and bottom hinge 38.25 in. from to cap. Be sure to measure from the bottom of cap to the bottom of the hinge. Drill 5/16 in. holes in post. Next mount gate side of hinge into existing holes in gate. Mount the bottom post hinge on the post with nuts and bolts. Get the parts together to mount the top hinge. Install gate by hooking the bottom gate side hinge into the bottom post hinge. Next hook the top post hinge onto the top gate side hinge, then while hinge is together bolt assembly together.

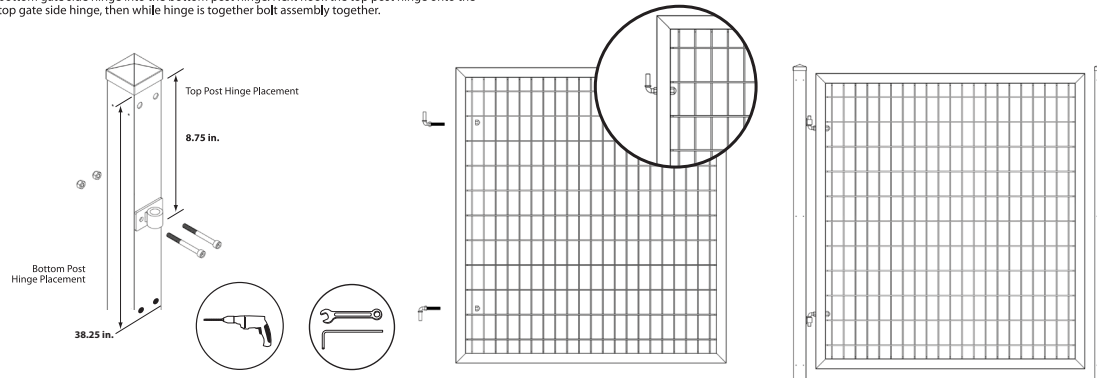

11. Latch Install

Pre-drill 1/16 in. pilot holes on gate and mount striker to gate at desired height with included self-tapping screws. Next line up latch on post, drill and mount with self-tapping screws.

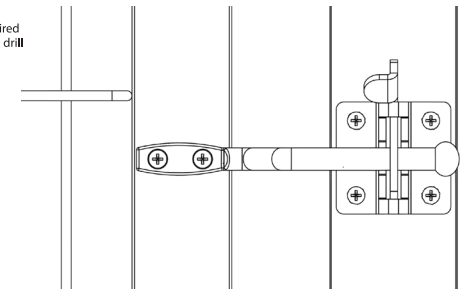

12. Stepped Installation/Grade

This fence is designed for use on flat ground. To deal with a slight grade, a stepped installation is recommended. This is achieved by setting the posts at a taller installed height. It is not recommended to exceed +5in. Installed post maximum height 54-1/2 in. Note: Flange posts can not be used for grade installations.

