

'23 RIFT ZONE E

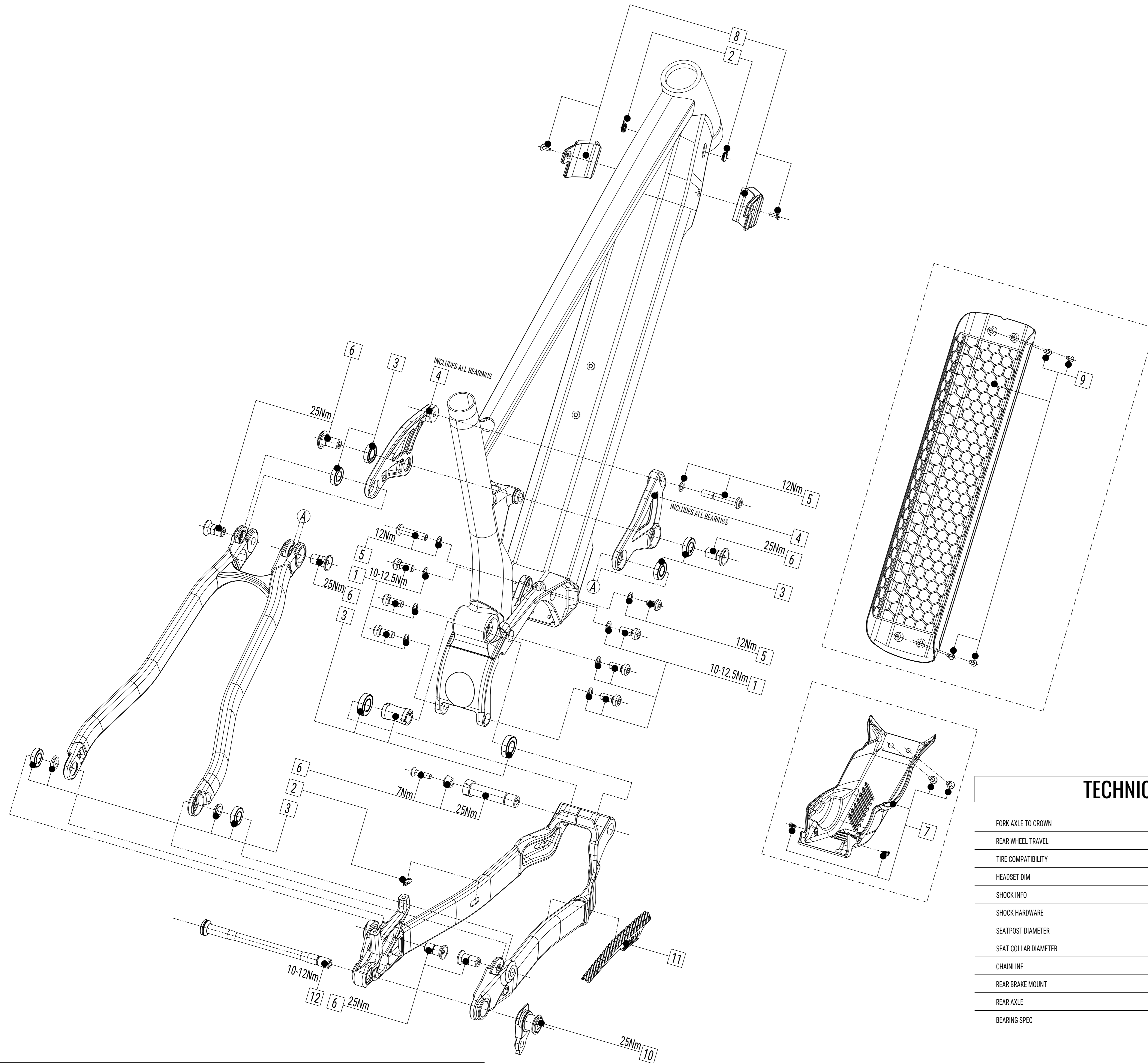

SERVICE PARTS

NO.	ARTICLE CODE	DESCRIPTION	NOTES
1	734743	MOTOR BOLT KIT	ALL SIX MOTOR BOLTS
2	730802	RUBBER GROMMET KIT ONE PIECE	INCLUDES ALL RUBBER GROMMETS NEEDED + EXTRA
3	730798	BEARING KIT E, QTY 8	INCLUDES ALL BEARINGS AND BEARING SPACERS
4	726907	ROCKER LINKAGE, MULTITRAC #1	ROCKER LINK W BEARINGS AND WASHERS
5	726917	SHOCK BOLT KIT C	UPPER AND LOWER SHOCK BOLTS
6	730799	PIVOT BOLT KIT F	ALL PIVOT BOLTS
7	736030	STEPS V2 MOTOR COVER	INCLUDES ATTACHMENT BOLTS
8	732778	BUMP STOP	INCLUDES ATTACHMENT BOLTS
9	732777	Alpine Trail E2 Battery Cover	INCLUDES ATTACHMENT BOLTS
10	NA	SRAM UDH	AC-DRHG-MTB-A1
11	732773	CS PROTECTOR SERIES 4 ALLOY	JUST CS PROTECTOR
12	736031	BOLT ON AXLE 148X12 MM, TAPERED HEAD, 1.0P	JUST REAR AXLE
13	732779	BATTERY RELEASE RUBBER HOLE COVER	RUBBER PLUG ONLY, JAGWIRE PART #CCN123NB
14	732781	CABLE CLAMPS 4MM/2.5MM	CC1012A1B-J
15	732782	CABLE CLAMPS 5MM/2.5MM	CC999BJ

TECHNICAL DATA

FORK AXLE TO CROWN	OE SPEC: 551MM	MAX: 561MM
REAR WHEEL TRAVEL	E2E: 140MM	
TIRE COMPATIBILITY	FRONT: 29X2.6"	REAR: 29X2.6"
HEADSET DIM	TOP: ZS44	BOTTOM: ZS56
SHOCK INFO	E2E: 210M	STROKE: 55MM
SHOCK HARDWARE	UPPER: 25XMM	LOWER: 25XMM
SEATPOST DIAMETER	30.9MM	
SEAT COLLAR DIAMETER	34.9MM	
CHAINLINE	52-55MM	
REAR BRAKE MOUNT	POST MOUNT 180MM	
REAR AXLE	148X12MM	
BEARING SPEC	69012RS: 12X24X6	QTY: 6
	69022RS: 15X28X7	QTY: 2

SHIMANO E-SPECIFIC PARTS

SPEED SENSOR	EWS-S301
DRIVE UNIT	SHIMANO EP601, EP8
BATTERY COMPATIBILITY	BT-EN805L, BT-EN806
BATTERY MOUNT	BM-EN801-A
CHARGE PORT	EW-CP100
WIRES	EW-SD3001
ASSIST MODE SWITCH	SW-EN600-L
DISPLAY	SC-EN600

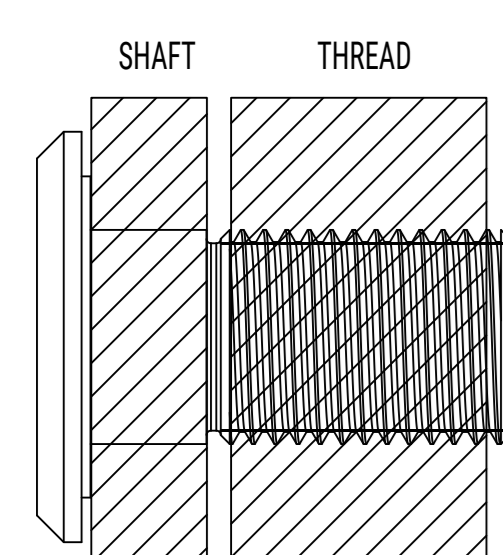

CAUTION

FOR ALL BOLTS SHOWN ON BIKES RECOMMENDED TO APPLY GREASE AND THREAD LOCKER

THE APPLICATION AREA SHOWN AS LEFT
 THREAD LOCKER ON THREAD AREA ONLY
 GREASE ON SHAFT AREA ONLY
 FOR THOSE BOLTS WITHOUT SHAFT, THREAD LOCKER NEEDED ONLY.

REAR DEPTH

S: 201mm M: 211mm L: 236mm XL: 246mm

MARIN

BIKES CALIFORNIA