

**United States Department of the Interior
Heritage Conservation and Recreation Service**

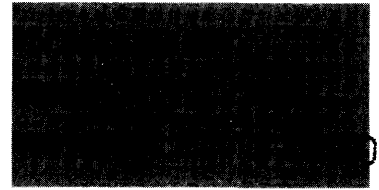

**National Register of Historic Places
Inventory—Nomination Form**

See instructions in *How to Complete National Register Forms*
Type all entries—complete applicable sections

1. Name

historic Greenlawn

and/or common Same

2. Location

street & number 200 East Chestnut Street _____ not for publication

city, town Amite _____ vicinity of congressional district 6th - Henson Moore

state Louisiana code 022 county Tangipahoa code 105

3. Classification

Category	Ownership	Status	Present Use	
<input type="checkbox"/> district	<input type="checkbox"/> public	<input checked="" type="checkbox"/> occupied	<input type="checkbox"/> agriculture	<input type="checkbox"/> museum
<input checked="" type="checkbox"/> building(s)	<input checked="" type="checkbox"/> private	<input type="checkbox"/> unoccupied	<input type="checkbox"/> commercial	<input type="checkbox"/> park
<input type="checkbox"/> structure	<input type="checkbox"/> both	<input type="checkbox"/> work in progress	<input type="checkbox"/> educational	<input type="checkbox"/> private residence
<input type="checkbox"/> site	Public Acquisition	Accessible	<input type="checkbox"/> entertainment	<input type="checkbox"/> religious
<input type="checkbox"/> object	<input type="checkbox"/> in process	<input checked="" type="checkbox"/> yes: restricted	<input type="checkbox"/> government	<input type="checkbox"/> scientific
	<input type="checkbox"/> being considered	<input type="checkbox"/> yes: unrestricted	<input type="checkbox"/> industrial	<input type="checkbox"/> transportation
		<input type="checkbox"/> no	<input type="checkbox"/> military	<input checked="" type="checkbox"/> other: Apartments

4. Owner of Property

name Mr. and Mrs. Joseph H. Simpson

street & number P. O. Box 425

city, town Amite _____ vicinity of state Louisiana 70422

5. Location of Legal Description

courthouse, registry of deeds, etc. Tangipahoa Parish Courthouse

street & number

city, town Amite _____ state Louisiana

6. Representation in Existing Surveys

title La. Historic Sites Survey has this property been determined eligible? _____ yes no

date 1979 _____ federal state _____ county _____ local

depository for survey records State Historic Preservation Office

city, town Baton Rouge _____ state Louisiana

7. Description

Condition

excellent
 good
 fair

deteriorated
 ruins
 unexposed

Check one

unaltered
 altered

Check one

original site
 moved date _____

Describe the present and original (if known) physical appearance

Greenlawn House is set on a corner lot in the old residential section of Amite, one block south of the main commercial street.

The two and one-half story frame house has a one-story rear wing and full galleries in front. Although the house has a central hall plan and many decorative features of the Victorian Renaissance Revival, there are also touches of the Queen Anne. Renaissance Revival features include:

1. The basic five-bay articulation of the house and the Classical style galleries with their elaborate cut-out woodwork.
2. The aedicule motifs surrounding the doors and windows. (The front doorway is particularly noteworthy in this regard with its cornice which rests on consoles.)
3. The interior staircase with its heavy turned newel post.

The design also includes touches of the Queen Anne:

1. Large areas of patterned shingles.
2. A tall central roof gable.
3. Three semi-octagonal bays.

The interiors are large and plain with scrollsaw ornamented mantels. The staircase has been moved.

8. Significance

Period	Areas of Significance—Check and justify below			
<input type="checkbox"/> prehistoric	<input type="checkbox"/> archeology-prehistoric	<input type="checkbox"/> community planning	<input type="checkbox"/> landscape architecture	<input type="checkbox"/> religion
<input type="checkbox"/> 1400–1499	<input type="checkbox"/> archeology-historic	<input type="checkbox"/> conservation	<input type="checkbox"/> law	<input type="checkbox"/> science
<input type="checkbox"/> 1500–1599	<input type="checkbox"/> agriculture	<input type="checkbox"/> economics	<input type="checkbox"/> literature	<input type="checkbox"/> sculpture
<input type="checkbox"/> 1600–1699	<input checked="" type="checkbox"/> architecture	<input type="checkbox"/> education	<input type="checkbox"/> military	<input type="checkbox"/> social/
<input type="checkbox"/> 1700–1799	<input type="checkbox"/> art	<input type="checkbox"/> engineering	<input type="checkbox"/> music	<input type="checkbox"/> humanitarian
<input checked="" type="checkbox"/> 1800–1899	<input type="checkbox"/> commerce	<input type="checkbox"/> exploration/settlement	<input type="checkbox"/> philosophy	<input type="checkbox"/> theater
<input type="checkbox"/> 1900–	<input type="checkbox"/> communications	<input type="checkbox"/> industry	<input type="checkbox"/> politics/government	<input type="checkbox"/> transportation
		<input type="checkbox"/> invention		<input type="checkbox"/> other (specify)

Specific dates	1890's	Builder/Architect	Bolivar Edwards, Builder
-----------------------	--------	--------------------------	--------------------------

Statement of Significance (in one paragraph)

Criterion C

Greenlawn is a landmark residence in Amite because it has the town's only two-story galleried front complete with molded capital pillars and full entablatures. It also spreads to an impressive five bays and is further extended by side porches. This locally formed and pretentious statement can be compared with other large residences in Amite which have plain boxy exteriors or one-story galleries with turned columns. Moreover, Greenlawn is richly ornamented with scrollsaw decorations to a degree seldom seen in the area.

According to local tradition, the house was built in the 1890's by Bolivar Edwards, a prominent Amite lawyer. Edwards was district attorney of the Sixth Judicial District during Reconstruction and was a representative in the Louisiana legislature from 1874 to 1876. In 1888 he was elected to the office of district attorney of the Eighteenth Judicial District. The house remained in the Edwards family until 1972, when the current owners purchased it from Olive Stevens. (Tangipahoa Parish Records, Conveyance Book 370, p. 535.)

9. Major Bibliographical References

Tangipahoa Parish Conveyance Records.
 Letters from Mrs. Leah Beth Simpson to State Historic Preservation Office,
 7 June and 2 August, 1979, located in National Register file on Greenlawn.
Biographical and Historical Memoirs of Louisiana, Vol, I, Chicago: The Goodspeed
 Publishing Company, 1892.

10. Geographical Data

UTM NOT VERIFIED

Acreeage of nominated property approx. 1/4 acre

ACREAGE NOT VERIFIED

Quadrangle name _____

Quadrangle scale _____

UMT References

A

1	5
---	---

7	3	8	7	7	5
---	---	---	---	---	---

3	4	0	1	5	5	0
---	---	---	---	---	---	---

 Zone Easting Northing

B

--	--

--	--	--	--

--	--	--	--	--	--

 Zone Easting Northing

C

--	--

--	--	--	--

--	--	--	--	--	--

D

--	--

--	--	--	--

--	--	--	--	--	--

E

--	--

--	--	--	--

--	--	--	--	--	--

F

--	--

--	--	--	--

--	--	--	--	--	--

G

--	--

--	--	--	--

--	--	--	--	--	--

H

--	--

--	--	--	--

--	--	--	--	--	--

Verbal boundary description and justification

Boundaries take in lot on which the house stands. See attached scale drawing.

List all states and counties for properties overlapping state or county boundaries

state	code	county	code
-------	------	--------	------

state	code	county	code
-------	------	--------	------

11. Form Prepared By

name/title Mr. and Mrs. Joseph H. Simpson

organization _____ date Summer 1979

street & number P. O. Box 425 telephone _____

city or town Amite state Louisiana

12. State Historic Preservation Officer Certification

The evaluated significance of this property within the state is:

national state local

As the designated State Historic Preservation Officer for the National Historic Preservation Act of 1966 (Public Law 89-665), I hereby nominate this property for inclusion in the National Register and certify that it has been evaluated according to the criteria and procedures set forth by the Heritage Conservation and Recreation Service.

State Historic Preservation Officer signature *E. Bernard Kamin*

title State Historic Preservation Officer date 3/21/80

For HCRS use only

I hereby certify that this property is included in the National Register

Sally G. Odeh date 5/31/80
 Keeper of the National Register

Attest: *Beth Grosvenor* date 5/27/80

Chief of Registration



E CHESTNUT ST

← 100' →

1 PHOTO
↓

2 PHOTO
↙

32.2'

← 24 1/2' →

16'2"

17'10"

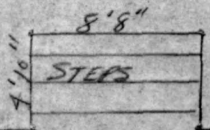

3'10"

6'3 1/2"

16'9"

6'3"

PARCH
15'3"

35'3"

S. LAUREL ST.

20'10"

9'10"

5'8"

7'2"

6'9"

7'8"

7'6"

1'6"

↕ 130' ↕

3 PHOTO
↙

27'2"

20'4"

1'5"

1'8"

6'10"

27'6"



↑
BOUNDARY