

BUSTER+PUNCH
LONDON



24/25 US EDIT

category:

THE LOOKS
CABINET HARDWARE
DOOR HARDWARE
SWITCHES + OUTLETS
LIGHTING
KITCHEN
BATHROOM
ACCESSORIES
FURNITURE
COLLABORATIONS
FINISHES
OUR DESIGNER

pages:

008-015
016-029
030-043
044-053
054-089
090-099
100-109
110-121
122-129
130-135
136-139
140-141



FURNITURE
COLLABORATIONS

KITCHEN
CABINET HARDWARE

LIGHTING
DOOR HARDWARE
BATHROOM

SWITCHES + OUTLETS
ACCESSORIES

THE START OF SOMETHING SPECIAL

A decade ago, we turned our attention from crafting custom motorcycles in an East London garage to using our skills and passion to design solid metal architectural details.

For us, details are everything. They're the foundation for compelling, tactile interiors. Our hardware, switches and lighting collections are designed for you to seamlessly combine elements and create a refined aesthetic. Adding Buster + Punch elevates everything; from the overall look and attitude to function and feel, nothing comes close.

Buster + Punch's pieces are crafted with care to make a positive impression on your world and have minimal impact on the one we share. We create future heirlooms made to perform and be loved for generations.

BUSTERANDPUNCH.COM



BEHIND THE LOOKS

Buster + Punch has three looks: CROSS, LINEAR and CAST. Each look has its own set of influences and aesthetic attributes to help you create the perfect interior styling.



look:

CROSS
CAST
LINEAR

look:

LINEAR
CROSS
CAST



LINEAR

Linear has an elegant, long knurl that runs along its slimmed-down solid metal bar and has a tapered torx screw detail.





CAST

Cast is an architectural design where rough-cast elements meet a smooth, hand-polished solid metal bar. Cast pieces are finished with our solid metal spun screws. The nature of the casting process means each piece is totally unique.



CABINET HARDWARE

CABINET HARDWARE

Precision-engineered solid metal cabinet hardware for kitchens, bathrooms and furniture. Create a seamless foundation of detailing with signature B+P looks and finishes.

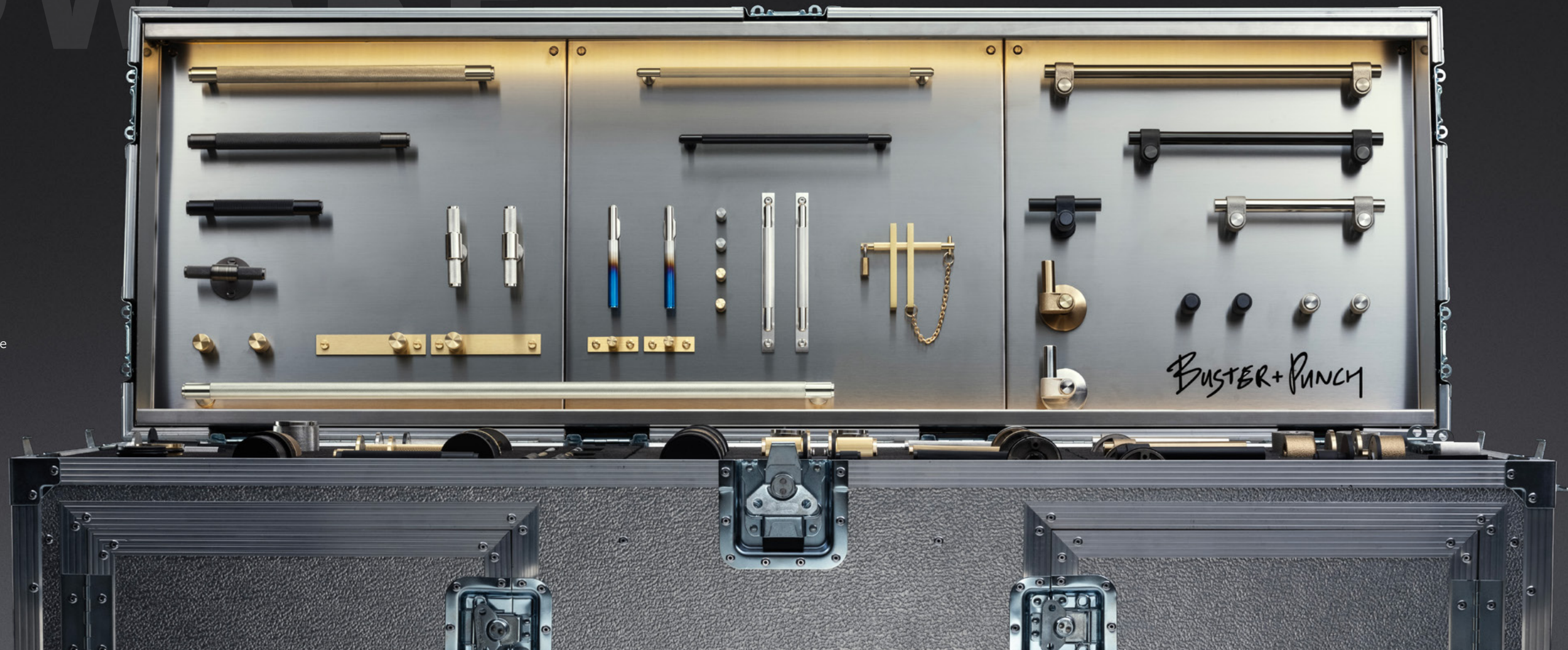

CABINET HARDWARE

LINEAR

Linear cabinet hardware adds a real sense of elegance and refinement to everything it touches. The collection is made from solid metal bar, with torx screw detailing, and a crisp, diamond-cut linear knurling pattern that catches the light. All refined by hand and packaged for a great unboxing experience. The range includes cabinet knobs, L-bars, pull bars and the striking B+P precious bar.



featured:
PULL BAR

finish:
BRASS



featured:
**PULL BAR
2G DIMMER
HOOKED**



featured:
L-BAR



FURNITURE KNOB / LINEAR

finish: steel
brass
black

sku: NFK-36448
NFK-05361
NFK-02363



L-BAR / LINEAR

finish: steel
brass
black

sku: NLB-07370
NLB-05371
NLB-02374



FURNITURE KNOB / PLATE / LINEAR

CC: 1.57"

finish: steel
brass
gun metal*
black

sku: NFK-07365
NFK-05366
NFK-35369
NFK-02368



PRECIOUS BAR

CC: 2.75"

finish: brass

sku: NCC-05426

PULL BAR / LINEAR

	CC: 4.92"	CC: 8.86"	CC: 12.8"
finish:	sku: (small)	sku: (medium)	sku: (large)
steel	NPB-07330	NPB-07335	NPB-07340
brass	NPB-05331	NPB-05336	NPB-05341
black	NPB-02333	NPB-02338	NPB-02343

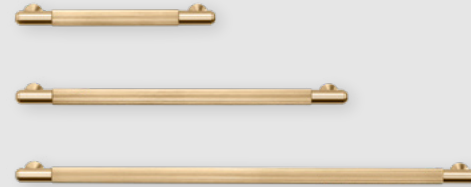

PULL BAR / PLATE / LINEAR

	CC: 4.92"	CC: 8.86"	CC: 12.8"
finish:	sku: (small)	sku: (medium)	sku: (large)
steel	NPB-07345	NPB-07350	NPB-07355
brass	NPB-05346	NPB-05351	NPB-05356
black	NPB-02348	NPB-02353	NPB-02358

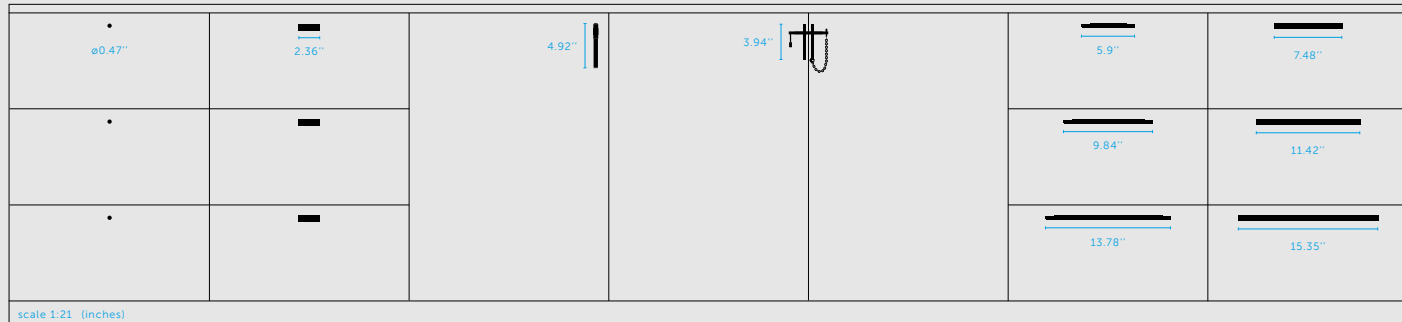

3/16" counter

*Limited production or discontinued product. Please check availability.



knurl:

linear

types:

- cabinet pulls
- cabinet knobs
- cabinet locks

finish:

- steel
- brass
- gun metal
- black

CABINET HARDWARE

CROSS

The original solid metal hardware collection, our iconic Cross look lays the foundation for styling with details at the core of a space. With a refined industrial aesthetic that feels as good as it looks, the diamond-cut cross knurling pattern adds presence and drama in versatile finishes that transform your interiors. Cross hardware includes furniture knobs, pull bars, closet bars, hooks and T-bars.

featured:

**CLOSET BAR
PULL BAR**



featured:

**HOOKED
CLOSET BAR
PULL BAR**



featured:

T-BAR

finish:

SMOKED BRONZE





FURNITURE KNOB / CROSS

finish: steel, brass, smoked bronze, black
sku: US-KN-ST-A, NFK-054091, US-KN-SM-A, US-KN-BL-A



T-BAR / CROSS

finish: steel, brass, smoked bronze, black
sku: US-TB-H-ST-C, NTB-054087, US-TB-H-SM-C, US-TB-H-BL-C



FURNITURE KNOB / PLATE / CROSS

CC: 4.3"
finish: steel, brass, smoked bronze, black
sku: US-KP-ST-A, NFK-054092, US-KP-SM-A, US-KP-BL-A



T-BAR / PLATE / CROSS

CC: 1.5"
finish: steel, brass, smoked bronze, black
sku: US-TB-HP-ST-C, NTB-054088, US-TB-HP-SM-C, US-TB-HP-BL-C



HOOK / CROSS

finish: steel, brass, smoked bronze
sku: NHS-07260, NHS-05258, NHS-09259



PULL BAR / CROSS

CC: 4.92" CC: 8.86" CC: 12.8"
finish: steel, brass, smoked bronze, black
sku: (small) US-PB-H-6.3-ST-A, NPB-054081, US-PB-H-6.3-SM-A, US-PB-HP-6.3-BL-A
sku: (medium) US-PB-H-10.2-ST-A, NPB-054079, US-PB-H-10.2-SM-A, US-PB-H-10.2-BL-A
sku: (large) US-PB-H-14.2-ST-A, NPB-054080, US-PB-H-14.2-SM-A, US-PB-H-14.2-BL-A



PULL BAR / PLATE / CROSS

CC: 4.92" CC: 8.86" CC: 12.8"
finish: steel, brass, smoked bronze, black
sku: (small) US-PB-HP-6.3-ST-A, NPB-054084, US-PB-HP-6.3-SM-A, US-PB-HP-6.3-BL-A
sku: (medium) US-PB-HP-10.2-ST-A, NPB-054082, US-PB-HP-10.2-SM-A, US-PB-HP-10.2-BL-A
sku: (large) US-PB-HP-14.2-ST-A, US-PB-HP-14.2-BR-A, US-PB-HP-14.2-SM-A, US-PB-HP-14.2-BL-A



CLOSET BAR / CROSS

CC: 28.5"
finish: steel, brass, smoked bronze, black
sku: US-CB-29.9-ST-A, US-CB-29.9-BR-A, US-CB-29.9-SM-A, US-CB-29.9-BL-A

PULL BAR / DOUBLE-SIDED / CROSS

Fits a 0.4-2.36" door. CC: 8.86"
finish: steel, brass, smoked bronze, black
sku: NPB-07387, NPB-05388, NPB-09389, NPB-02390

CLOSET BAR / DOUBLE-SIDED / CROSS

Fits a 0.4-2.36" door. CC: 28.5"
finish: steel, brass, smoked bronze, black
sku: NCB-07391, NCB-05392, NCB-09393, NCB-02394

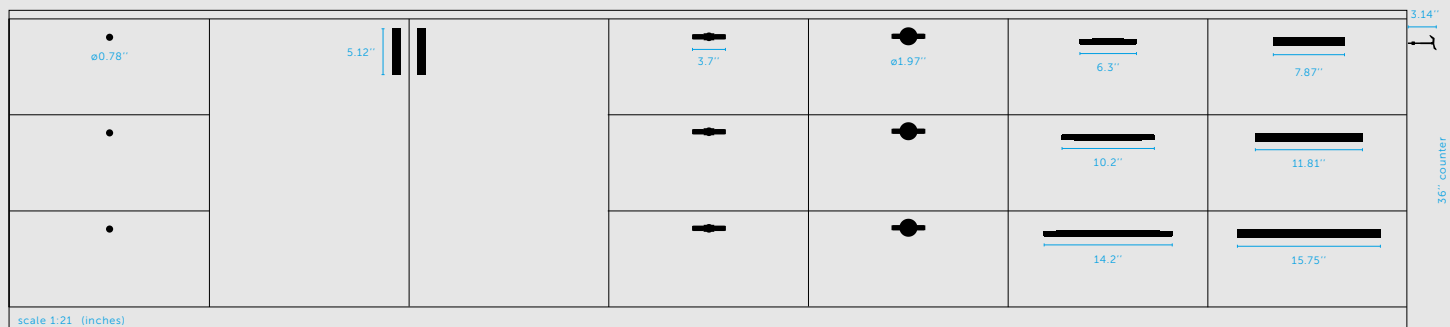
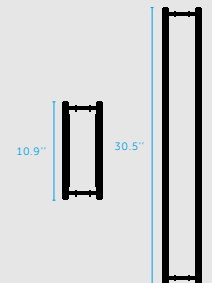
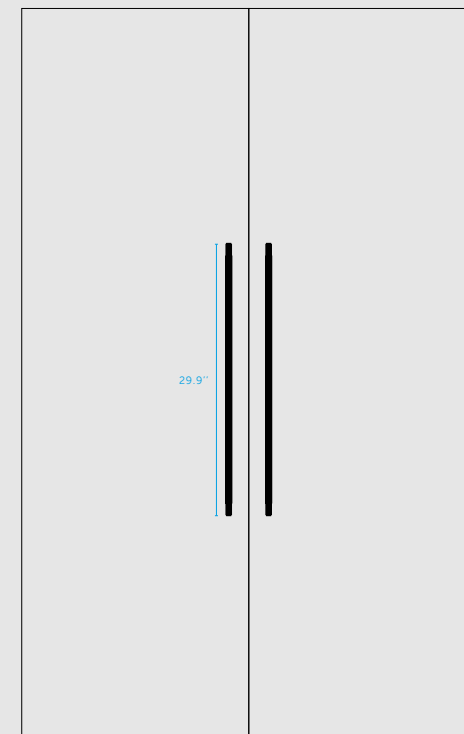

knurl:

cross

types:

- cabinet pulls
- cabinet knobs
- double-sided pulls
- hooks

finish:

- steel
- brass
- smoked bronze
- black

CABINET HARDWARE

CAST

Cast cabinet hardware brings a distinctive architectural look to your interiors. The contrasts of rough and smooth have a dynamic aesthetic that adds strength to any style of setting. The range features one-of-a-kind rough cast knuckles and grips, hand-polished solid metal bars and is finished with spun screw detailing. The collection includes furniture knobs, pull bars, closet bars and T-bars.



featured:
T-BAR / CAST
PULL BAR / CAST

finish:
STEEL

featured:

PULL BAR / CAST



featured:

FURNITURE KNOB / CAST

finish:

BRASS

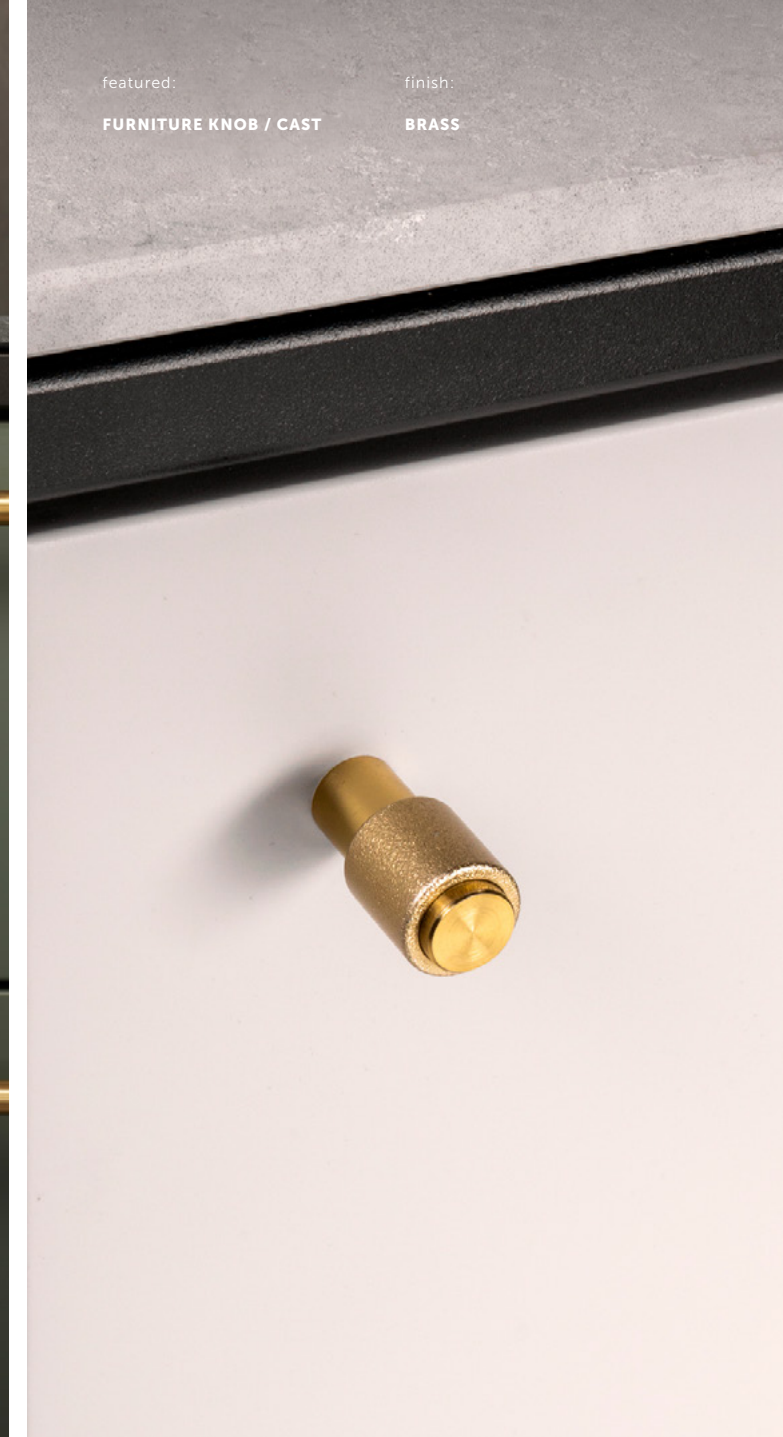



FURNITURE KNOB / CAST

finish:	sku:
steel	UFK-071272
brass	COMING LATE '24
aged brass*	UFK-051273
gun metal*	UFK-351274
welders black	UFK-481275

PULL BAR / CAST

	CC: 5.9"	CC: 9.84"	CC: 13.78"
finish:			
sku: (small)		sku: (medium)	sku: (large)
steel	UPB-072109	UPB-072113	UPB-072117
brass	COMING LATE '24	COMING LATE '24	COMING LATE '24
aged brass*	UPB-052110	UPB-052114	UPB-052118
gun metal*	UPB-352111	UPB-352115	UPB-352119
welders black	UPB-592112	UPB-592116	UPB-592120



T-BAR / CAST

finish:	sku:
steel	COMING LATE '24
brass	COMING LATE '24
welders black	COMING LATE '24



HOOK / CAST

finish:	sku:
steel	COMING LATE '24
brass	COMING LATE '24
welders black	COMING LATE '24

*Limited production or discontinued product. Please check availability.



scale 1:21 (inches)



FURNITURE KNOB / DOUBLE-SIDED / CAST

Fits a 0.3-2.3" door.

finish:	sku:
steel	UFK-071280
brass	COMING LATE '24
aged brass*	UFK-051281
gun metal*	UFK-351282
welders black	UFK-481283



0.75" thick door



CLOSET BAR / CAST

CC: 28.54"

finish:	sku:
steel	UCB-072121
brass	COMING LATE '24
aged brass*	UCB-052122
gun metal*	UCB-352123
welders black	UCB-592124

CLOSET BAR / DOUBLE-SIDED / CAST

Fits a 0.3-2.3" door. CC: 28.54"

finish:	sku:
steel	COMING LATE '24
brass	COMING LATE '24
welders black	COMING LATE '24



PULL BAR / DOUBLE-SIDED / CAST

Fits a 0.3-2.3" door.
CC: 5.9" / 9.84" / 13.78"

finish:	sku:
steel	COMING LATE '24
brass	COMING LATE '24
welders black	COMING LATE '24

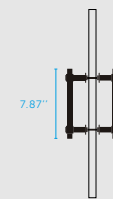

7.87"

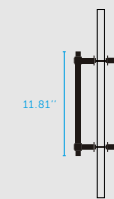

11.81"

1.38" thick door

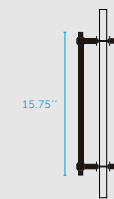

15.75"

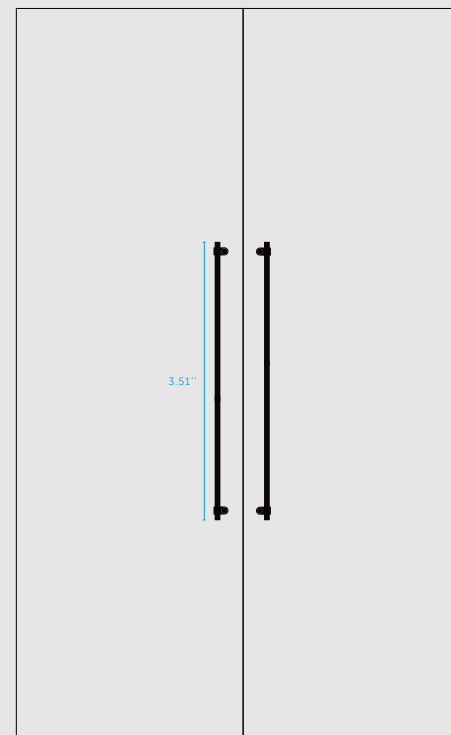

3.51"

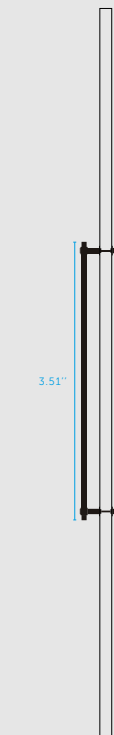

3.51"

80" closet door



look:

cast

types:

- cabinet pulls
- cabinet knobs
- double-sided pulls
- hooks

finish:

- steel
- brass
- aged brass
- gun metal
- welders black

detail:

- rough-cast knuckles
- solid metal

DOOR HARDWARE

DOOR HARDWARE

Crafted from solid metal and refined by hand, our door hardware is your interior's tactile handshake. Complete your B+P door styling with matching hinges, escutcheon plates and thumbturn locks.



DOOR HARDWARE

LINEAR

Linear door hardware is elegant and refined. With a linear knurling pattern and slimmed proportions, it has a stylish and confident hand feel. Door handles have a unique oval stem, and its torx screw adds a gentle taper to the design. The range includes door handles and door knobs, which can be combined with our hinges, strike plates and escutcheon plates for a harmonious B+P door look.



featured:

DOOR STOP / FREESTANDING

finish:

GUN METAL



featured:

**DOOR HANDLE / LINEAR
2G DIMMER**

finish:

BRASS



featured:

**DOOR HANDLE / LINEAR
THUMBTURN / LINEAR**

finish:

STEEL

DIRECTORY **DOOR HARDWARE / LINEAR**



DOOR HANDLE SET / PASSAGE / LINEAR

Linear-knurled solid metal. Spring assisted rose to ensure handle re-centres. Fits door thickness 1-3/8"-2" fittings supplied. 2-1/8" diameter, standard bore. Includes a passage tubular latch with 2-3/8" backset. Sold in pairs.

finish:	sku:
steel	NLH-071038
brass	NLH-051037
welders black	NLH-481036



DOOR HANDLE SET / PRIVACY / LINEAR

Linear-knurled solid metal. Spring assisted rose to ensure handle re-centres. Fits door thickness 1-3/8"-2" fittings supplied. 2-1/8" diameter, standard bore. Includes a privacy tubular latch with 2-3/8" backset. Sold in pairs.

finish:	sku:
steel	NLH-071042
brass	NLH-051041
gun metal*	NLH-091043
welders black	NLH-481040



DOOR KNOB SET / LINEAR

Linear-knurled solid metal. Unsprung, sold in pairs. Comes with 8mm square spindle. Fits doors of minimum thickness 1-3/8" with supplied fittings. 2-1/8" diameter, standard bore. Tubular latch sold separately. Sold in pairs.

finish:	sku:
steel	NDK-071066
brass	NDK-051065
welders black	NDK-481064



DOOR KNOB / DOUBLE-SIDED / LINEAR

Fixed door knob, double-sided. Sold in pairs.

finish:	sku:
steel	NDK-051074
brass	NDK-071073
gun metal*	NDK-091075
welders black	NDK-481072



DOOR KNOB / SINGLE-SIDED / LINEAR

Fixed door knob, single-sided. Sold as single.

finish:	sku:
steel	NDK-071070
brass	NDK-051069
gun metal*	NDK-091071
welders black	NDK-481068



THUMBTURN LOCK / LINEAR

Thumbturn lock with coin release. Solid linear-knurled metal. 1.625" hole centre distance. Latches sold separately.

finish:	sku:
steel	NLL-071082
brass	NLL-051081
welders black	NLL-481080



DOOR STOP / FREESTANDING / LINEAR

finish:	sku:
steel	UDS-071542
aged brass*	UDS-051543
gun metal*	UDS-351544
welders black	UTB-592554



scale 1:21 (inches)

*Limited production or discontinued product. Please check availability.



knurl:

linear

types:

door lever handles

door knobs

thumbturn locks

door stops

finish:

steel



brass



aged brass



gun metal



welders black



DOOR HARDWARE

CROSS

Cross door hardware has industrial cues, with sharpness and precision in its solid metal construction. The look is resolved with our coin screws, brushed elements, and refined by hand. Use it to create a seamless interior, with details and hardware that flow through your spaces. The range includes door handles, door knobs, door stops, locks, hinges and strike plates, plus escutcheon plates, to ensure no detail is overlooked.



featured:

DOOR HANDLE SET / ARCHITECTURAL / CROSS
THUMBTURN LOCK / ARCHITECTURAL / CROSS
1G DIMMER

finish:

STEEL



featured:

DOOR HANDLE SET / PASSAGE / CROSS

finish:

BRASS





DOOR HANDLE SET / PASSAGE / CROSS

Cross-knurled solid metal. Spring assisted rose to ensure handle re-centres. Fits door thickness 1-3/8"-2" fittings supplied. 2-1/8" diameter, standard bore. Includes a passage tubular latch with 2-3/8" backset. Sold in pairs.

finish:	sku:
steel	NLH-07169
brass	NLH-05167
smoked bronze	NLH-093636
black	NLH-02166



DOOR HANDLE SET / ARCHITECTURAL / CROSS

Unsprung/passage designed for UK, can be used with mortise lock (sold separately). Sold in pairs. Match with ø2" thumbturn lock. Only available through authorised Buster + Punch dealers.

finish:	sku:
steel	UK-LH-U-38-ST-A
brass	UK-LH-U-38-BR-A
smoked bronze	UK-LH-U-38-SM-A
black	UK-LH-U-38-BL-A

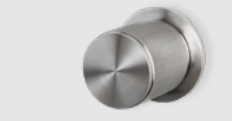

DOOR KNOB SET / CROSS

Cross-knurled solid metal. Unsprung, sold in pairs. Comes with 8mm square spindle. Fits doors of minimum thickness 1-3/8" with supplied fittings. 2-1/8" diameter, standard bore. Tubular latch sold separately. Sold in pairs.

finish:	sku:
steel	NDK-07246
brass	NDK-05247
smoked bronze	NDK-09248
black	NDK-02249



DOOR HANDLE SET / PRIVACY / CROSS

Cross-knurled solid metal. Spring assisted rose to ensure handle re-centres. Fits door thickness 1-3/8"-2" fittings supplied. 2-1/8" diameter, standard bore. Includes a privacy tubular latch with 2-3/8" backset. Sold in pairs.

finish:	sku:
steel	NLH-07181
brass	NLH-05179
smoked bronze	NLH-093640
black	NLH-02178



DOOR KNOB / FIXED / DOUBLE-SIDED / CROSS

Fixed door knob. Sold in pairs.

finish:	sku:
steel	NDK-02512
brass	NDK-05513
smoked bronze	COMING SOON
black	NDK-09515

DOOR KNOB / FIXED / SINGLE-SIDED / CROSS

Fixed door knob, single-sided. Sold as single.

finish:	sku:
steel	NDK-02508
brass	NDK-05509
smoked bronze	COMING SOON
black	NDK-09511



THUMBTURN LOCK / CROSS

Size ø2.24". Thumbturn lock with coin release. Solid cross-knurled metal. 1-5/8" hole centre distance. Latches sold separately.

finish:	sku:
steel	NLL-071501
brass	NLL-051502
smoked bronze	COMING SOON
black	NLL-02409



THUMBTURN LOCK / ARCHITECTURAL / CROSS

Size ø2" (CC:ø1.63"). Match with architectural door handle set. Only available through authorised Buster + Punch dealers.

finish:	sku:
steel	UK-TT-38-ST-A
brass	UK-TT-38-BR-A
black	UK-TT-38-BL-A



DOOR STOP / FLOOR

finish:	sku:
steel	NDS-07379
brass	NDS-05380
smoked bronze	NDS-09381
black	NDS-02382

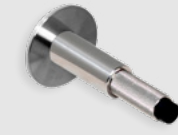

DOOR STOP / WALL

finish:	sku:
steel	NDS-07375
brass	NDS-05376
smoked bronze	NDS-09377
black	NDS-02378

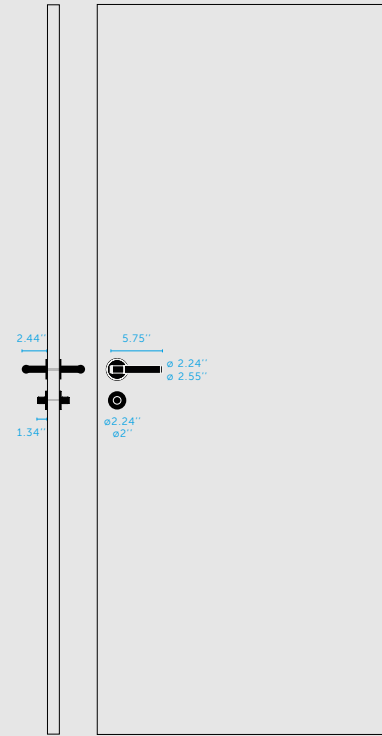
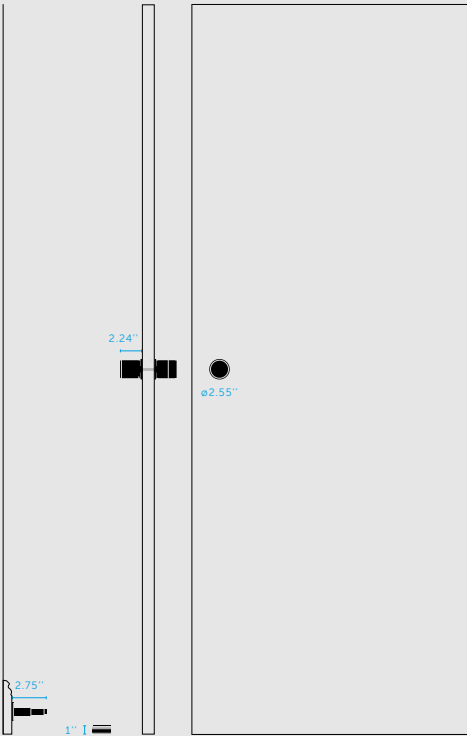

80" internal door

scale 1:21 (inches)



knurl:

cross

types:

door lever handles

door knobs

thumbturn locks

door stops

finish:

steel

brass

smoked bronze

black

DOOR ACCESSORIES

A collection of solid metal hinges, thumbturn locks, strike plates, key escutcheons and latches. All our door accessories are designed to complement our door hardware range, to complete your seamless look and elevate your interiors.



featured:

**EXHAUST SPOT
FURNITURE KNOB / CROSS
CLOSET BAR / CROSS
DOOR HANDLE / CROSS
THUMBTURN LOCK / CROSS**

featured:

HINGES

finish:

BRASS

featured:

**DOOR HANDLE / ARCHITECTURAL / CROSS
KEY ESCUTCHEON PLATE**

finish:

STEEL



DIRECTORY **DOOR ACCESSORIES**



KEY ESCUTCHEON PLATE

Match with architectural door handle set. Only available through authorised B+P dealers. Diameter 2.24".

finish:	sku:
steel	NES-071880
brass	NES-051881
welders black	NES-591884
black	NES-021882



EURO CYLINDER PLATE

Match with architectural door handle set. Only available through authorised B+P dealers. Diameter 2.24".

finish:	sku:
steel	NES-071886
brass	NES-051887
welders black	NES-591890
black	NES-021888



PRIVACY BOLT / THUMBTURN LOCK

2 3/8", 2 3/4" and 3 3/4" backset, for use with our thumbturn locks.

finish:	sku: (2 3/8")	sku: (2 3/4")	sku: (3 3/4")
steel	NDT-071722	NDT-071728	NDT-071734
brass	NDT-051721	NDT-051727	NDT-051733
gun metal*		NDT-351731	NDT-351737
black		NDT-021730	NDT-021736



DOOR HINGES / 3.5 X 3.5 INCH

Ball bearing, fixed pin. Set of 2.

finish:	sku:
steel	NHG-071852
brass	NHG-051853
welders black	NHG-591854

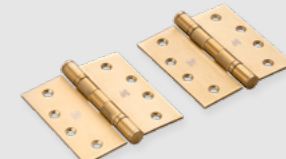

DOOR HINGES / 4 X 4 INCH

Ball bearing, fixed pin. Set of 2.

finish:	sku:
steel	NHG-071855
brass	NHG-051856
welders black	NHG-591857

types:

- escutcheon plates
- strike plates
- hinges
- latches

finish:

- steel
- brass
- gun metal
- smoked bronze
- welders black
- black



DOOR HANDLE TUBULAR LATCH / PRIVACY

2 3/8" and 2 3/4" backset, for use with our door handles / privacy (not fixed).

finish:	sku: (2 3/8")	sku: (2 3/4")
steel	NLL-07189	NLL-07193
brass	NLL-05187	NLL-05191
smoked bronze	NLL-09188	NLL-09192
black	NLL-02186	NLL-02190

DOOR HANDLE TUBULAR LATCH / PASSAGE

2 3/8" and 2 3/4" backset, for use with our door handles / passage (not fixed).

finish:	sku: (2 3/8")	sku: (2 3/4")
steel	NLL-07173	NLL-07177
brass	NLL-05171	NLL-05175
smoked bronze	NLL-09172	NLL-09176
black	NLL-02170	NLL-02174

DOOR KNOB TUBULAR LATCH

3 3/4" backset, for use with our door knobs (not fixed).

finish:	sku: (3 3/4")
steel	NLL-07194
brass	NLL-05195
smoked bronze	NLL-09196
black	NLL-02197



STRIKE PLATE KIT / T-SHAPED

Fits a 2" door.

finish:	sku:
steel	UDS-071775
brass	UDS-051776
gun metal*	UDS-351780
black	UDS-021778



STRIKE PLATE KIT / T-SHAPED

Fits a 2.5" door.

finish:	sku:
steel	UDS-071781
brass	UDS-051782
gun metal*	UDS-351786
black	UDS-021784



STRIKE PLATE KIT / T-SHAPED

Fits a 3" door.

finish:	sku:
steel	UDS-071787
brass	UDS-051788
gun metal*	UDS-351792
black	UDS-021790



STRIKE PLATE KIT / D-SHAPED

Fits a standard door.

finish:	sku:
steel	UDS-071793
brass	UDS-051794
gun metal*	UDS-351798
black	UDS-021796

*Limited production or discontinued product. Please check availability.

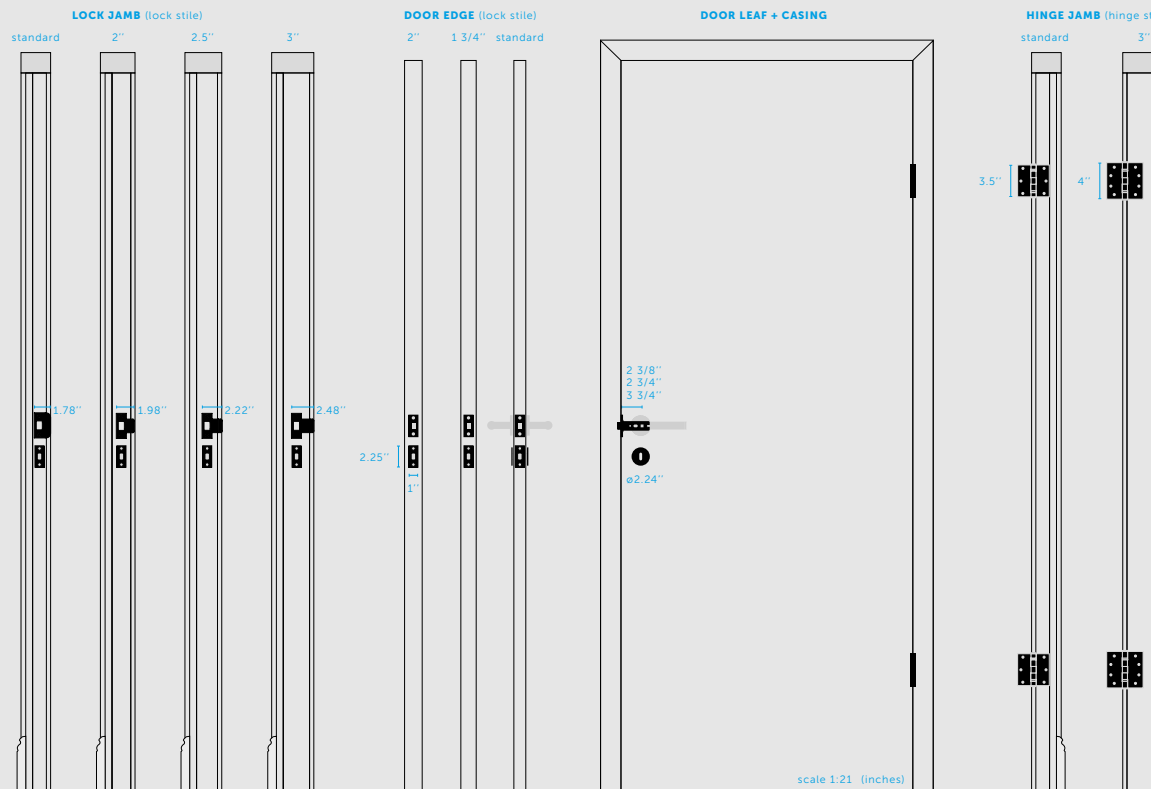

SWITCHES +

SWITCHES + OUTLETS

The customisable Buster + Punch switches and outlets collection is the pinnacle of interior detailing. Sleek and tactile, endlessly versatile, with an analogue action that connects you to your surroundings, they speak to the soul.



2023

SWITCHES + OUTLETS

CROSS

Level up your details with the Buster + Punch collection of switches and outlets. A one-stop solution that effortlessly ties together entire spaces, homes and contract interiors. The units feature a flat plate and are crowned with our trademark coin screws and diamond-cut knurled knobs and toggles – for unrivalled tactility. The collection includes light switches and dimmers, outlets, modules, back boxes, electricity plates, plus detail kits.

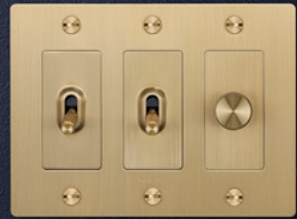

featured: **3G CUSTOM ELECTRICITY**
finish: **BRASS**

featured: **1G SOCKET / DUPLEX
T-BAR / PLATE**

finish: **SMOKED BRONZE**



featured: **2G CUSTOM ELECTRICITY**

finish: **WHITE + BRASS**



DIRECTORY **SWITCHES + OUTLETS**

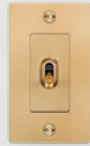

1G TOGGLE SWITCH

3-way / 15A / 120-277 V ac / 60 Hz

finish:	sku: (no logo)	sku: (logo)
white	NTG-143820	NTK-143426
steel	NTG-073819	NTK-073428
brass	NTG-053817	NTK-053424
smoked bronze	NTG-093818	NTK-453427
black	NTG-023816	NTK-023425

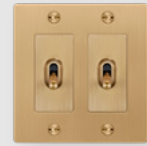

1G DOUBLE TOGGLE SWITCH

3-way / 15A / 120-277 V ac / 60 Hz

finish:	sku: (no logo)	sku: (logo)
white	NTG-143825	NTK-143433
steel	NTG-073824	NTK-073431
brass	NTG-053822	NTK-053429
smoked bronze	NTG-093823	NTK-453430
black	NTG-023821	NTK-023432



1G SOCKET / DUPLEX

15A / 125V / 5-15R / 60HZ

finish:	sku: (no logo)	sku: (logo)
white	NSC-143810	NSK-143423
steel	NSC-073809	NSK-073422
brass	NSC-053808	NSK-053420
smoked bronze	NSC-093806	NSK-453421
black	NSC-023807	NSK-023419



1G GFCI OUTLET

Style: Duplex 5-15R Outlet
Outlet: 15A / 120V / 60Hz
Class 1 outlet / Must be earthed. Tamper proof.

finish:	sku: (no logo)	sku: (logo)
white	NSC-143805	NSK-143508
steel	NSC-073804	NSK-073507
brass	NSC-053802	NSK-053506
smoked bronze	NSC-093803	NSK-093509
black	NSC-023801	NSK-023505



1G DIMMER / LED

3-way / 100-120 V ac / 60Hz
Dims:
250W (LED)

finish:	sku: (no logo)	sku: (logo)
white	NDK-144359	NDK-144354
steel	NDK-074358	NDK-074353
brass	NDK-054356	NDK-054351
smoked bronze	NDK-454357	NDK-454352
black	NDK-024355	NDK-024350



1G DIMMER / INCANDESCENT

3-way / 100-120 V ac / 60Hz
Dims:
600W (Incandescent)
150W (CFL)

finish:	sku: (no logo)	sku: (logo)
white	NDK-143799	NDK-143418
steel	NDK-073798	NDK-073417
brass	NDK-053800	NDK-053415
smoked bronze	NDK-093797	NDK-453416
black	NDK-023796	NDK-023414



1G COMBINATION DUPLEX + USB A+C CHARGER

Outlet: 15A / 125V AC / 60HZ
USB charger: Class 2 / USB Type-A / 5VDC / 2.4A
USB Type-C

finish:	sku: (no logo)	sku: (logo)
white	NSC-143815	NSK-143413
steel	NSC-073814	NSK-073412
brass	NSC-053812	NSK-053410
smoked bronze	NSC-093813	NSK-453411
black	NSC-023811	NSK-023409

Please note: White plates will include white outlets.
All other plates will include black outlets.



knurl:

cross

types:

dimmer switches

toggle switches

duplex outlets

USB outlets

finish:

white



steel



brass



smoked bronze



black



detail:

coin screw

solid metal

logo option*

certification:

cETLus



*Our plates can be selected with or without our etched logo.

DIRECTORY CUSTOM ELECTRICITY

Use our online configurator to create your own custom electricity pieces, combining different modules, inserts and detail kits. All set against our solid metal backplates and signature coin screws.

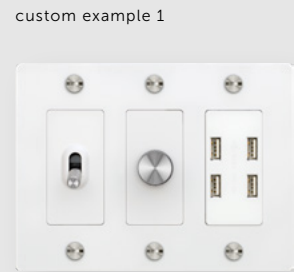

modules: **TOGGLE MODULE**
DIMMER MODULE
USB CHARGER MODULE / WHITE*
 plate: **3G PLATE / WHITE / NO LOGO**
 detail kit: **DIMMER DETAIL KIT / STEEL**
TOGGLE DETAIL KIT / STEEL
PLATE DETAIL KIT / STEEL

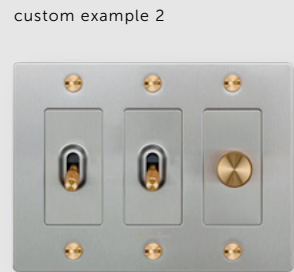

modules: **TOGGLE MODULE X2**
DIMMER MODULE
 plate: **3G PLATE / STEEL / LOGO**
 detail kit: **TOGGLE DETAIL KIT / BRASS X2**
DIMMER DETAIL KIT / BRASS

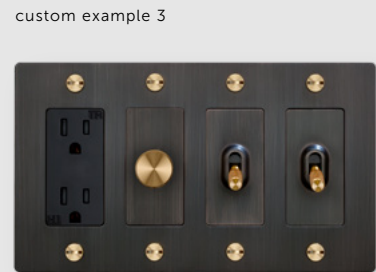

modules: **DUPLEX OUTLET / BLACK**
DIMMER MODULE
TOGGLE MODULE X2
 plate: **4G PLATE / SMOKED BRONZE / NO LOGO**
 detail kit: **PLATE DETAIL KIT / BRASS**
DIMMER DETAIL KIT / BRASS
TOGGLE DETAIL KIT / BRASS X2

WALL PLATES



DIMMER + TOGGLE MODULES



SOCKET + DATA MODULES

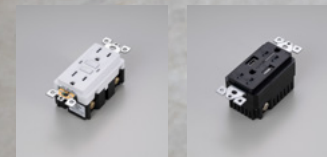

DETAIL KITS

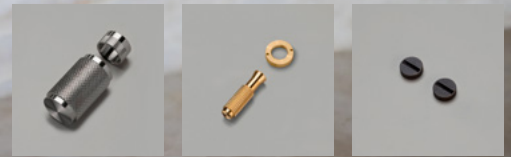

DIRECTORY **CUSTOM ELECTRICITY / PLATES**

WALL PLATE / LOGO

finish:	sku: (1G)	sku: (2G)	sku: (3G)	sku: (4G)
white	NPL-023061	NPL-143064	NPL-143067	NPL-143070
steel	NPL-07292	NPL-07297	NPL-07302	NPL-07307
brass	NPL-05289	NPL-05294	NPL-05299	NPL-05304
smoked bronze	NPL-09291	NPL-09296	NPL-09301	NPL-09306
black	NPL-053060	NPL-023063	NPL-023066	NPL-023069

WALL PLATE / NO LOGO

finish:	sku: (1G)	sku: (2G)	sku: (3G)	sku: (4G)
white	NPL-143581	NPL-143586	NPL-143591	NPL-143596
steel	NPL-073580	NPL-073585	NPL-073590	NPL-073595
brass	NPL-053578	NPL-053583	NPL-053588	NPL-053593
smoked bronze	NPL-093579	NPL-093584	NPL-093589	NPL-093594
black	NPL-023577	NPL-023582	NPL-023587	NPL-023592

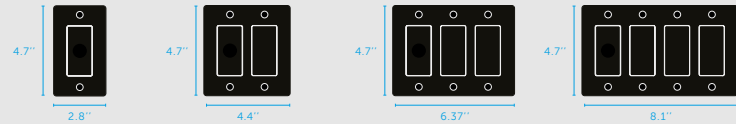

scale 1:10 (inches)

DIRECTORY **CUSTOM ELECTRICITY / MODULES**

DIMMER DETAIL KIT

finish:	sku:
white	NDK-143055
steel	NDK-073743
brass	NDK-053741
smoked bronze	NDK-093742
black	NDK-023054

TOGGLE DETAIL KIT

finish:	sku:
white	NTK-14332
steel	NTK-07330
brass	NTK-05323
smoked bronze	NTK-09327
black	NTK-02324

PLATE DETAIL KIT

finish:	sku:
white	NSK-14370
steel	NSK-07375
brass	NSK-05372
smoked bronze	NSK-09374
black	NSK-02373

DIRECTORY **CUSTOM ELECTRICITY / DETAIL KITS**

TOGGLE MODULES



TOGGLE MODULE

1 x On/off toggle switch
15A / 120-277V AC / 60Hz
Switching: single circuit or 3-way circuits.
ETL listed.

sku: NTM-01384



RETRACTIVE TOGGLE MODULE

1 x Momentary on/off toggle switch
15A / 120 - 277VAC / 60Hz
Switching: Retractive/momentary contact (Multiple location control and dimming, up to 10 switches, when used with B+P multipoint dimmer module, and when wired in a parallel circuit system). **Please consult with lighting and control expert. Not for standard circuit installations.** ETL listed.

sku: NTM-023526

Please note dimmer modules and toggle modules are compatible with our detail kits. Dimmer modules from other suppliers are not compatible with our detail kits.

DIRECTORY **CUSTOM ELECTRICITY / MODULES**

DIMMER MODULES



DIMMER MODULE / 250W LED

1 x Push on/off rotary dimmer
100-120V AC / 60 Hz
LED: 5-250W
HAL / INC: 10-300W.
Switching: single circuit or 3-way circuits.
Forward and Reverse Phase (Auto-Detect & User Over-ride). Certification: cETLus

sku: NDM-024061



DIMMER MODULE / MULTIPOINT

1 x Push on/off rotary dimmer
100-120V AC / 60 HZ
HAL / INC: 10-300W.
LED: 5-250W
Switching: Multi-location control and dimming capabilities when used with retractable switches, (and when wired in a parallel circuit system). **Please consult with lighting and control expert. Not for standard circuit installations.** Forward and Reverse Phase (Power ON/OFF override, Auto-Detect & User Over-ride). UL certified.

sku: NDM-013407



DIMMER MODULE / INCANDESCENT

1 x Push on/off rotary dimmer
100-120V AC / 60Hz
HAL / INC: 600W max.
LED: 5-150W
Switching: 3-way.
Forward Phase.
Certification: cETLus

sku: NDM-01385

Please note dimmer modules and toggle modules are compatible with our detail kits. Dimmer modules from other suppliers are not compatible with our detail kits.

*Limited production or discontinued product. Please check availability.

SOCKET MODULES



DUPLEX OUTLET MODULE

2 x duplex outlet / 15A / 125V / 5-15R / 60Hz
Certification: UL

finish: sku:

white	NXM-14253
black	NXM-02252



COMBINATION DUPLEX + USB A+C CHARGER MODULE

2 x duplex outlet: 15A / 125V / 5-15R / 60Hz
2 x USB charger: Class 2 / USB Type-A / 5VDC / 2.4A / USB Type-C / PD/QC3.0
Certification: ETL

finish: sku:

white	NSM-143243
black	NSM-023242



GFCI MODULE

2 x duplex outlet + GFCI: 15A / 125V / 60Hz
Class A outlet / Ground fault protection
Certification: UL

finish: sku:

white	NSM-143241
black	NSM-023240



COMBINATION DUPLEX + USB CHARGER MODULE*

2 x duplex outlet: 15A / 125V / 5-15R / 60Hz
2 x USB Type-A charger: Class 1 / 5V DC / 4.0A
Certification: UL

finish: sku:

white	NSC-14387
black	NSC-02386



USB CHARGER MODULE*

4 x USB Type-A Charger:
125VAC / 60Hz / 5VDC / Total 4.0A
Compatibility: USB A 1.1 / 2.0 / 3.0 devices.
Certification: UL

finish: sku:

white	NSC-14389
black	NSC-02388

LIGHTING

LIGHTING

Buster + Punch lighting anchors an interior with elegance and finesse. Sculpted from solid, cast and spun solid metals, the range is designed to be combined throughout spaces and interiors to bring versatility and aesthetic power in equal measure.



LIGHTING
EXHAUST

Exhaust is a flexible range of spotlights and pendants that bring versatile task lighting to any space, with styling to match. Its solid metal powder coated body is brought to life with functional detailing. The light features a knurled solid metal baffle to direct light, housing a honeycomb structure to reduce glare, and comes in a pendant, surface, spotlight or track light variation.

featured:

EXHAUST / TRACK
EXHAUST / SURFACE
CLOSET BAR / CROSS



featured:

EXHAUST / TRACK

finish:

GRAPHITE + GUN METAL



featured:

EXHAUST / SPOT

finish:

STONE + BRASS

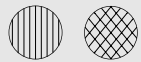



EXHAUST / SPOT

Requires detail kit, see next page.

finish: (body) **sku:** (body)

stone NBB-21694
 graphite NBB-17693



EXHAUST / SURFACE

Requires detail kit, see next page.

finish: (body) **sku:** (body)

stone NBB-21702
 graphite NBB-17701



EXHAUST / TRACK

Requires detail kit, see next page.

finish: (body) **sku:** (body)

stone NSH-21706
 graphite NSH-17705



EXHAUST / PENDANT

Requires detail kit, see next page.

finish: (body) **sku:** (body)

stone NBB-21698
 graphite NBB-17697

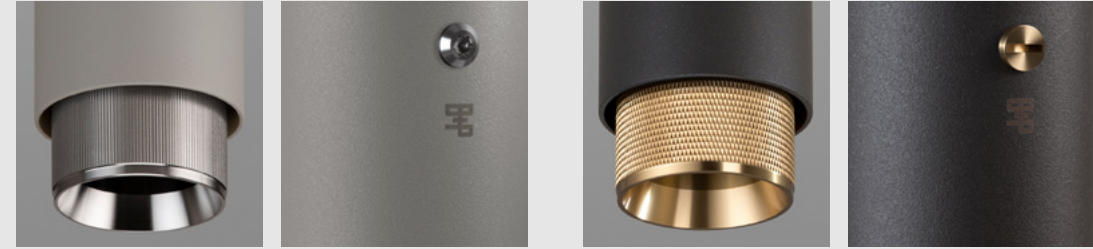

EXHAUST / DETAIL KIT / LINEAR

Requires Exhaust body, see previous page.

finish: **sku:** (linear)

steel NBB-07689
 burnt steel NBB-36796
 brass NBB-05688
 gun metal NBB-35690

EXHAUST / DETAIL KIT / CROSS

Requires Exhaust body, see previous page.

finish: **sku:** (cross)

steel UEDK-073523
 brass UEDK-053522
 smoked bronze UEDK-453524
 black UEDK-023534

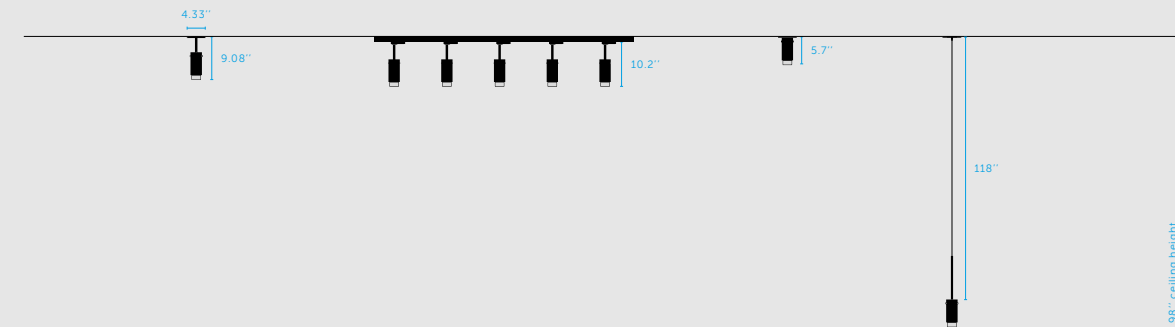

scale 1:40 (inches)

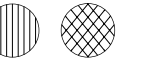

knurl:

linear

cross

types:

spot lights

track lights

surface mounted

pendant lights

finish details:

steel

burnt steel

brass

gun metal

smoked bronze

black

finish body:

stone

graphite

tech:

GU10

110-120V

Class 1

certification: UL

detail:

torx screws

coin screws

LIGHTING

FORKED

A tribute to solid metal and the techniques used to bring it to life, the modular Forked collection enralls the eye, with a form that's one of our largest in terms of physical scale and presence. Choose from a ceiling or pendant light, add a shade, globe or both, in the finish of your choice. Machined and handmade elements are fused into one design, finished with our one-of-a-kind rough cast fork detail. Each light comes with its own specially-designed B+P LED light bulb. For situations where you want a soft decorative light, the smoked globe variants are a good direction to explore. For a more functional ambient light choose a Forked with an opal globe. Adding a shade can also help to shape Forked's light qualities, making it more directional.

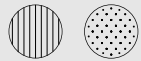

featured:

**FORKED / PENDANT / SHADE / GLOBE
3G CUSTOM ELECTRICITY
PULL BAR / CAST**

finish:

BRASS



DIRECTORY FORKED



FORKED / PENDANT / GLOBE

finish:	sku: (medium)	sku: (large)
steel + opal	NFP-843179	NFP-843180
brass + opal	NFP-823169	NFP-823170
gun metal + opal	NFP-873189	NFP-873190
steel + smoked	NFP-853181	NFP-853182
brass + smoked	NFP-493171	NFP-493172
gun metal + smoked	NFP-883191	NFP-883192



FORKED / PENDANT / SHADE / GLOBE

finish:	sku: (medium)	sku: (large)
steel + opal	NFP-833173	NFP-833175
steel + burnt steel + opal	NFP-893193	NFP-893195
brass + opal	NFP-813163	NFP-813165
gun metal + opal	NFP-863183	NFP-863185
steel + smoked	NFP-833174	NFP-833176
steel + burnt steel + smoked	NFP-893194	NFP-893196
brass + smoked	NFP-813164	NFP-813166
gun metal / smoked	NFP-863184	NFP-863186



FORKED / PENDANT / SHADE

finish:	sku: (medium)	sku: (large)
steel	NFP-833177	NFP-833178
steel + burnt steel	NFP-893197	NFP-893198
brass	NFP-813167	NFP-813168
gun metal	NFP-863187	NFP-863188



FORKED / PENDANT

finish:	sku:
steel	NFP-07728
brass	NFP-05730
gun metal	NFP-35732



FORKED / CEILING

finish:	sku:
steel	NFC-071145
brass	NFC-051146
gun metal	NFC-351147



FORKED / CEILING / GLOBE

finish:	sku: (medium)	sku: (large)
steel + opal	NFC-843215	NFC-843216
brass + opal	NFC-823205	NFC-823206
gun metal + opal	NFC-873225	NFC-873226
steel + smoked	NFC-853234	NFC-853235
brass + smoked	NFC-823207	NFC-493208
gun metal + smoked	NFC-883234	NFC-883235



FORKED / CEILING / SHADE / GLOBE

finish:	sku: (medium)	sku: (large)
steel + opal	NFC-853209	NFC-853211
steel + burnt steel + opal	NFC-893229	NFC-893231
brass + opal	NFC-813199	NFC-813201
gun metal + opal	NFC-863219	NFC-863221
steel + smoked	NFC-853210	NFC-853212
steel + burnt steel + smoked	NFC-893230	NFC-893232
brass + smoked	NFC-813200	NFC-813202
gun metal / smoked	NFC-863220	NFC-863222



FORKED / CEILING / SHADE

finish:	sku: (medium)	sku: (large)
steel	NFC-853213	NFC-853214
steel + burnt steel	NFC-893233	NFC-893234
brass	NFC-813203	NFC-813204
gun metal	NFC-863223	NFC-863224



FORKED / SHADE / MEDIUM

finish:	sku:
steel	UFS-07733
burnt steel	UFS-36739
brass	UFS-05735
gun metal	UFS-35737



FORKED / GLOBE / MEDIUM

finish:	sku:
opal	NFG-37750
smoked	NFG-09752



FORKED / SHADE / LARGE

finish:	sku:
steel	UFS-07741
burnt steel	UFS-36747
brass	UFS-05743
gun metal	UFS-35745



FORKED / GLOBE / LARGE

finish:	sku:
opal	NFG-37763
smoked	NFG-09765

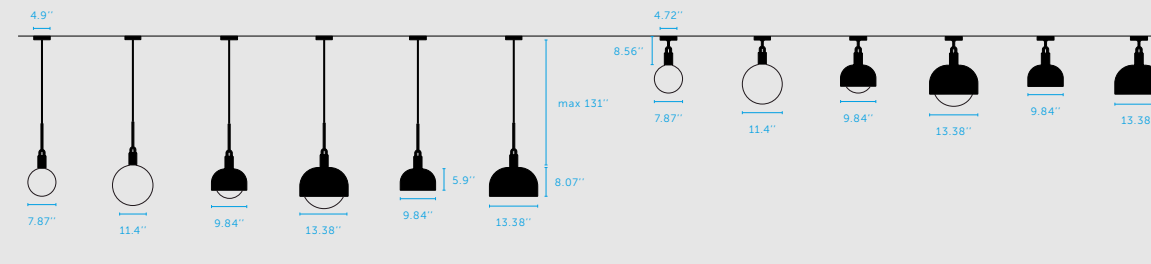

scale 1:52 (inches)

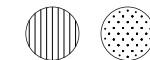

knurl:

- linear
- cast

types:

- pendant lights
- ceiling lights
- lamp shades

finish:

- steel
- burnt steel
- brass
- gun metal

tech:

- E26
- 110-120V
- certification: UL

detail:

- cast fork

LIGHTING
HOOKE

A lighting range that opens a sense of dynamic playfulness into an interior, Hooked's precisely machined hook is as functional as it is decorative. Select from wall or pendant options and add shades as you explore different vertical drop heights. Hooked's light fitting is made from solid metal, with diamond-cut cross knurling and a grooved section to allow easy fitting of its shade. In spaces with higher ceilings, explore Hooked's eye-catching chandeliers with bare pendants or pendants with shade combinations.



featured:
HOOKE 6.0 / NUDE

finish:
BRASS



featured:
HOOKE WALL / SMALL

finish:
GRAPHITE + BRASS



featured:
HOOKE 3.0 / MIX

finish:
STONE + STEEL





HOOKED WALL / NUDE

Can be fitted as standalone or connected to a US outlet box. Includes a retrofit wall plate that is 4.75" W x 7.25" H.

finish:	sku:
stone + steel	NHW-23337
stone + brass	NHW-25335
stone + smoked bronze	NHW-24336
graphite + steel	NHW-19340
graphite + brass	NHW-18338
graphite + smoked bronze	NHW-20339



HOOKED 1.0 / NUDE

finish:	sku:
steel	NHK-07322
brass	NHK-05320
smoked bronze	NHK-09321



HOOKED WALL / SMALL

Can be fitted as standalone or connected to a US outlet box. Includes a retrofit wall plate that is 4.75" W x 7.25" H.

finish:	sku:
stone + steel	NHW-23519
stone + brass	NHW-25517
stone + smoked bronze	NHW-24518
graphite + steel	NHW-19516
graphite + brass	NHW-18514
graphite + smoked bronze	NHW-20515



HOOKED 1.0 / SMALL

finish:	sku:
stone + steel	NHK-23489
stone + brass	NHK-25481
stone + smoked bronze	NHK-24485
graphite + steel	NHK-19488
graphite + brass	NHK-18480
graphite + smoked bronze	NHK-20484



HOOKED WALL / LARGE

Can be fitted as standalone or connected to a US outlet box. Includes a retrofit wall plate that is 4.75" W x 7.25" H.

finish:	sku:
stone + steel	NHW-23513
stone + brass	NHW-25511
stone + smoked bronze	NHW-24512
graphite + steel	NHW-19510
graphite + brass	NHW-18508
graphite + smoked bronze	NHW-20509



HOOKED 1.0 / LARGE

finish:	sku:
stone + steel	NHK-23487
stone + brass	NHK-25479
stone + smoked bronze	NHK-24483
graphite + steel	NHK-19486
graphite + brass	NHK-18478
graphite + smoked bronze	NHK-20482



HOOKED SHADE / SMALL

finish:	sku:
stone	NSH-33261
graphite	NSH-34260



HOOKED SHADE / LARGE

finish:	sku:
stone	NSH-33259
graphite	NSH-34258



HOOKED 3.0 / NUDE

finish:	sku:
steel	NHK-07325
brass	NHK-05323
smoked bronze	NHK-09324



HOOKED 6.0 / NUDE

finish:	sku:
steel	NHK-07328
brass	NHK-05326
smoked bronze	NHK-09327



HOOKED 3.0 / MIX

finish:	sku:
stone + steel	NHK-23495
stone + brass	NHK-25491
stone + smoked bronze	NHK-24493
graphite + steel	NHK-19494
graphite + brass	NHK-18490
graphite + smoked bronze	NHK-20492



HOOKED 6.0 / MIX

finish:	sku:
stone + steel	NHK-23501
stone + brass	NHK-25497
stone + smoked bronze	NHK-24499
graphite + steel	NHK-19500
graphite + brass	NHK-18496
graphite + smoked bronze	NHK-20498

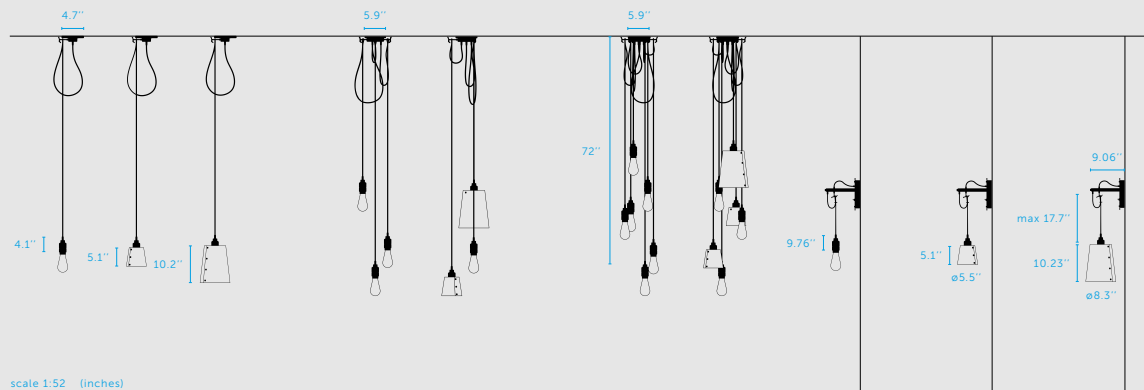

knurl:

cross

types:

- pendant lights
- wall lights
- chandeliers
- lamp shades

finish:

- steel
- brass
- smoked bronze
- black
- stone
- graphite

tech:

- E26
- 110-120V
- certification: UL

detail:

coin screw

LIGHTING

CAGED

Create your own skyline with the Caged collection. Light metal volumes edge into slabs of natural stone, finished with our signature coin screw details. Available as wall, ceiling or larger multi-light fixtures.



featured:

**CAGED WALL / LARGE
EXHAUST / TRACK**



featured:

**CAGED WALL / LARGE
CAGED WALL / X-LARGE
CAGED 4.0**

finish:

WHITE MARBLE



DIRECTORY **CAGED**



CAGED WALL / SMALL

This can also be fitted as a ceiling light.

finish: white marble
black marble

sku: NCA-14290
NCA-02291



CAGED WALL / MEDIUM

finish: white marble
black marble

sku: NCA-14288
NCA-023397



CAGED WALL / LARGE

finish: white marble
black marble

sku: NCA-143396
NCA-023395



CAGED WALL / X-LARGE

finish: white marble
black marble

sku: NCA-14292
NCA-023401



CAGED CEILING / LARGE

finish: white marble
black marble

sku: NCA-14278
NCA-023389



CAGED CEILING 4.0

finish: white marble
black marble

sku: NCA-14282
NCA-02283



CAGED CEILING 5.0

finish: white marble
black marble

sku: NCA-14284
NCA-02285



CAGED CEILING / EXTENSION CAGE

To fit Caged 4.0 and Caged 5.0.

legth: 19.5"

sku: NCA-02407

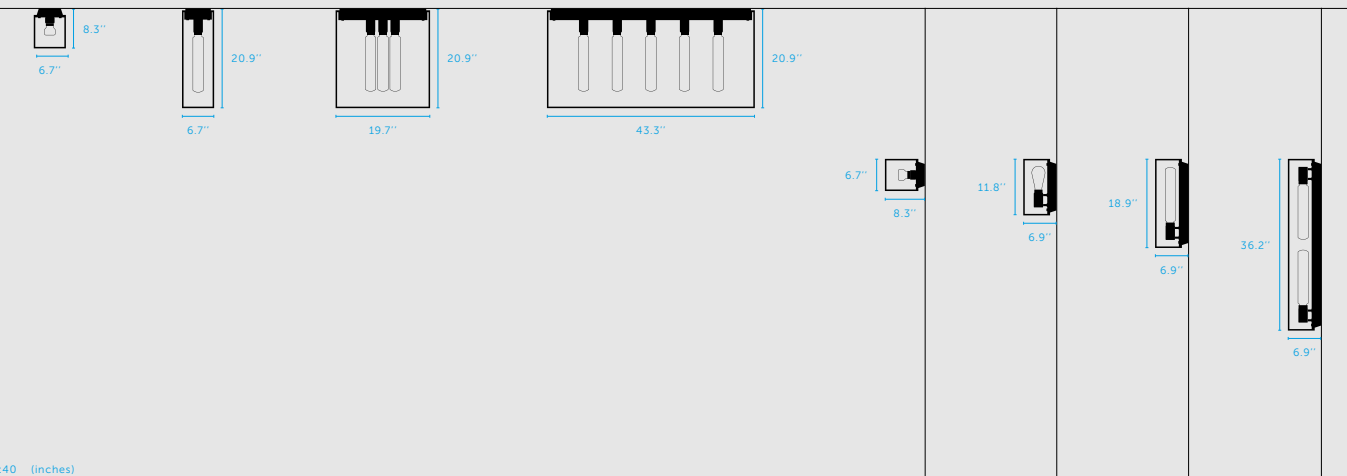

scale 1:40 (inches)



knurl:

cross

types:

ceiling lights

wall lights

finish:

white marble

black marble

tech:

E26

110-120V

certification: UL

detail:

coin screws

LIGHTING
CAGED WET

Our first wet-rated lighting series. Caged Wet's structural aesthetic is the perfect enhancement for outdoor environments, bathrooms and spa spaces. Its unique cast backplate creates a dynamic look, while glazing protects its signature B+P lamp holder from the elements. Wall and ceiling versions bring versatility to your styling.



finish:
GUN METAL



featured:
CAGED WET / LARGE

finish:
BRASS



CAGED WET / SMALL

This can also be fitted as a wall light.
Suitable for wet locations.

finish:	sku:
steel	NCA-02683
brass	NCA-14682
gun metal	NCA-02684
black + steel	NCA-473536
black + brass	NCA-063538
black + gun metal	NCA-533537



CAGED WET / LARGE

Suitable for wet locations.

finish:	sku:
steel	NCA-552526
brass	NCA-052528
gun metal	NCA-352527
black + steel	NCA-473539
black + brass	NCA-063541
black + gun metal	NCA-533540

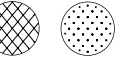

knurl:

- cross
- cast

types:

- ceiling lights
- wall lights

finish:

- steel
- brass
- gun metal

tech:

- E26
- 110-120V
- cULus certified
- UL wet rated
- ADA compliant

detail:

- coin screws

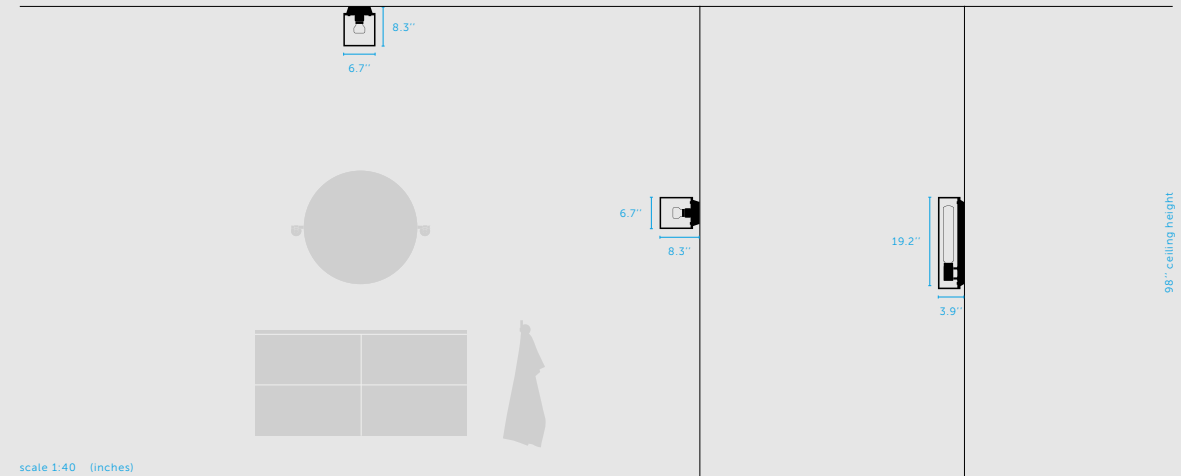

LIGHTING
HERO LIGHT

Sometimes a space needs a Hero. Hero's solid metal, powder coated ring has subtle references to the traditions of blacksmithing and forging. Choose whether you want to hang its six solid metal cross-knurled pendants centrally or run them around the light's circumference. With matching solid metal cord weights and coin screw detailing. Hero is a perfect complement to our Hooked range, which shares similar details.



finish:

GRAPHITE + BRASS



featured:

**HERO LIGHT
CAGED WALL / LARGE**



HERO LIGHT

type:	finish:	sku:
30"	stone + steel	NHE-232181
30"	stone + brass	NHE-252176
30"	stone + smoked bronze	NHE-602978
30"	graphite + steel	NHE-192186
30"	graphite + brass	NHE-182184
30"	graphite + smoked bronze	NHE-202178
49"	stone + steel	NHE-232183
49"	stone + brass	NHE-252177
49"	stone + smoked bronze	NHE-602979
49"	graphite + steel	NHE-192187
49"	graphite + brass	NHE-182185
49"	graphite + smoked bronze	NHE-202179



knurl:

cross

type:

pendant light

finish details:

- steel
- brass
- smoked bronze

finish crown:

- stone
- graphite

tech:

E26
110-120V
certification: UL

detail:

coin screw

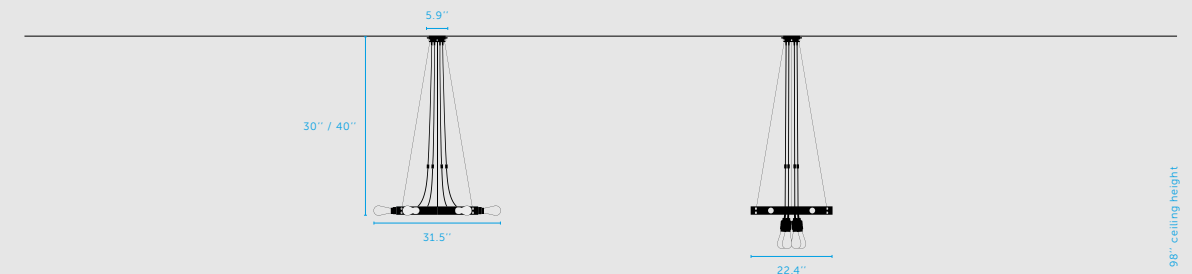

scale 1:52 (inches)

LIGHTING
HEAVY METAL

Heavy Metal is more than a pendant. It's a statement. The light's solid metal construction, diamond-cut cross-knurled body and range of finishes have made it a permanent Buster + Punch favourite across the world. A simple but provocative design that works effortlessly in all spaces and settings. Select from linear or cross-knurled in multiple finishes.



featured: **HEAVY METAL**
BUSTER BULB

finish: **SMOKED BRONZE**
GOLD



featured: **HEAVY METAL**
BUSTER BULB

finish: **STEEL**
SMOKED





HEAVY METAL / LINEAR

finish: (linear) **sku:** (linear)

steel	NHM-072910
burnt steel	NHM-361604
brass	NHM-052911
gun metal	NHM-351605



HEAVY METAL / CROSS

finish: (cross) **sku:** (cross)

steel	NHM-07651
brass	NHM-05649
smoked bronze	NHM-09650
matt black	NHM-02648

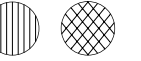
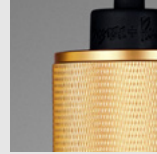

knurl:

linear

cross

type:

pendant light

finish:

steel 

burnt steel 

brass 

gun metal 

smoked bronze 

matt black 

tech:

E26

110-120V

certification: UL

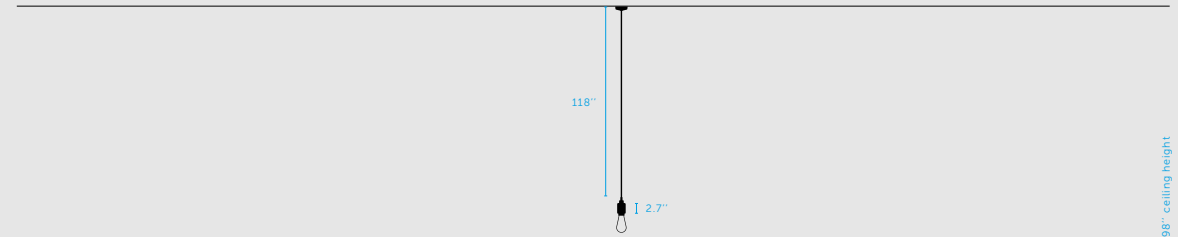

scale 1:52 (inches)

LIGHTING
CHANDELIERS

Buster + Punch Chandeliers are powerful pieces; decadent and impactful. Designed around 10, 19 or 31 of our Heavy Metal or Exhaust pendants, with bespoke drop heights and two formations, cascade and classic. The Exhaust Chandeliers are perfect for scenarios that need more of an intimate light, like above dining tables, or social zones. In contrast, Heavy Metal Chandeliers add an ambient glow that's well-suited for interiors that need a real statement piece.

CHANDELIER / EXHAUST

FORMATION



BODY



DETAIL



CHANDELIER / HEAVY METAL

FORMATION

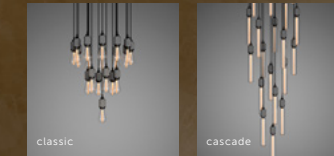

KNURL



BULB

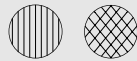

DIRECTORY
CHANDELIERS

Use our online configurator to create your own custom Buster + Punch chandelier in cascade or classic formations. Choose from Exhaust or Heavy Metal pendants, select your finish, then tailor your drop height and mounting preference.

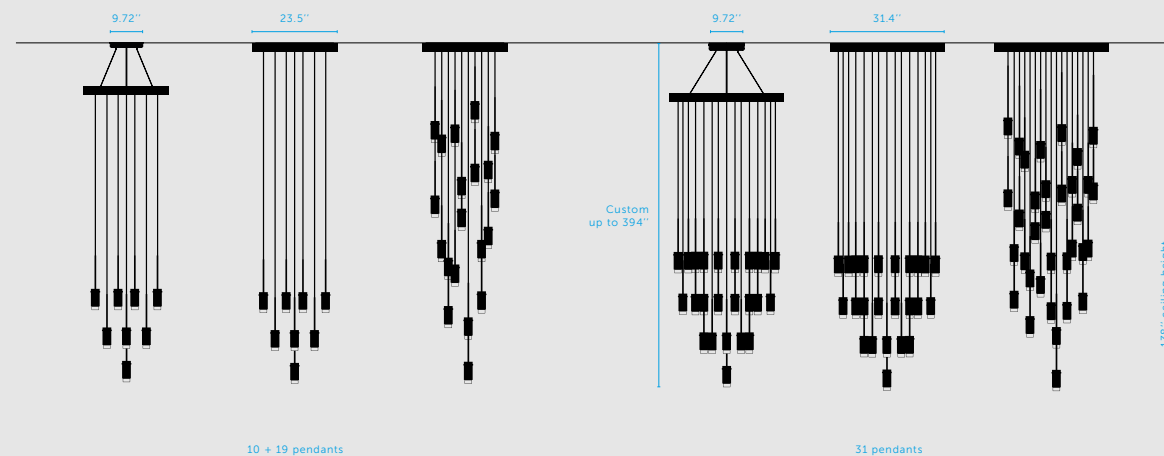

scale 1:52 (inches) B+P Chandeliers can be designed online using our configurator and are made bespoke to your requirements.

types:

- 10 pendants
- 19 pendants
- 31 pendants

formation:

- classic
- cascade

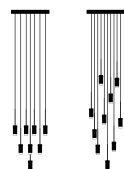

mounting:

- surface
- suspended

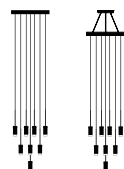

DIRECTORY
CHANDELIER / EXHAUST



body finish:
 stone
 graphite

knurl:

- linear
- or
- cross

detail finish:

- steel
- burnt steel
- brass
- gun metal

detail finish:

- steel
- brass
- smoked bronze
- black

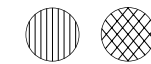

knurl:

- linear
- cross

finish details:

- steel
- burnt steel
- brass
- gun metal
- smoked bronze
- black

finish body:

- stone
- graphite

tech:

- GU10
- 110-120V
- Class 1
- certification: UL

detail:

- torx screws
- coin screws

DIRECTORY
CHANDELIER / HEAVY METAL



knurl:

- linear
- or
- cross

finish:

- steel
- burnt steel
- brass
- gun metal

finish:

- steel
- brass
- smoked bronze
- black

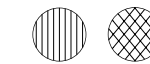

knurl:

- linear
- cross

finish:

- steel
- burnt steel
- brass
- gun metal
- smoked bronze
- matt black

tech:

- E26
- 110-120V
- certification: UL

LIGHTING BULBS

Our patented designer LED light bulbs were the world's first, and are the perfect complement to our lighting collections. They're designed to be as good looking as they are energy efficient, with a range of shells in glass or polycarbonate to help you create the perfect lighting ambience. From the ground-breaking Buster Bulb to the compact Puck and our elegant Tube, there's nothing quite like them. Let there be light.



featured: **BUSTER BULB**
finish: **SMOKED**

DIRECTORY BULBS



PUNCH BULB / PUCK

5W dimmable / LED light bulb / E27 screw / 120V~ / ETL certified
To fit shades.

finish: opal
sku: (dimmable) NPB-371576

2W non-dimmable / LED light bulb / E27 screw / 100-240V~ / ETL certified
To fit shades.

finish: opal
sku: (non-dimmable) NPB-371577



BUSTER BULB

5W dimmable / LED light bulb / E26 screw / 120V~ / ETL certified

finish: crystal
gold
smoked
sku: (dimmable) BB-TD-E26-D-CR-B
BB-TD-E26-D-GO-B
BB-TD-E26-D-SM-B

2W non-dimmable / LED light bulb / E26 screw / 100-240V~ / ETL certified

finish: crystal
gold
smoked
sku: (non-dimmable) BB-TD-E26-ND-CR-B
BB-TD-E26-ND-GO-B
BB-TD-E26-ND-SM-B



BUSTER BULB / TUBE

5W dimmable / LED light bulb / E26 screw / 120V~ / ETL certified

finish: crystal
sku: (dimmable) BB-TU11-E26-D-CR-B

2W non-dimmable / LED light bulb / E26 screw / 100-240V~ / ETL certified

finish: crystal
sku: (non-dimmable) BB-TU11-E26-ND-CR-B



BUSTER BULB / FORKED

5W dimmable / LED light bulb / E26 screw / cULus certified
To fit Forked Globe smoked

finish: opal
sku: NFB-371580



PUNCH BULB / FORKED

5W dimmable / LED light bulb / 26 screw / cULus certified
To fit Forked Globe smoked

finish: clear
sku: NFB-011581



GU10 LED BULB

7W dimmable / GU10 screw
Sold in sets of 3.
To fit Exhaust spotlights

finish: crystal
sku: NEB-01832

types:

E27 bulbs
GU10 bulbs

finish details:

clear
crystal
opal
amber
gold
smoked

tech:

For breakdown of lumen and light appearance for individual bulb finishes refer to tech specs.

KITCHEN

KITCHEN

The Buster + Punch kitchen collection transforms the heart of a home. Elevate your space's style with accessories, shelving and our striking mixer faucets. Complete with B+P lighting plus switches and outlets in a matching finish – details are everything in this space.



KITCHEN
FAUCETS + SINK ACCESSORIES

The Buster + Punch mixer faucet has a striking visual edge and is designed to complement our kitchen hardware and lift it to a new level of refinement. A rough cast base, hand polished neck, diamond-cut knurling on the aerator cap and either a cross or linear-knurled lever combine in this striking kitchen talking point.

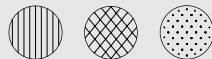

featured:

**KITCHEN FAUCET / MIXER WITH DUAL SPRAY PULL-OUT / CROSS
AIR GAP
AIR SWITCH**

finish:

BLOND BRASS



featured:

**KITCHEN FAUCET / LINEAR
PULL BAR / LINEAR**



finish:

GUN METAL



DIRECTORY **KITCHEN / FAUCETS**



KITCHEN FAUCET / MIXER

A kitchen faucet with single lever mixer.

finish: (linear)	sku: (linear)	finish: (cross)	sku: (cross)
steel	NKT-071672	steel	NKT-071668
blond brass	NKT-051673	blond brass	NKT-051669
gun metal	NKT-351683	gun metal	NKT-351671
welders black	NKT-591682	welders black	NKT-591670



KITCHEN FAUCET / MIXER WITH DUAL SPRAY PULL-OUT

A kitchen faucet with pull-out and dual spray function, mixing warm and cold, aerated water. Pull-out nozzle can be toggled between aerated or a needle spray.

finish: (linear)	sku: (linear)	finish: (cross)	sku: (cross)
steel	NKT-073259	steel	NKT-073255
blond brass	NKT-053258	blond brass	NKT-053254
gun metal	NKT-353260	gun metal	NKT-353256
welders black	NKT-593261	welders black	NKT-593257



KITCHEN FAUCET / MIXER WITH PULL-OUT SPRAY

A kitchen faucet mixer with pull-out spray.

finish: (linear)	sku: (linear)	finish: (cross)	sku: (cross)
steel*	NKT-071680	steel*	NKT-071676
gun metal	NKT-351683	gun metal*	NKT-351679
welders black*	NKT-591682	welders black*	NKT-591678



KITCHEN FAUCET / MIXER WITH DUAL SPRAY PULL-OUT

An upgrade kit that turns your Buster + Punch Pull-Out Faucet into a pull-out faucet with dual spray function.

finish: (linear)	sku: (linear)	finish: (cross)	sku: (cross)
steel	NKT-073251	steel	NKT-073247
blond brass	NKT-053250	blond brass	NKT-053246
gun metal	NKT-353248	gun metal	NKT-353252
welders black	NKT-593249	welders black	NKT-593253

*Limited production or discontinued product. Please check availability.



look:

- cast
- linear
- cross

types:

- mixer faucets
- pull-out faucets
- dual spray faucets

finish:

- steel
- blond brass
- gun metal
- welders black

detail:

- rough-cast base
- solid metal

certification:

Compliant with the requirements of:
 ASME A112.18.1-2018/CSA B125.1-18
 NSF/ANSI/CAN 372-2020

FYI: Blond Brass is a lighter brass tone with a timeless but progressive expression. It's elegant and refined with a sense of soft modernity.

DIRECTORY **KITCHEN / SINK ACCESSORIES**



AIR SWITCH KIT

Air Switch made from solid metal, with cast metal detailing to match our Buster + Punch kitchen faucets. Used to activate garbage disposal unit from kitchen sink top via pushbutton switch. Kit includes Air Switch and self-contained plug-in control module with dual outlet adapter.

finish:	sku:
steel	NKT-074058
blond brass	NKT-054057
gun metal	NKT-354059
welders black	NKT-024060



AIR GAP KIT

An Air Gap kit made from solid metal featuring flood level marking. Use it to prevent accidental backflow water contamination. Combine it with our Buster and Punch mixer collection.

Required in some states and municipalities: The air gap sits between the sink and dishwasher. One hose is connected to the dishwasher and the other to the drain. This product prevents backflow contamination from sink to dishwasher, so waste water from the sink cannot enter the dishwasher drain.

Code standard listing: UPC IAPMO PS 23-2019

finish:	sku:
steel	NKT-073263
blond brass	NKT-053262
gun metal	NKT-353264
welders black	NKT-593265



types:

- air switches
- air gaps

finish:

- steel
- blond brass
- gun metal
- welders black

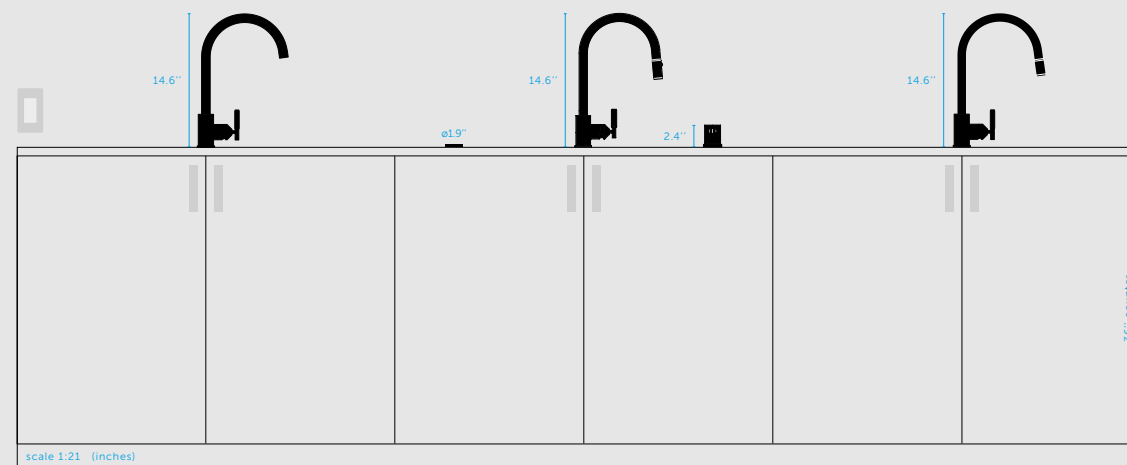

KITCHEN SHELVES

Strength and couture details combine in our collection of statement shelves. Girder + Hanger shelves are crafted from solid, powder coated metal with signature Buster + Punch detailing. Each shelf has its own set of functions to suit your needs, including solid metal guard rails or pan rails to hang utensils. Refined by hand, they are designed to complement our accessories, lighting, and furniture ranges.



DIRECTORY **KITCHEN / SHELVES**

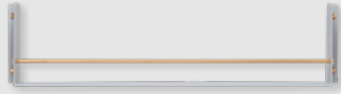

SHELF / GIRDER

finish:	sku:
stone + steel	USV-231920
stone + brass	USV-251919
stone + gun metal	USV-651921
black + steel	USV-041916
black + brass	USV-061915
black + gun metal	USV-531917



SHELF / HANGER

finish:	sku:
stone + steel	USV-231928
stone + brass	USV-251927
stone + gun metal	USV-651929
black + steel	USV-041924
black + brass	USV-061923
black + gun metal	USV-531925

types:

- girder shelves
- hanger shelves

finish:

- steel 
- brass 
- gun metal 
- stone 
- black 

detail:

- coin screws

tech:

- max load 30kg

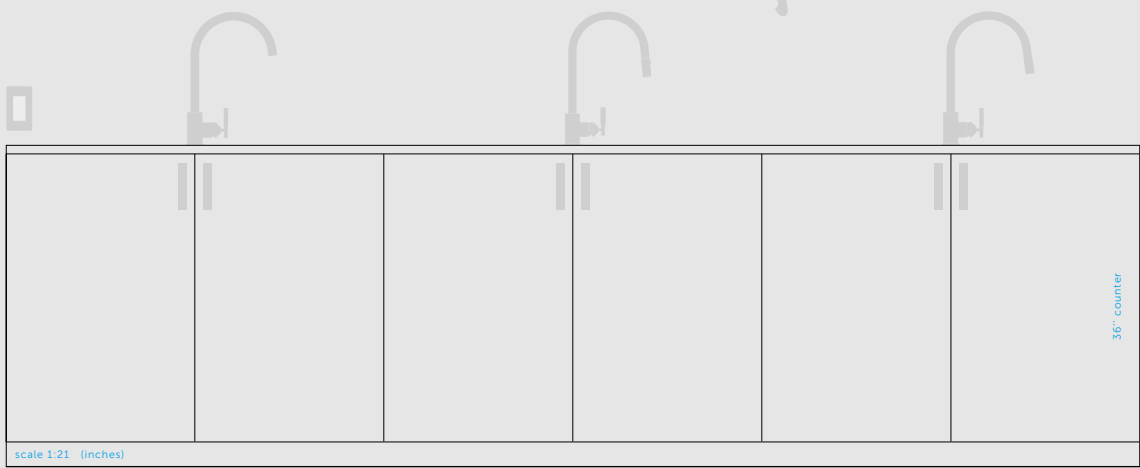
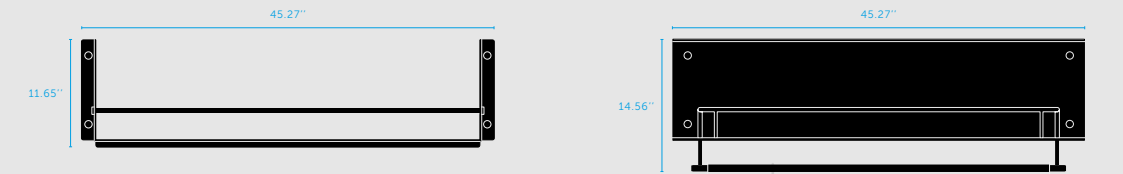

BATHRO

BATHROOM

Hardware, lighting, accessories and lifestyle products to enrich your sanctuary. This is a collection designed specifically to exceed the demands of this space, and crafted in our unique Cast look. It's everything you need to level up bathrooms, wet rooms and spas.



BATHROOM

CAST

Crafted from stainless steel, with a durable EPL or spray lacquer finishes, the entire Cast range is suitable for bathrooms, with a number of bathroom-specific pieces to help you nail your sanctuary's style.

featured:

MIRROR / CAST
SHELF / CAST
SOAP HOLDER / DOUBLE

finish:

BRASS



featured:

TOWEL RAIL / CAST
TOILET ROLL HOLDER / SHELF
PULL BAR / CAST



featured:

CAGED WET / LARGE
HOOK / CAST
FURNITURE KNOB / CAST



SOAP BOTTLE HOLDER / SINGLE / CAST



Fits B+P body care bottles.

finish:	sku:
steel	USP-071304-01
brass	COMING LATE '24
gun metal*	USP-351306-01
welders black	COMING LATE '24

SOAP BOTTLE HOLDER / DOUBLE / CAST



Fits B+P body care bottles.

finish:	sku:
steel	COMING LATE '24
brass	COMING LATE '24
gun metal*	USP-351314-01
welders black	COMING LATE '24

*Limited production or discontinued product. Please check availability.

TOILET ROLL HOLDER / CAST



finish:	sku:
steel	UTA-071288-01
brass	COMING LATE '24
gun metal*	UTA-351290-01
welders black	UTA-481291-01

TOILET ROLL HOLDER / SHELF / CAST



finish:	sku:
steel	UTA-072157-01
brass	COMING LATE '24
gun metal*	UTA-352159-01
welders black	COMING LATE '24

HOOK / CAST



finish:	sku:
steel	COMING LATE '24
brass	COMING LATE '24
welders black	COMING LATE '24

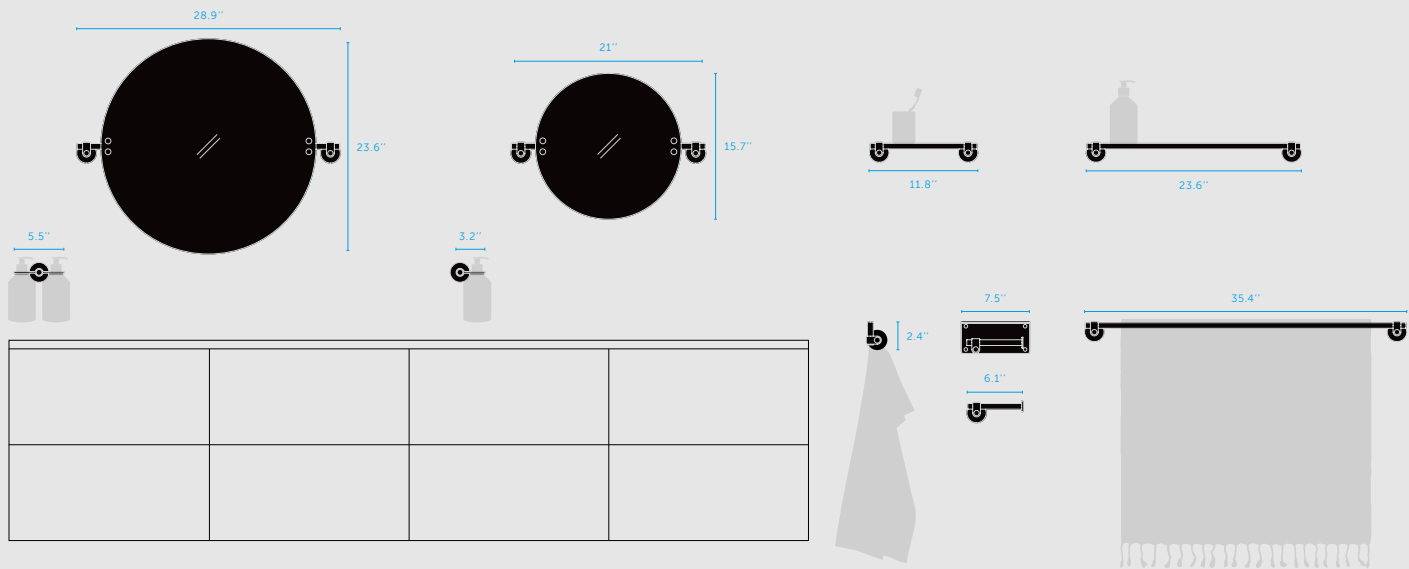

scale 1:21 (inches)



MIRROR / CAST / SMALL

finish:	sku:
steel	COMING LATE '24
brass	COMING LATE '24
welders black	COMING LATE '24



MIRROR / CAST / MEDIUM

finish:	sku:
steel	COMING LATE '24
brass	COMING LATE '24
welders black	COMING LATE '24

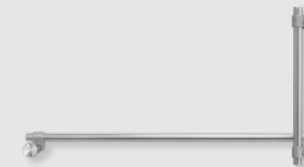

TOWEL RAIL + PULL BAR / CAST

finish:	sku:
steel	UBA-072153-01
brass	COMING LATE '24
gun metal*	UBA-352155-01
welders black	UBA-592156-01



SHELF / CAST

finish:	sku: (small)	sku: (medium)
steel	COMING LATE '24	UBA-071320-01
brass	COMING LATE '24	COMING LATE '24
gun metal*	UMC-352171-01	-
welders black	COMING LATE '24	COMING LATE '24



TOWEL RAIL / CAST

finish:	sku: (small)	sku: (medium)	sku: (large)
steel	UTR-072141-01	UTR-072145-01	UTR-072149-01
brass	COMING LATE '24	COMING LATE '24	COMING LATE '24
gun metal*	UTR-352143-01	-	UTR-352151-01
welders black	COMING LATE '24	COMING LATE '24	UTR-592152-01

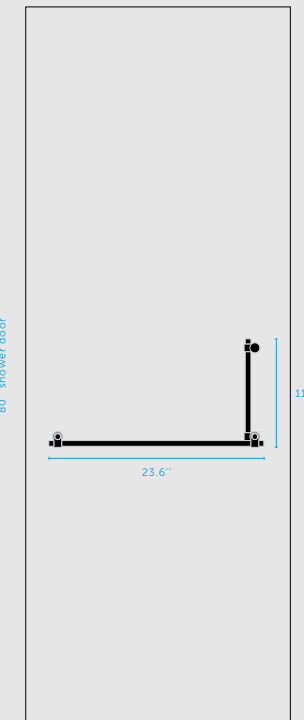

look:
cast

types:
soap bottle holders
toilet roll holders
hooks
mirrors
shelves
towel rails
double-sided pulls

finish:
steel
brass
gun metal
welders black

detail:
rough-cast knuckles
solid metal

BATHROOM
BODY CARE

A collection of invigorating and caring essentials to enhance your everyday rituals. With inspiration ranging from workshop remedies to super-luxe lotions, they're made in England using natural ingredients to elevate daily skin care. Our Body Care range comes in bottles designed to fit our Cast Soap Bottle Holders.



featured:
**SOAP BOTTLE HOLDER / SINGLE
BODY WASH**

finish:
WELDERS BLACK



featured:
**SOAP BOTTLE HOLDER / DOUBLE
HAND WASH + HAND LOTION**

finish:
BRASS



BODY WASH / RUM SILENCER

Fits B+P soap bottle holders.

sku: UAB-562341



BODY WASH / WILD MINT AMPLIFIER

Fits B+P soap bottle holders.

sku: UAB-562342



HAND WASH / VETIVER REPAIR

Fits B+P soap bottle holders.

sku: UAB-562343



HAND LOTION / VETIVER REVIVAL

Fits B+P soap bottle holders.

sku: UAB-562344



scale 1:10 (inches)



SOAP BOTTLE HOLDER / SINGLE / CAST

Fits B+P body care bottles.

finish:	sku:
steel	USP-071304-01
brass	COMING LATE '24
gun metal*	USP-351306-01
welders black	COMING LATE '24



SOAP BOTTLE HOLDER / DOUBLE / CAST

Fits B+P body care bottles.

finish:	sku:
steel	COMING LATE '24
brass	COMING LATE '24
gun metal*	USP-351314-01
welders black	COMING LATE '24

*Limited production or discontinued product. Please check availability.



scale 1:10 (inches)



look:

cast

types:

body care

soap bottle holders

finish:

steel



brass



gun metal



welders black



detail:

rough-cast knuckles

solid metal

ACCESSORIES

ACCESSORIES

Lifestyle pieces, gifts, jewelry and atmospheric details, our accessories are the final piece of the interior puzzle. Made from solid metal, refined by hand and packaged with care and precision.



ACCESSORIES
HOME DECOR

A collection of refined lifestyle and home accessories made from cast or solid metal and featuring our signature diamond-cut knurling. Treat yourself or someone you love to something extraordinary. Each comes presented in a stylish Buster + Punch gift box, for the perfect unboxing experience.



featured:
TEALIGHT CANDLE HOLDER

featured:
BRASS



featured:
SCENTED CANDLE + VESSEL
MACHINED / VASE
MACHINED / CANDELABRA
FORKED



featured:
SCENTED CANDLE
VESSEL



MACHINED VASE

finish: **sku:**

steel* US-MA-VAS-ST-A
brass US-MA-VAS-BR-A



MACHINED CANDELABRA

finish: **sku:**

steel* US-MA-CAN-ST-A
brass US-MA-CAN-BR-A



MACHINED WHISKY

finish: **sku:**

brass* US-MA-WHI-BR-A



MACHINED TRAY

finish: **sku:**

brass US-MA-SIM-BR-A



VESSEL

To fit B+P scented candles.

finish: **sku:**

steel UCH-072958
brass UCH-052959



SCENTED CANDLE

To fit B+P vessels.

product: (220 g)

road to nowhere USC-021822
columbia road flower market USC-021823
campfire tales USC-021824

product: (75 g)

set of 3

sku:

USC-021822
USC-021823
USC-021824

sku:

USC-021825



TEALIGHT CANDLE HOLDER

finish: **sku:** (single) **sku:** (set of 3)

steel NCH-07120
brass NCH-05119* NCH-05121

*Limited production or discontinued product. Please check availability.

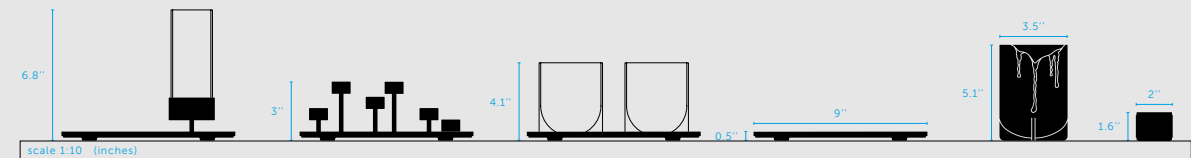

look:

cross

types:

vases

trays

candle holders

scented candles

finish:

steel



brass



ACCESSORIES

JEWELRY

Boasting the iconic Buster + Punch diamond-cut, cross-knurl pattern and featuring the highest quality leathers and metals, our jewelry is guaranteed to impress. Presented in a stylish Buster + Punch gift box, with a chic velvet pouch.



featured:
NECKLACE



featured:
CUFFLINKS

finish:
STEEL



featured:
BRACELET

finish:
BRASS

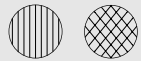

ACCESSORIES

PETS

Designed to let your four legged friend stand out from the pack, our pet accessories feature our hallmark attention to detail, soft durable leathers, and precisely engineered solid metals.

featured:

DOG COLLAR
DOG LEASH

finish:

BLACK LEATHER + STEEL



featured:

DOG BOWL

finish:

BRASS

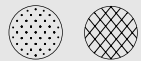

DIRECTORY **ACCESSORIES / JEWELRY**



CUFFLINKS

finish: steel
brass

sku: US-CUF1-ST-A
US-CUF1-BR-A



DOUBLE BRACELET*

finish: brass*
black*

sku: (14.2") US-B1-D-14.17-BR-A
-

sku: (16.5") US-B1-D-16.54-BR-A
US-B1-D-16.54-BL-A

sku: (17.7") -
US-B1-D-17.72-BL-A



NECKLACE / CROSS

finish: steel
brass
black

sku: US-NL-V-ST-A
US-NL-V-BR-A
US-NL-V-BL-A



NECKLACE / LINEAR

finish: burnt steel

sku: NNE-36528

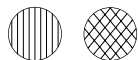

look:

linear
cross

types:

cufflinks
bracelets
necklaces

finish:

steel 

burnt steel 

brass 

black 

*Limited production or discontinued product. Please check availability.

DIRECTORY **ACCESSORIES / PETS**



DOG COLLAR

finish: black leather + steel
black leather + brass

sku: (x-small)	sku: (small)	sku: (medium)	sku: (large)	sku: (x-large)
NPA-02782	NPA-02784	NPA-02786	NPA-02788	NPA-02790
NPA-02781	NPA-02783	NPA-02785	NPA-02787	NPA-02789



DOG LEASH

finish: black leather + steel
black leather + brass

sku: (0.6")	sku: (1")
NPA-02792	NPA-02794
NPA-02791	NPA-02793



DOG BOWL

finish: brass
gun metal

sku: (small)	sku: (large)
UDB-051563	UDB-051565
UDB-351562	UDB-351564

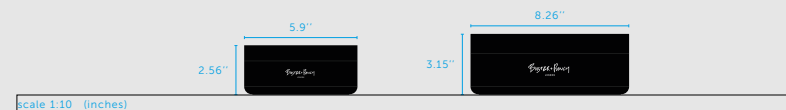

look:

cross
cast

types:

dog collars
dog leashes
dog bowls

finish:

steel 

brass 

gun metal 

black leather 

black 

FURNITURE

FURNITURE

Bespoke bars, handmade in England and the lounge chair fifty years in the making. Buster + Punch furniture is made to last, in premium materials selected with care and finished with our exacting attention to detail.



FURNITURE

POPSTAR + ROCKSTAR

A collection of handmade, bespoke bars made from American Walnut, black or natural solid oak. Our bars are crafted to be the star of any room and are finished with our signature coin screws, solid metal cabinet hardware and a diamond-etched logo plate. Rockstar and Popstar bars are designed to complement our furniture and home accessories ranges.



featured:

POPSTAR BAR

finish:

BLACK OAK



featured:

ROCKSTAR BAR

finish:

AMERICAN WALNUT



FURNITURE
CHOPPER CHAIR

A lounge chair with an iconic 70s silhouette, wide-gauge tubular steel frame, and a removable full-grain black leather seat and backrest. Chopper is designed for flat-packed shipping, and its frame is finished in deep black chrome with B+P brass logo caps. Dial in its comfort simply by adjusting the buckled straps underneath its seat. Durable, stackable and easy to place within your interior.



featured:
CHOPPER CHAIR

finish:
BLACK CHROME + BLACK LEATHER



DIRECTORY **FURNITURE / BARS**



THE POPSTAR BAR

finish: natural oak
black oak

sku: US-PS-OAK-ST-WM-BL-A
US-PS-BL-SM-BM-GBS-A



THE ROCKSTAR BAR

finish: american walnut

sku: US-RS-WA-BR-GBS-A



knurl:

cross

types:

bars

finish details:

natural oak 

american walnut 

black oak 

detail:

coin screw

light fitting

solid metal hardware

quilted back panel

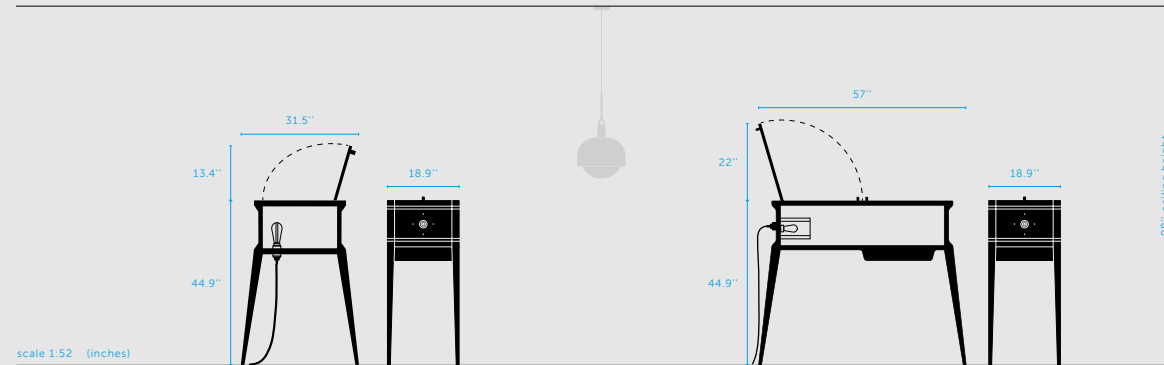

DIRECTORY **FURNITURE / CHOPPER CHAIR**



THE CHOPPER CHAIR

finish: black chrome + black leather

sku: UCC-933535

types:

lounge chair

finish:

black chrome 

black leather 

detail:

full-grain leather

brass logo screws

features:

stackable

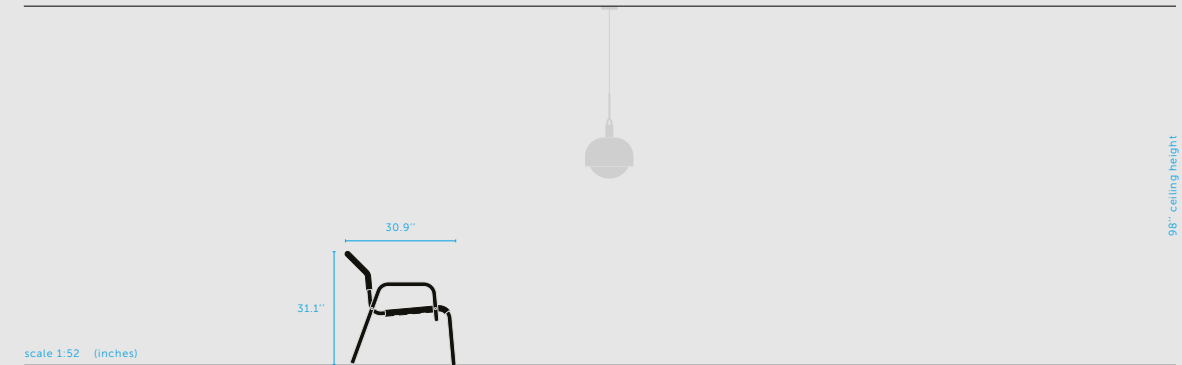

COLLABORATIONS

COLLABORATIONS

Unique collaborations with brands and individuals who share our passion for shattering boundaries and exploring subcultures. Conceptual, subversive journeys, with compelling results that inspire conversations.



COLLABORATION
STAUB

Buster + Punch meets Staub in a coming together of iconic emblems and traditions. The collaboration comprises of an elevated Staub Cocotte and frying pan, in black cast iron with embossed Buster + Punch insignia. To elevate the pieces, each boasts bespoke Buster + Punch handles in solid metal, featuring our signature precision knurling.





COCOTTE / 24

24 cm / 9.4 inch diameter cast iron cocotte.

finish:	sku:
steel handle	UKA-044234
brass handle	UKA-064233



COCOTTE / 28

28 cm / 11 inch diameter cast iron cocotte.

finish:	sku:
steel handle	UKA-044237
brass handle	UKA-064236



FRYING PAN

28 cm / 11 inch diameter cast iron frying pan.

finish:	sku:
steel handle	UKA-044239
brass handle	UKA-064238



KITCHEN TOWEL

sku:
UKA-014240

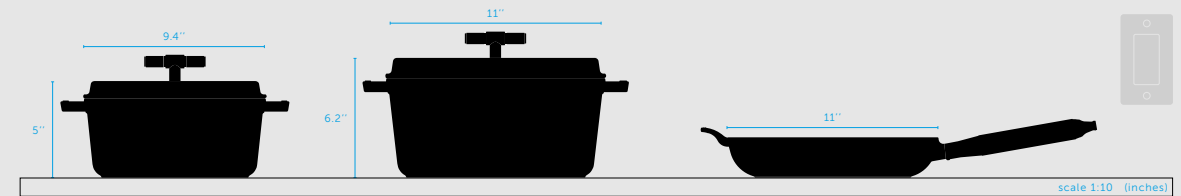

look:

cross

types:

cocottes

frying pans

handles

finish:

steel

brass

detail:

knurled handle

ABOUT FINISHES

We make all of our products from the same solid metal finishes - steel, brass, gun metal, smoked bronze, black, welders black and on special occasions, burnt steel. This makes it super easy to match all your home details from light pendants to light switches, kitchen pulls to door handles.



DIRECTORY FINISHES

Check availability for limited inventory or discontinued products.

BURNT STEEL

Solid stainless steel exposed to excessive heat and finished with a protective PVD coating to create our unique, durable, burnt steel finish. Check availability for limited inventory or discontinued products.



STEEL

Made from solid stainless steel and refined by hand, this is our most durable finish. It will maintain its crisp appearance for many years, from the moment you take it out of the box.



GUN METAL

Gun Metal is made from solid stainless steel which is then finished in gun metal PVD. This is an exceptionally durable process, and it will retain its elegance and soft lustre for many years. For the Cast range, a stainless steel base is used, finished with a durable gun metal EPL coating to make it waterproof.



FYI In some cases other metal, coating and lacquer combinations may be used, if better suited to a specific function or product. I.e. Taps are made from a brass base finished with either nickel plating, baked on paint coating or PVD coating and in some cases Door Hardware is finished with a more durable PVD.



WELDERS BLACK

Solid stainless steel with a durable PVD coating technique, to create a soft and subtle, charcoal-black finish. For the Cast range, a stainless steel base is used, finished in a durable Welders Black EPL coating making it waterproof.

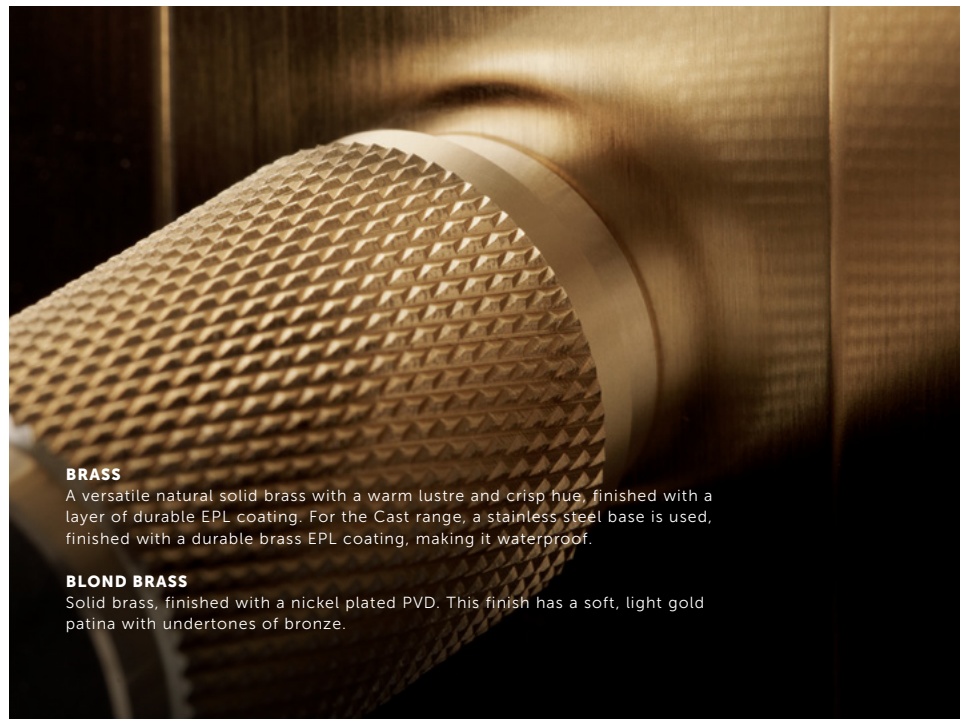

BRASS

A versatile natural solid brass with a warm lustre and crisp hue, finished with a layer of durable EPL coating. For the Cast range, a stainless steel base is used, finished with a durable brass EPL coating, making it waterproof.

BLOND BRASS

Solid brass, finished with a nickel plated PVD. This finish has a soft, light gold patina with undertones of bronze.



SMOKED BRONZE

Solid brass, hand finished with a special oxidising formula, and finally heated to give a beautiful dark bronze appearance. Finished with a durable, EPL coating.



BLACK

Machined from aluminium and then anodised for a very consistent, hard wearing, deep black finish with a satin sheen. Electricity plates are solid metal and finished in a durable matt black EPL coating.

DETAILS FOR LIFE

LOOKING BACK AT WHERE WE BEGAN, I AM PROUD THAT WE WERE THE FIRST TO GIVE FUNCTIONAL HOME FITTINGS A NEW LEASE OF LIFE.

Through our passion for metals, our originality, unique perspective, and approach we have carved out new paths in interiors for a decade. These collections of details and how they integrate seamlessly are what I searched endlessly for when I was working as an architect. And now, everyone can use Buster + Punch's details seamlessly to lay the groundwork for creating elevated, refined spaces.

When I enter an interior, my focus always falls on the things we touch multiple times a day and reveal the actual quality of the space. This is why we work with solid metal; its distinctive temperature and weight resonate when interacting with it.

Details like light switches and door handles used to be an afterthought, bought by a builder in soulless DIY stores. My mission at Buster + Punch is to change how these forgotten details look and how you feel about them emotionally. Good detailing brings you closer to the built environment around you.

We are metal makers first and foremost. We urge you to pick up the products and experience them in the metal because you'll connect with them 20 or 30 times daily. Think of Buster + Punch as the part of your home that shakes hands with your friends when they come in.

As a brand, we pledge to be more responsible and ensure our products remain meaningful and unique. We'll stay analogue and tactile while looking forward – melding tradition with technology to shape new chapters. Pushing industry boundaries and drawing inspiration from our city's subcultures, we promise to prioritise our people and community, placing you at the center of our world.

MASSIMO BUSTER MINALE
Founder and Creative Director



BUSTER + PUNCH / NORTH AMERICA

2 Westchester Park Drive, Suite 200
White Plains NY 10604
United States
+1 (818) 392-3827

BUSTER + PUNCH / UK

Sand Martin House, Bittern Way
Peterborough, PE2 8TY
United Kingdom
+44 (0)20 7407 0888

BUSTER + PUNCH / LONDON SHOWROOM

47-49 Charlotte Road, Shoreditch
London, EC2A 3QT
United Kingdom
info@busterandpunch.com

BUSTER + PUNCH / STOCKHOLM

Artillerigatan 25
114 45 Stockholm
Sweden
+46 (0)8 588 395 50

PRESS ENQUIRIES

press@busterandpunch.us

SALES ENQUIRIES

sales@busterandpunch.us

INFORMATION

info@busterandpunch.com

FOLLOW US

Instagram: @busterandpunch
Facebook: busterandpunch
TikTok: @busterandpunch

BUSTERANDPUNCH.COM

SKU: NBR-024430
UPC: 5060941217115
Version number: BR02

Buster + Punch, Buster + Punch logo, B+P logo and [end. ORDINARY.]
Slogan are registered trademarks of Buster and Punch limited.

