

RIFT ZONE EL



TECHNICAL MANUAL

TABLE OF CONTENTS

Important Information	2	Frame Technical Specifications	7
Adjusting the Headtube Angle	3	Bosch Technical Specifications	9
Battery Removal and Installation	4	Marin Customer Support	10
Cable Routing & Rubber Grommets	5		

IMPORTANT INFORMATION

This document is intended to supplement the complete owner's manual. This document contains an overview of some parts diagrams, specifications, and adjustment instructions. This document is NOT a complete owner's manual and does not include important safety and installation information. You must refer to the complete owner's manual and get help from your official Marin dealer with assembly, use, service, and maintenance. Visit marinbikes.com/support for more information.

Failure to follow proper assembly instructions, hazard warnings, and compatible part recommendations may result in loss of control while riding and can lead to serious injury and/or death. We recommend having your bike assembled, adjusted, and serviced by a trained, professional bicycle mechanic. This manual is not intended to replace the assembly and service instructions provided by third-party component manufacturers.

ADJUSTING THE HEADTUBE ANGLE

The Rift Zone EL bike features an adjustable headtube angle which can be changed by swapping the upper headset cup. The factory setting is the ZERO offset cup and is set to 65 degrees. Steeper headtube angle (+0.5) offers increased agility for climbing and tighter/flatter trails, and a slacker headtube angle (-0.5) offers increased stability for descending. To change the headtube angle by +/- 0.5 (65.5 or 64.5) degrees, follow the steps below.

1. Use a 4 mm hex wrench to remove the stem bolts. Use a 5 mm hex wrench to remove the top cap bolt. Remove the stem, spacers, top cap, and upper bearing. Remove the ZERO upper headset cup.
2. Note the laser etched -0.5 and +0.5. The marking that is pointing to the front of the bike indicates the headtube angle adjustment.
3. Select and install your preferred upper headset cup.
4. Reinstall the other headset parts in the correct order and tighten the headset compression bolt (4-5 N•m) and then align the stem and tighten the stem bolts to 5-6 N•m (see stem for exact torque recommendations). Make sure the assembly is aligned and all parts are in place. Check the headset for play. If play exists, do not ride the bicycle and contact your local Marin dealer.

1

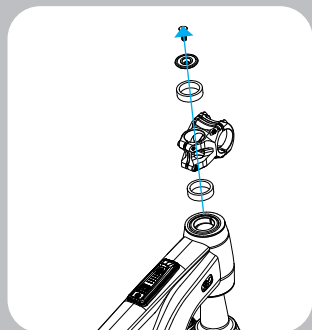

2

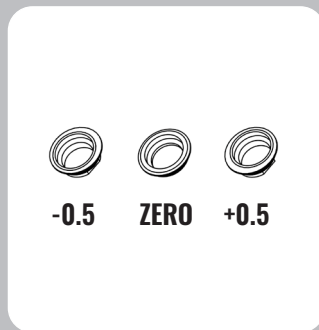

3

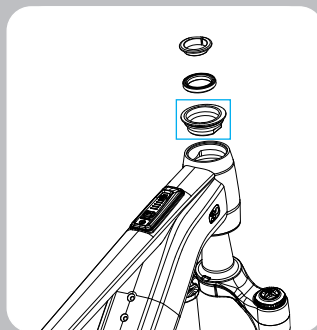

4

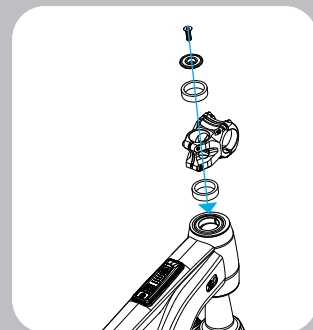

BATTERY REMOVAL & INSTALLATION

The battery can be charged on the bike without removal. However, you may need to bring the battery indoors to charge without the bike, or for storage during cold months. Battery removal and installation can be done with the bike on its side, or upside down. When turning the bike upside down, lower the seat and be very careful not to damage the mini-remote on the handlebar. You may wish to loosen the mini-remote bolt slightly and rotate it out of the way. You can also use blocks under the handlebars in order to create space for the mini-remote to not contact the ground.

1. Use a 3 mm hex wrench to remove the bolt from the downtube cover. Pull down on the downtube cover to release it from the bike.
2. Remove the rubber release cover on the bottom of the DT.
3. Use a 3mm or 4mm allen key and insert it into the battery release hole until you hear a click, the battery is now ready to remove.
4. Pull the battery out using the pull tab.
5. To install the battery slide the battery back into the tube so that the locking tower is facing forward, when pushing the battery into it's locking position ensure the lower locating tabs correctly interface with the mounting rail in the frame.

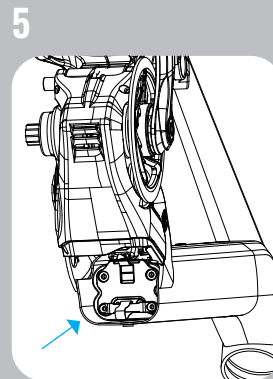
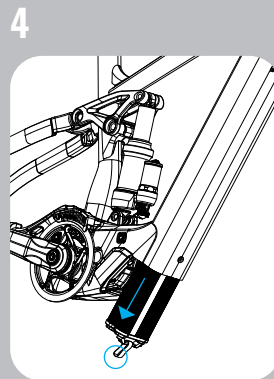
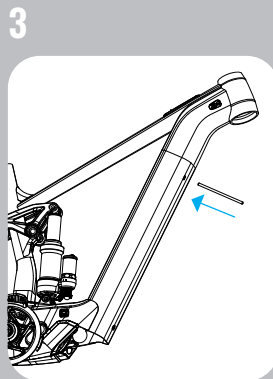
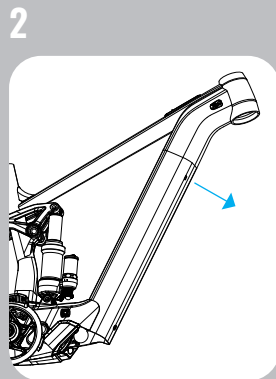
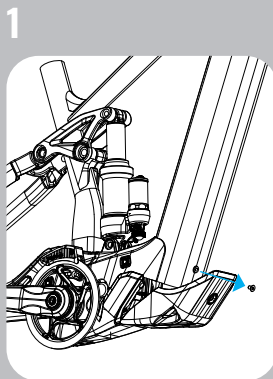

CABLE ROUTING & RUBBER GROMMETS

All cables and housing travel through Marin's Series 4 grommets, which are sealed with a rubber membrane to keep out the elements. On the next page is a diagram to help guide you on how the routing is designed through the frame. We recommend only trained, professional bicycle mechanics complete this installation.

1. Drive side grommets: 4 mm/dropper or shifting cable port (Figure 1A), 5 mm/brake line port (Figure 1B).
2. Non-drive side grommets: 4 mm/dropper or shifting cable port (Figure 2A and Figure 2B), display or light cable (Figure 2A), 5 mm/brake line port (Figure 2D).
3. The rubber gasket keeps things rattle-free and protects the frame.

1

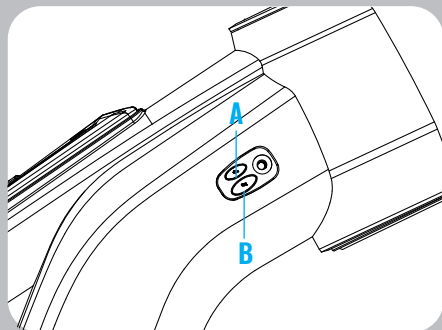

2

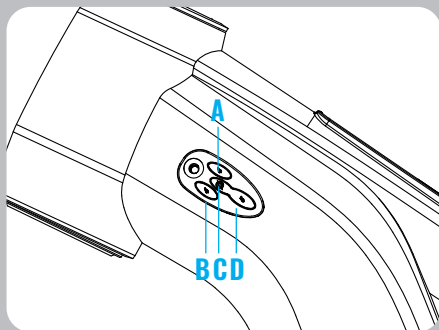

3

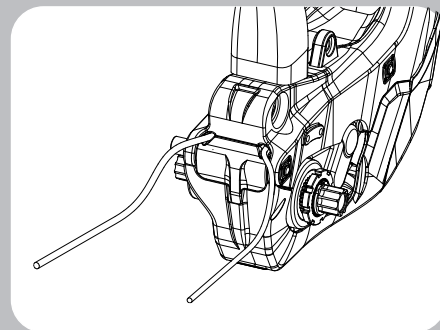

INTERNAL CABLE ROUTING

-  DROPPER
-  REAR BRAKE
-  REAR DERAILLEUR
-  CHARGER
-  CONTROLLER
-  BATTERY

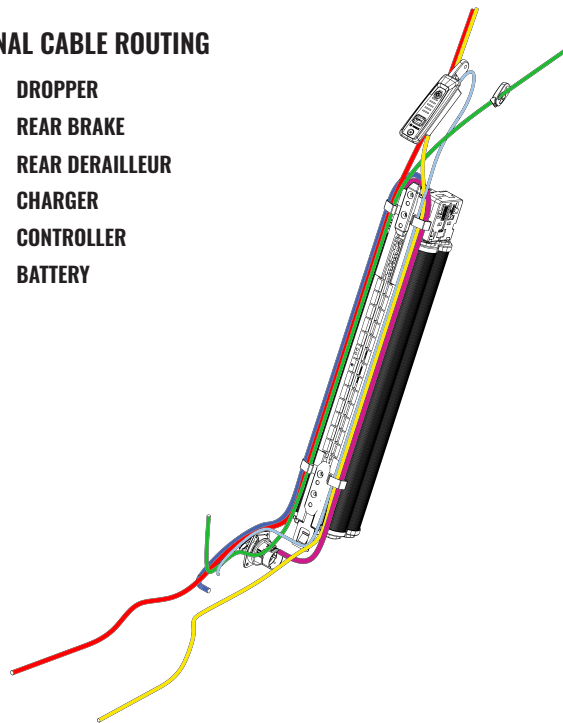

FRAME TECHNICAL SPECIFICATIONS

FORK AXLE TO CROWN

OE Specification 561 mm

MAX 571 mm

*NOT dual crown compatible

SHOCK INFO

Eye to Eye 210 mm

Stroke 55 mm

SHOCK HARDWARE

Upper 25 mm x M8

Lower 25 mm x M8

REAR WHEEL TRAVEL

140 mm

TIRE COMPATIBILITY

Front 29x2.6" MAX TIRE

Rear 29x2.6" MAX TIRE

FORK AXLE TO CROWN

Top Bearing Custom Marin Adjustable Headset

Bottom Bearing

CHAINLINE

52-55mm

SEAT COLLAR DIAMETER

38.9 mm

REAR BRAKE MOUNT

Post Mount 160 mm

REAR AXLE

Taper Head, 148x12mm

174mm LTG, 1.0 Pitch

BEARING SPECIFICATION

6902RS - 2

69012RS - 4

JFM-1214-05 - 2

QUANTITY

SEATPOST DIAMETER

34.9 mm

SEAT TUBE INSERTION DEPTH

S 220 mm

M 240 mm

L 250 mm

XL 280 mm

BOSCH E PARTS

Speed Sensor Rim Type

Motor Mount Performance Line SX, Housing Variant 2, Wide Option

Battery Compatibility Compat Tube 400 Horizontal

Battery Mount Axial Type, CPT 400 Horizontal, Pin Release

Charge Port COBS

Power Switch BRC3100 Top Tube Controller

Assist Mode Switch Bosch Mini-Remote

Other Compatible Parts Power More 250

Other Compatible Parts Anit-Theft Module

Power More 250 Cable EB12.120.036, Cable PowerMore 150mm

FRAME TECHNICAL SPECIFICATIONS

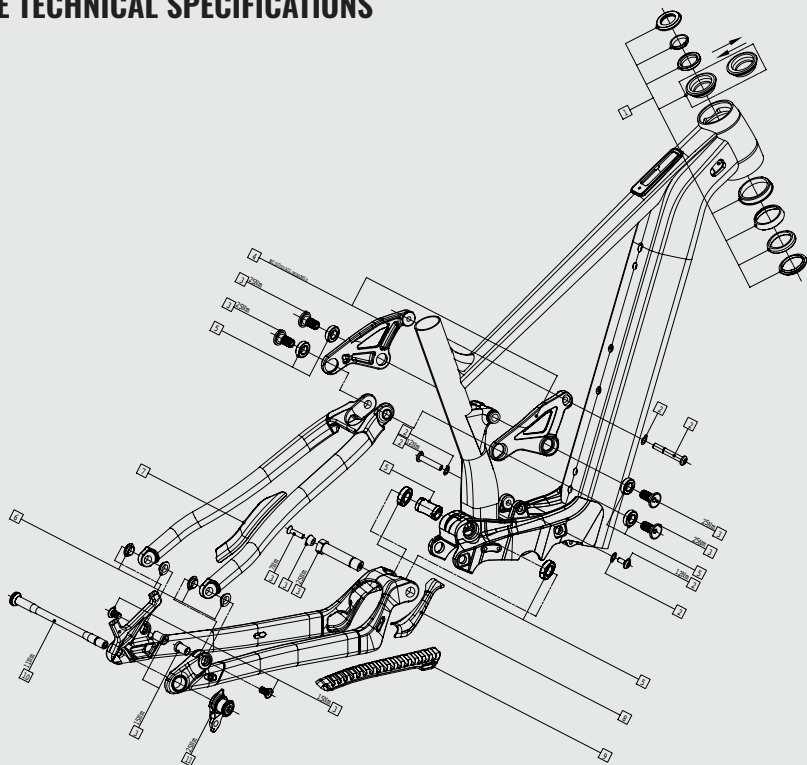

ITEM #	ARTICLE #	DESCRIPTION
1	738409	Adjustable Headset Assembly
2	739306	Shock Bolt Kit J
3	739307	Pivot Bolt Kit K
4	739314	Rocker Link Rift Zone EL
5	739723	Bearing Kit
6	726910	J-3 IGUS Plane Bearing Kit, QTY - 4
7	736028	Rift Zone V3 SS Protector, VLF-C-1484
8	739724	C/S Yoke Cover Rift Zone E Light
9	736027	Rift Zone V3 Ss Protector, VLF-C-1484
10	736031	148x12 Bolt On Axle, 174mm Length, Tapered Head
11	AC-DRHG-MTB-A1	SRAM UDH

BOSCH TECHNICAL SPECIFICATIONS

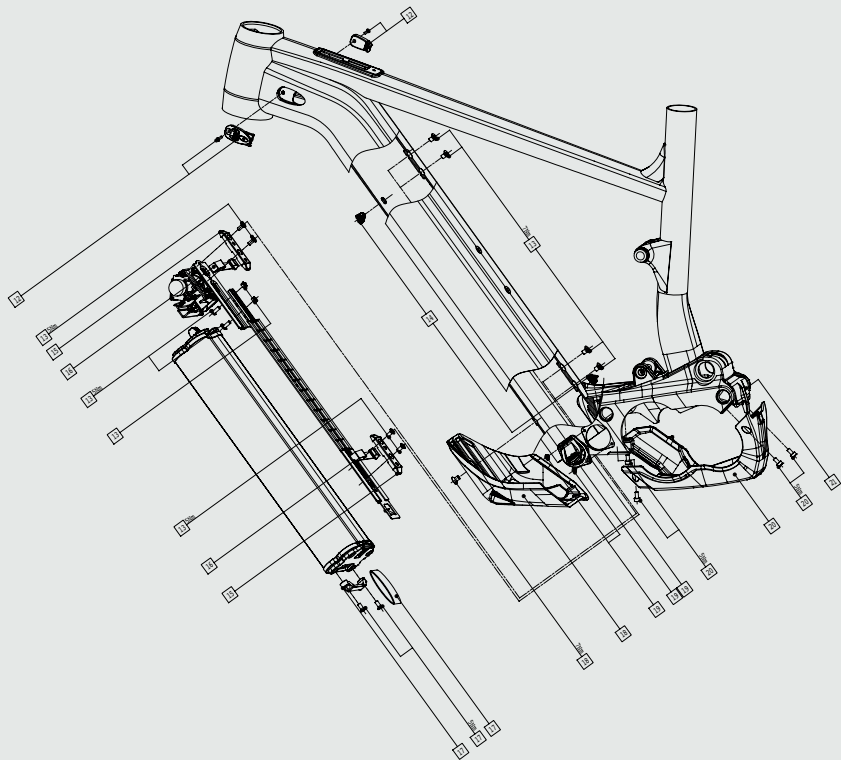

ITEM #	ARTICLE #	DESCRIPTION
12	738410	Series 4 Cable Grommet Kit, both side w/bolts
13	739311	Battery Rail Bolt Kit with Bolts
14	739313	Square Hole Plug Kit, 2pcs
15	739308	Bosch Battery Adapter Rail, x2 pcs
16	739309	Cable Retention Clips for Bosch Battery Rail, x2 pcs
17	739310	Marin Battery Handle with Strap, bolts included
18	739304	Battery Release Cover, include bolt
19	739312	Charge Port w/ Rubber Cover & Bolts
20	739303	Drive Unit Cover, include bolt
21	739305	Rear Drive Unit Gasket

MARIN CUSTOMER SUPPORT

Your local Marin dealer is your best resource for service and repairs, but if you need to contact us directly, visit marinbikes.com/about/contact-us

Warranty

Visit marinbikes.com/support