

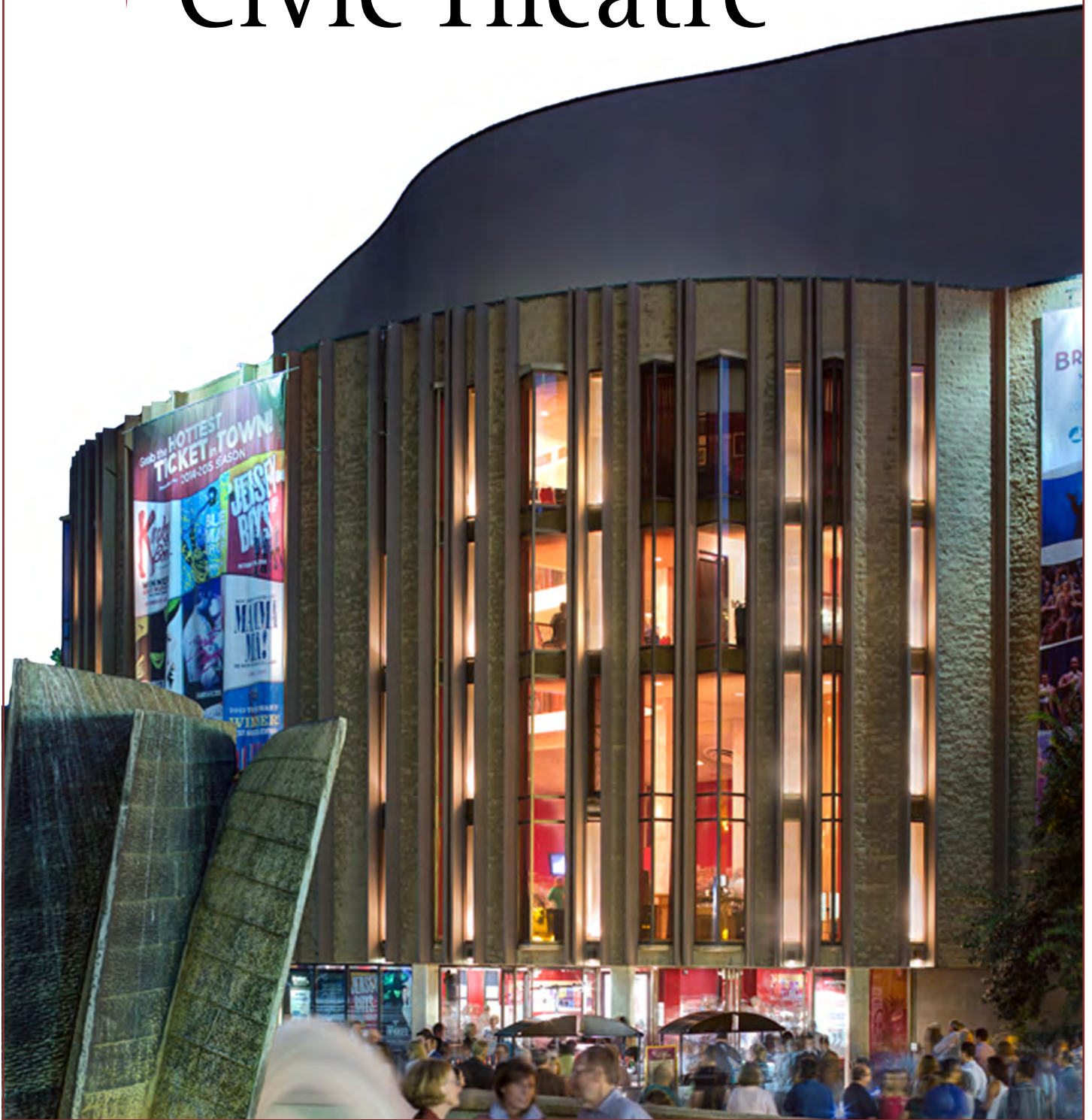

# San Diego Civic Theatre



PRODUCTION INFORMATION

This information is provided to assist you in planning an event in the San Diego Civic Theatre. Should additional information be required, please feel free to contact us for prompt attention. Larger scale versions of the drawings included here are also available.

San Diego Theatres welcomes the opportunity to work with you and to make your event a success.

**GENERAL ACCESS**

Administration & Booking . . . . .(619) 615-4000  
 Event & Patron Services . . . . .(619) 615-4003  
 Primary FAX . . . . .(619) 615-4001  
 Civic Theatre Website . . . . .www.sdcivic.org

Ticket Sales & Information . . . . .(619) 570-1100

**Ticketing Services**

Management . . . . .(619) 615-4170  
 Ticketing Services FAX . . . . .(619) 615-4175

**Production & Facility Services**

Management . . . . .(619) 615-4150  
 Production FAX . . . . .(619) 615-4155

Theatre Location . . . . .Third Avenue and “B” Street  
 San Diego, CA 92101

Theatre Ticket Office . . . . .Third Avenue and “B” Street  
 Civic Theatre Ticketing  
 1100 Third Avenue  
 San Diego, CA 92101

Administration and . . . . .San Diego Theatres  
 Mailing Address . . . . .1100 Third Avenue  
 San Diego, CA 92101

Stage Door and . . . . .Third Avenue and “C” Street  
 Loading Dock

**GENERAL INFORMATION**

The Civic Theatre is a 2,967 capacity performing arts venue located in downtown San Diego. It is the performing home of the San Diego Opera, Broadway/San Diego and regularly hosts performances of the California Ballet, touring orchestras and dance companies, Broadway musicals and plays, concerts, film presentations, lectures, etc. The Theatre is owned by the City of San Diego and operated by San Diego Theatres for the benefit of the community.

An 1,150 car parking garage is located across the plaza adjacent to the Civic Theatre.

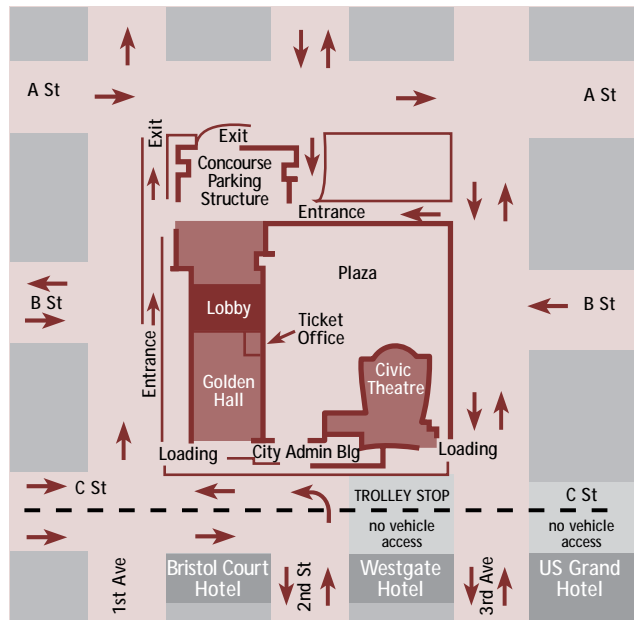
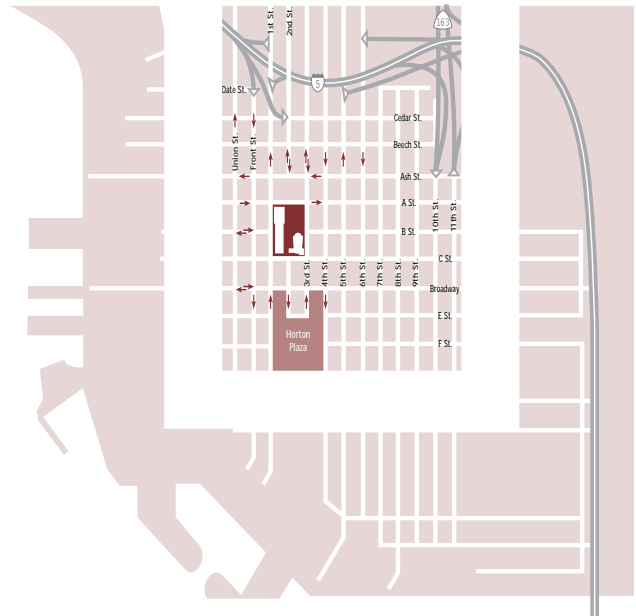

**PRODUCTION INFORMATION**

Production crews are members of IATSE, Local #122

**Proscenium Opening**

Height ..... 29'-6"  
 Width..... 56'-0"

**Selected Measurements**

Proscenium to Up-Stage Wall (up/down stage) . . . 55'-3"  
 Curtain Line to Apron Edge..... 6'-0"  
 Last set of lines to Back Wall ..... 9'-0"  
 Floor to Grid ..... 81'-0"  
 Stage at Curtain Line to Balcony Rail..... 93'-7"  
 Stage at Curtain Line to Follow Spot Booth . . . . 151'-0"

The Stage is constructed of soft wood covered with 1/4" masonite. The performance area is painted black. The standard Orchestra Pit accommodates approximately 45 musicians and the Extended Pit accommodates about 60 musicians. Exact capacity will vary depending on the quantity and types of instrumentation utilized. Use of the Standard Pit will reduce audience seating capacity by 55, the Extended Pit reduces capacity by 90 seats.

The loading dock is at street level and will hold two (2) semis. Because the vehicle area slopes down to the dock, trailers over 13'-6 high will have difficulty clearing the outer door, especially when empty.

Empty trailers are to be removed from the dock. Please contact the Production Office if holding/staging areas are needed.

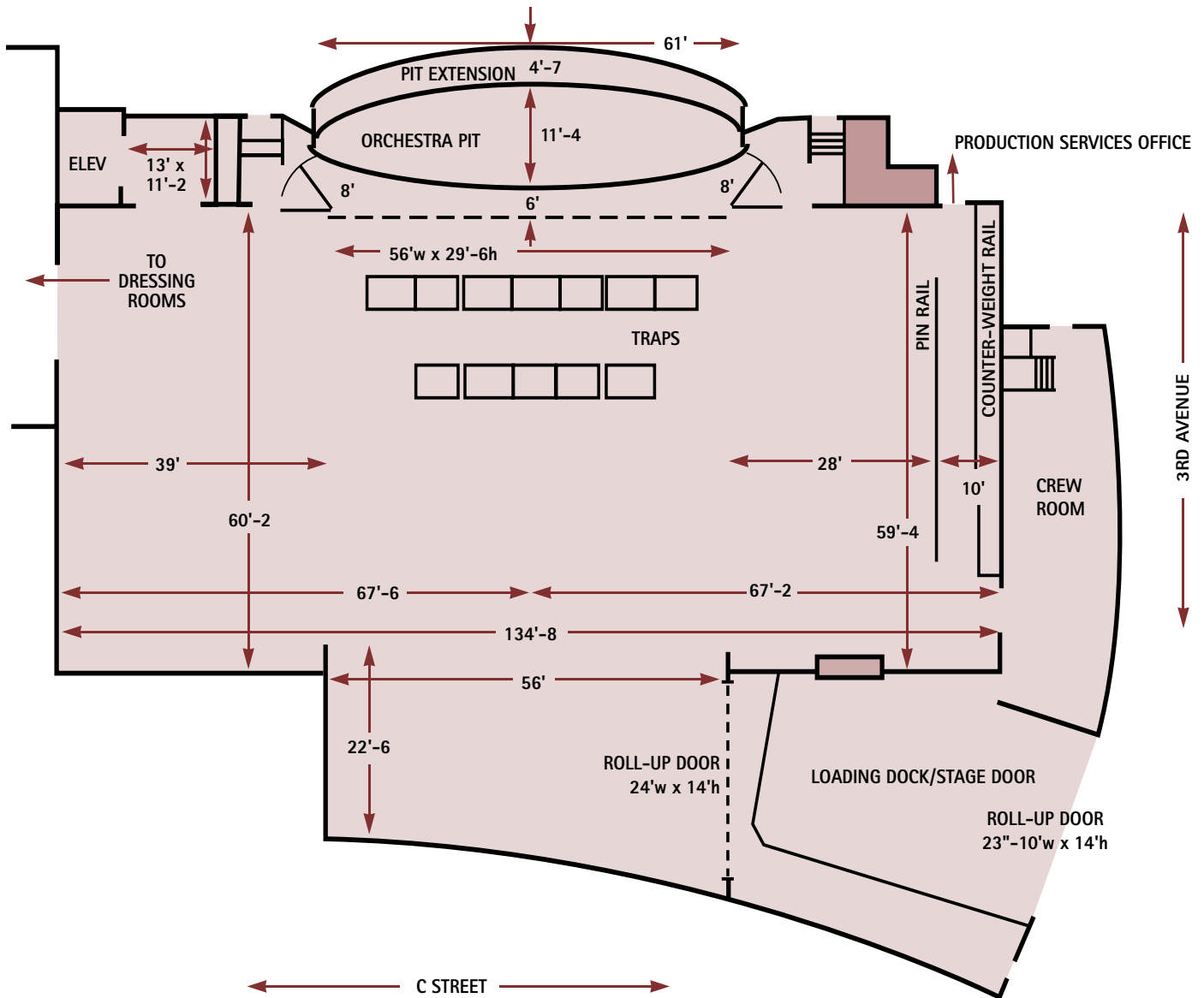

## COUNTER-WEIGHT PLOT

SET		ITEM		LOCATION	
Fire Curtain/Proscenium	0' 4"	24	17' 2"	47	32' 4"
1 Teaser	1' 2"	25	17' 9"	48 #4 Black Border	32' 10"
2 Tormentor	1' 10"	26 Blackout Drop	18' 5"	49 #4 Black Leg	33' 5"
3 House Curtain	2' 7"	26a Wire Guide*	19' 9"	50 #4 Electric	34' 1"
4	3' 2"	27 NO SET		51	35' 2"
5	3' 10"	28 NO SET		52	35' 9"
6 #1 Electric	4' 6"	29	20' 5"	53 Stage- Right Ladders	Muled
7	5' 1"	30	21' 1"	54	36' 10"
8	5' 10"	31	21' 9"	55 Stage- Left Ladders	Muled
9 #1 Black Border	6' 6"	32	22' 4"	56	38' 2"
10 #1 Black Leg	7' 2"	33 #3 Black Border	23' 2"	57	NO SET
11	7' 10"	34 #3 Black Leg	23' 8"	58	NO SET
12	9' 1"	35 #3 Electric	24' 4"	59 #5 Black Border	39' 7"
13	9' 9"	36	25' 2"	60	40' 3"
14	10' 5"	37	25' 8"	61 #5 Black Legs	40' 11"
15	11' 1"	38	26' 4"	62 #5 Electric	41' 7"
16	11' 9"	39	27' 2"	63	43' 4"
17	12' 5"	40	27' 8"	64 Blackout Drop	44' 2"
18	13' 1"	41	28' 4"	65	44' 8"
19 #2 Black Border	13' 9"	42	28' 10"	66	45' 4"
20 #2 Black Leg	14' 5"	43	29' 8"	67	46' 2"
21 #2 Electric	15' 2"	44	30' 4"	67a Wire GuideSet	48' 2"
22	15' 9"	45	31' 2"	68 House Cyc	49' 5"
23	16' 5"	46	31' 8"	68a Wire Guide Set	50' 6"

Generally, most linesets have a 1600# capacity – check with house before using.

There are 64 sets of counter-weighted lines on steel guides, and three sets on wire rope guides. All sets are on 8" centers where possible. All sets can be cleared and flown to the grid to a minimum of 65'.

\*Wire Guide sets cannot be loaded from bridge. Must be loaded from deck. Each has a 400# capacity.

The battens are 70' long and are of pipe truss construction.

The Front Curtain is manually operated and can be either flown or drawn. Front Curtain and associated tormentors and teaser are red in color. Other house goods are black. Standard House Opening is 52' for the Torms, 44' for all Black goods.

Fly Floor is Stage-Right on Deck. #1 Loading Bridge is 45' above stage and #2 is 70'. Grid Height is 81'. Pin Rail is Stage-Right on Deck.

Proscenium is 56' w x 29'6" h

Note: Stage-Right and Stage-Left side tabs are hung off stage of side ladders.



Civic Theatre Loading Dock  
Third Ave. and C St.



## CIVIC THEATRE CROSS SECTION

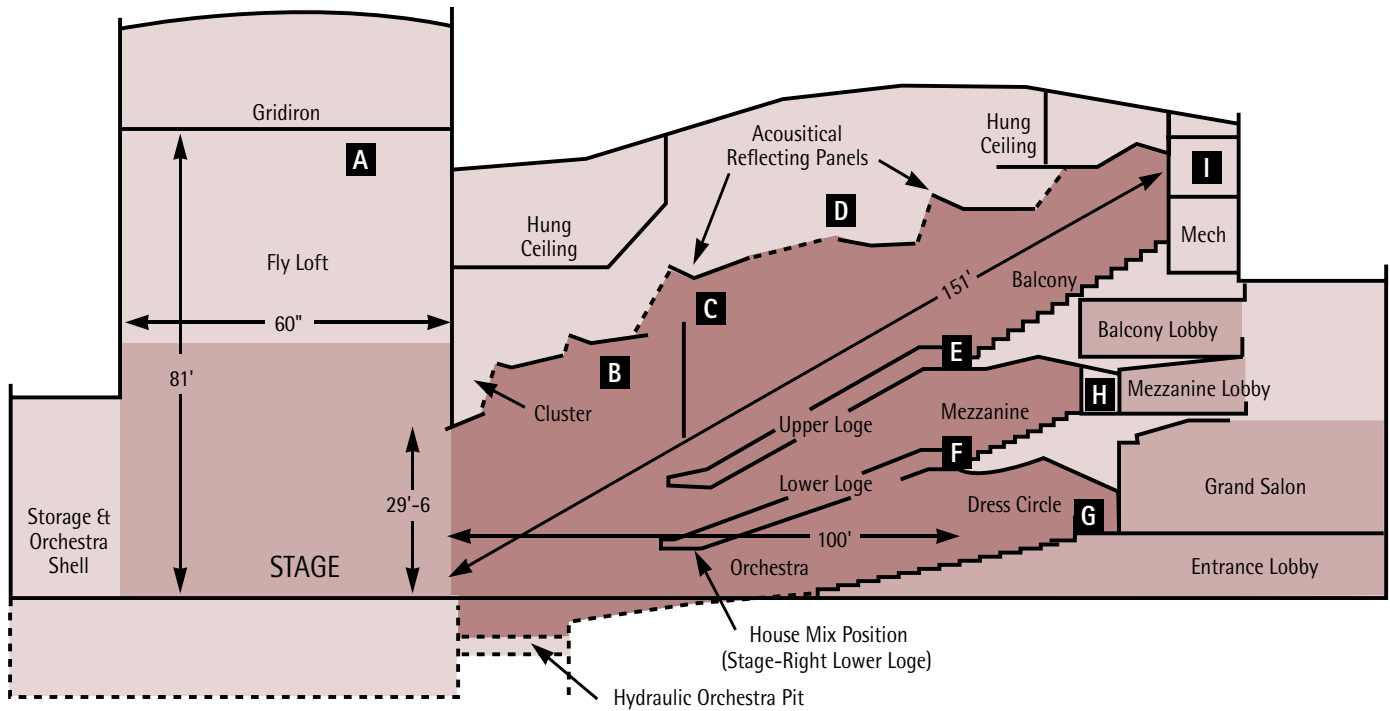

### CROSS SECTION

- A** Over stage grid
- B** Near Box Boom - 28' to curtain line
- C** Far Box Boom - 48' to curtain line
- D** High Bay - 96' from curtain line
- E** Balcony Rail - 94' from curtain line
- F** Mezzanine Rail - 86' to curtain line
- G** Road mix position
- H** House Lighting Control Booth
- I** Follow Spot Booth - 151' to curtain line



### SOUND SYSTEMS

The house speaker system is a 4-way JBL cluster centered overhead of the proscenium with added delay systems for loge and balcony coverage. Touring productions are urged to use the system to provide general house fill as it has been balanced for the hall. Stage mounted systems will generally not provide adequate coverage for the balcony areas. The house sound console is an Allen&Heath DLiveS7000, 32-channel mixer located at the front of the stage-right lower loge.

For road systems, a mix position is available for use at the rear of the Dress Circle, just off-center to stage right, so a minimum of 250' of cable must be provided by the sound company. Use of this location typically results in a loss of 27 seats. The number of seats lost also depends on the equipment and working requirements of the operator(s)–

seat “kills” may range from 27 to 41 or more seats. The labor costs associated with the removal and re-installation of mixer seats or any other seats are assessed to the user/ licensee.

Stage Manager’s position is traditionally Stage-Right with communications available to all positions in the Theatre.

Program material and backstage paging are available in the dressing rooms and backstage area.

This Theatre is equipped with a Sound Associates infra-red listening system to assist the hearing impaired. An audio feed from the touring console is requested for the operation of this system. The theatre is also equipped with audio description listening devices.

**ELECTRICAL INFORMATION**

Two ETC Eos Lighting Control Boards with Network ETC Net 3 is located in the lighting control booth at the rear of the Mezzanine.

The system incorporates DMX 512 protocol nodes located throughout the Theatre which are connected via an Ethernet-based data distribution system. The system connects to five hard-wired Sensor Plus dimmer racks in the under-stage basement and an additional 96 dimmer portable rack located on the stage-right patch bay shelf.

Intercom and program material are wired to the booth.

DMX locations:

- Mid-house designer's location with a network tap allowing connection to a portable network node.
- 7 Permanent  
Highbay, Dress Circle, Box Booms Right and Left, Mezzanine Rail, Eyebrow and Downstage Right.
- 15 Portable Nodes  
5 - House Overstage Electrics  
2 - Stage Ladders  
5 - 'Stand By'  
1 - Input Gateway  
1 - Output Gateway  
1 - Midhouse Designer with Network Switch to allow connection to lighting network.

Power consists of:

- Two road switches, rated at 400 amps each, 3 phase 110/220 (1,200 total amps per switch) are located stage-right, cam lock tie in.
- One isolated road switch, rated at 200 amps, 3 phase 110/220 (300 total amps) located on the downstage left basement, dedicated for sound.
- One 100 amp, 3 phase 110/220 (300 amps) are located up stage-right on the loading dock.
- One 100 amp, 3 phase 110/220 (300 amps) are located upstage left.
- One additional road switch, rated at 400 amps, 3 phase (1,200 total amps), located stage-right can be made available—rental fee applies.

The follow-spot booth is at the rear of the Balcony, 151' from stage. The booth has four (4) Lycian 3,000 watt Xenon Followspots and provisions for additional projection. Intercom and program material are wired to the booth.

A total of 546 circuits are available on stage and in the house. All circuits are minimum 20 amp. All circuits are equipped with the appropriate 3-pin stage connector. The principal lighting positions available in front of the proscenium include:

- High Bay (cove) 28 circuits—In the ceiling above the orchestra section are 24 Ellipsoidal Reflector Spots—750 w.
- Proscenium Wells 8 circuits per side - Located Stage-Right and Left, just off the apron, these alcoves have adjustable lighting positions from stage level to 30' above the stage floor.
- Balcony Rail 36 circuits
- Mezzanine Rail 24 circuits
- Far Box Booms 16 circuits per side—Located directly above the front of the Upper Loges Stage-Right and Left the booms are unmasked 20' vertical pipes for mounting instruments on sidearms.
- Near Box Booms 6 circuits per side—Located 30' downstage of Proscenium (approx. 1/2 way to Far Boom Box). Right and Left Booms are unmasked 16' pipes. Note: Pipes are stowed folded against wall and must be unfolded to be used.

STAGE CIRCUIT DETAIL		
CIRCUIT QUANTITY	RECEPTACLE LOCATION	AMPACITY NOTES
36	Balcony Front	20
28	House High Bay	
24	Mezzanine Rail	
16	Box Boom, Stage-Right	
16	Box Boom, Stage-Left	
8	Proscenium, Down Stage-Right Wells	
8	Proscenium, Down Stage-Left Wells	
4	Proscenium, Stage-Left	
4	Proscenium, Stage-Right	
36	Anti Proscenium	20 A,B
36	1st Electric	20
32	2nd Electric	20
30	3rd Electric	
30	4th Electric	
24	5th Electric	20
4	5th Electric	50 A,B
48	Floor Pockets	20
18	Stage-Right Electrics Ladder	20 A
18	Stage-Left Electrics Ladder	20 A
96	Portable Dimmer Rack Patch Panel	20 C
8	Houselight Control	50

554 - 20 Amp Dimmer Cubicles with connected Load Receptacles

4 - 50 Amp Dimmer Cubicles with connected Load Receptacles

- Note
- A) Load Circuit(s) parallel with other(s)
  - B) Road Patch panel located Down Stage-Right
  - C) Portable Dimmer Rack is located on the Patch Bay shelf stage-right

## EQUIPMENT INFORMATION

### Equipment Provided at No Charge— Subject to Availability

Curtains	Black legs and Borders Black Back Drop White Scrim
Microphones (first 3 no charge)	AKG 451 EB, Shure SM 81 PZM Sennheiser 421 Shure SM 57, SM 58, SM 99 Sony ECM 50 Lavalier Countryman Isomax 4 Direct boxes
Lecterns	Free-Stand ing
Music Equipment	Conductor's podium Music Stands with and without lights

INSTRUMENT TYPE	DEGREE	INVENTORY
Source 4-5° addition 5° barrels	5°	15 20
Source 4's-10° (can be lensed for 5°)	10°	28
Source 4's-14°	14°	12
Source 4's-19°	19°	105
Source 4's-26°	26°	90
Source 4's-36°	36°	61
Source 4's-50°	50°	6
Source 4's PARNEL	variable	14
Source 4's-PAR	VN/N/M/W lens	66
Color Blaze TRX 6' section <sup>5</sup>		10
FOLLOWSPOTS - Lycian 3K		4

\*House hang available upon request.  
Inventory subject to current availability and includes instruments both in house and in storage

### Equipment Available on Rental Basis—Rates Upon Request

Pianos	Concert Grand	9' Baldwin	1 available
	Baby Grand	5'7" Steinway	1 available
	Upright	Yamaha concert	1 available
Orchestra Shell	walls and ceilings		
Additional PA	Full range cabinets with JBL subs		
Monitor System	Yamaha wedges and JBL SR cabinets		
Intercom System	Clear Com, plus 4 wireless headsets		
Follow Spots	Lycian 3,000 watt, 1293, Xenon 4		
Wireless Microphone	Shure ULX/D-4 and ULX/P-3 (hand held and lavalier)		
Risers	Ballet Dance Floor		
	d'Ansur modular sprung flooring, to 64' wide x 48' deep and Harlequin surface		
Tape Machines	CD Player/Rec.	Tascam	
	Cassette	Tascam	
Telephones	6 telephone lines have been permanently installed in the backstage area for production use (a usage fee will apply).  Please contact the Production staff for available locations or to arrange special or additional installations.		
Courtesy Phone	Dressing Room area Stage Left No charge for local calls		
Genie 36' AWP	2 available—first one at no charge		
Internet Broadband	A hard-wired connection is available in the Green Room and can be extended to the Dressing Rooms. Wireless service is available throughout the Dressing Room area and Backstage. (an access fee will apply.)		
Washer & Dryer	3 sets located in the understage area		

**CIVIC THEATRE BACKSTAGE MAP**

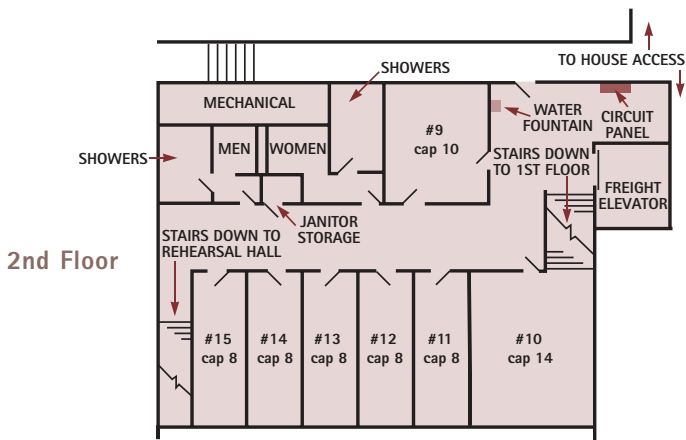

**DRESSING ROOMS**

There are 15 dressing rooms available on two floors stage-left. At full capacity, these facilities will accommodate 92 people. All dressing rooms are equipped with mirrors, lights, wash basins, clothes racks, convenience outlets, etc. Toilet facilities and showers are nearby (Dressing Rooms #1 and #2 have private restrooms and showers). Drinking water is available throughout the facility. Three sets of washer and dryer are available for use (rental fee applies) and are located in the storage area below stage, stage-right. A small Company/Show Office space is available in the dressing room area. Six telephone lines are available, 4 in Green Room, 2 in 'Office' (rental charges apply).

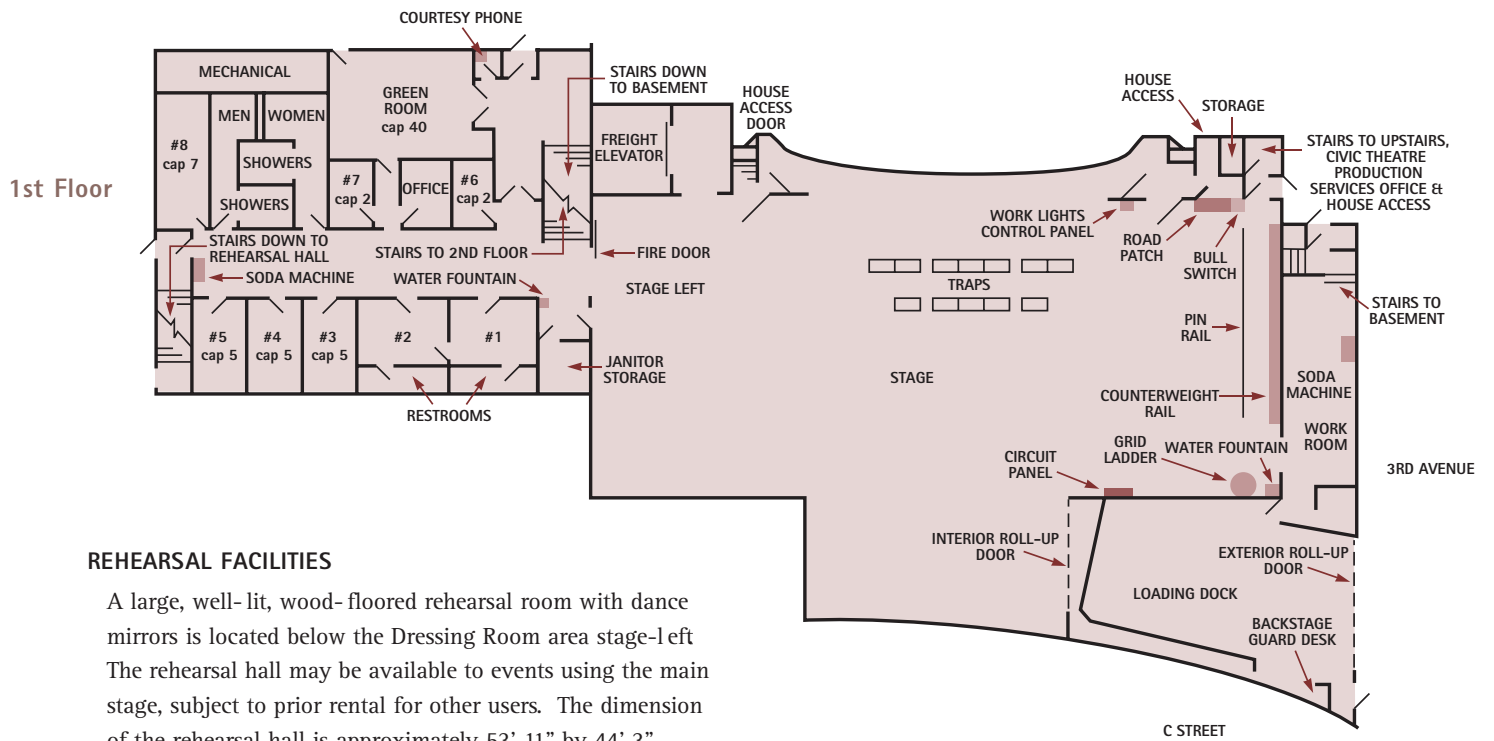

**REHEARSAL FACILITIES**

A large, well-lit, wood-floored rehearsal room with dance mirrors is located below the Dressing Room area stage-left. The rehearsal hall may be available to events using the main stage, subject to prior rental for other users. The dimension of the rehearsal hall is approximately 53' 11" by 44' 3".

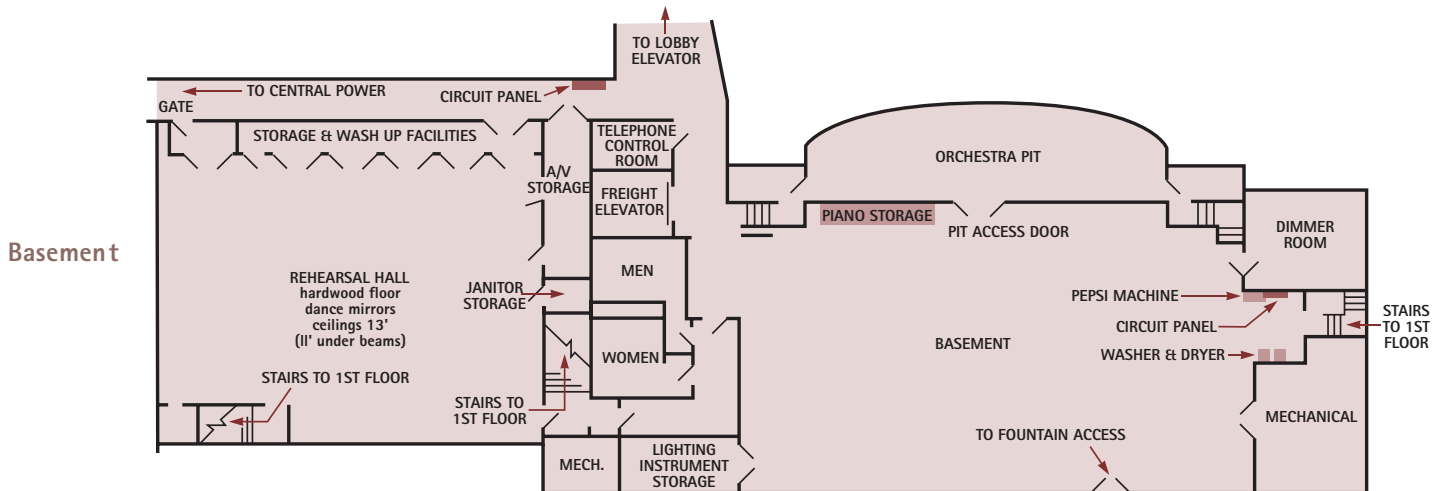



CIVIC THEATRE SEATING CONFIGURATION

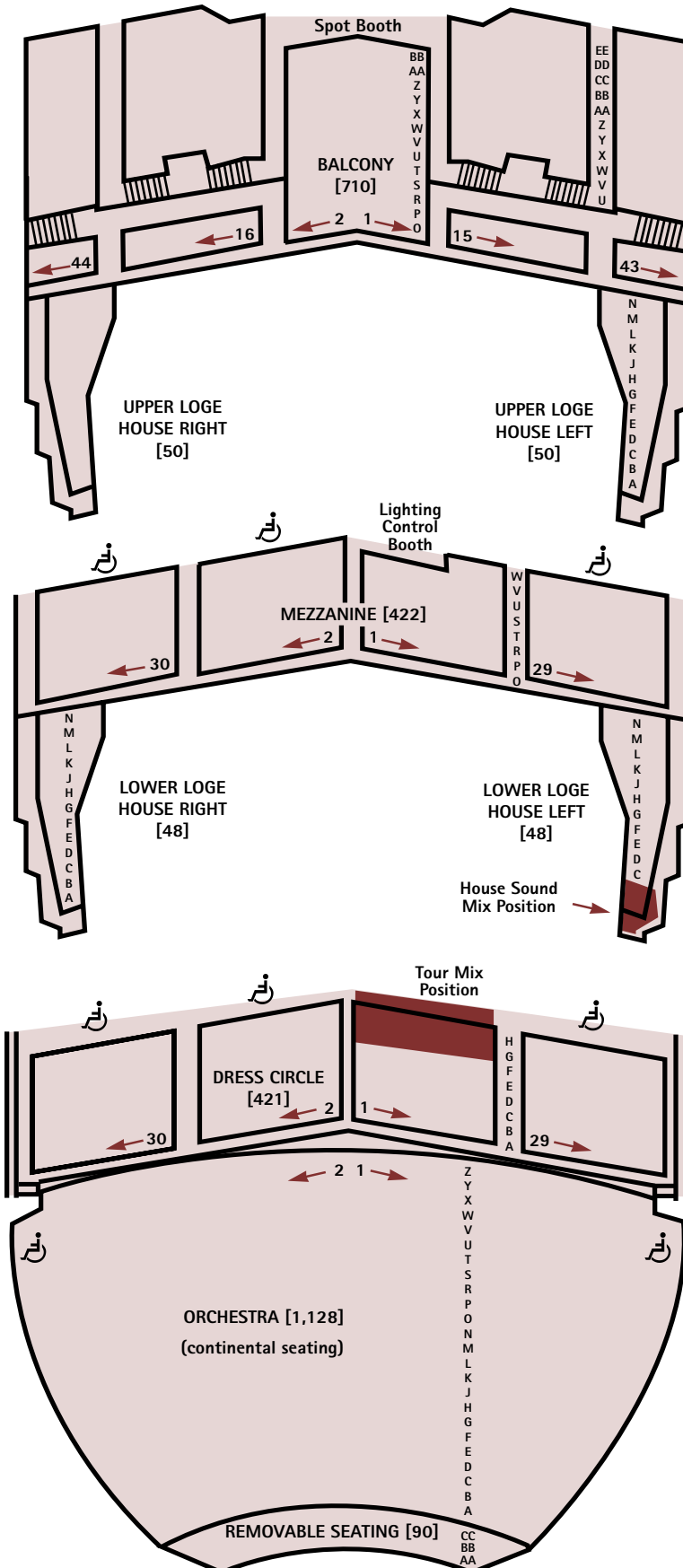

<b>TOTAL SEATING CAPACITY</b> . . . . .	2,967
<b>UPPER LEVEL</b>	
Balcony . . . . .	710
Upper Loges . . . . .	100
<b>MIDDLE LEVEL</b>	
Mezzanine (incl. 12 wheelchair locations) . .	422
Lower Loges . . . . .	96
<b>DRESS CIRCLE</b>	
Fixed (incl. 12 wheelchair locations) . . . .	394
Mixer Seats . . . . .	27
<b>Total Dress Circle</b> . . . . .	421
<b>ORCHESTRA</b>	
Fixed (incl. 12 wheelchair locations) . . . .	1,128
Removable Seating	
Row CC . . . . .	35
Row BB . . . . .	30
Row AA . . . . .	25
<b>Total Orchestra Level</b> . . . . .	1,218
<b>Total Civic Theatre Capacity</b> . . . . .	2,967
<b>ORCHESTRA PIT IN USE</b>	
Standard Pit—remove	
AA & BB Revised Capacity . . . . .	2,912
Extended Pit—remove	
CC also Revised Capacity . . . . .	2,887



1100 Third Avenue  
San Diego California 92101  
619.615.4000 619.615.4001 FAX  
[www.sandiegotheatres.org](http://www.sandiegotheatres.org)