

● Features

- Low maintenance with high reliability
- Easy installation
- New style mounting plate with increased immobility
- Aluminum anodized casing
- MOV prevents spike and surge current
- Dual voltage 12/24 VDC
- Anti-residual magnetism function (ARM)

● Statement

GEM-1200 electromagnetic lock uses a new style mounting plate patented. The mounting plate is designed with increased thickness of screw holes in order to provide lock body with more immobility and strength. GEM-1200 can be installed on various types of doors or door frames with different brackets.

● Specification

- Operating Voltage: 12/24VDC
- Current Draw: 500mA/12VDC; 250mA/24VDC (at 20 ° C)
- Operating temperature: -10~55 ° C (14~131 ° F)
- Humidity: 0~95% non-condensing
- Holding force: up to 1200lbs (equivalent to 545kg)
- Dimensions:
 - Magnet: (L) 267, (W) 40 , (D) 68mm
 - Armature plate: (L) 185, (W) 61 , (D) 16mm
 - Mounting plate: (L) 267, (W) 40 , (D) 8mm
- Finish for magnet and armature plate is zinc plated.
- Epoxy potting compound rating: E87252 (S) , UL94V-0
- Net Weight:4.9kg

● Dimensions

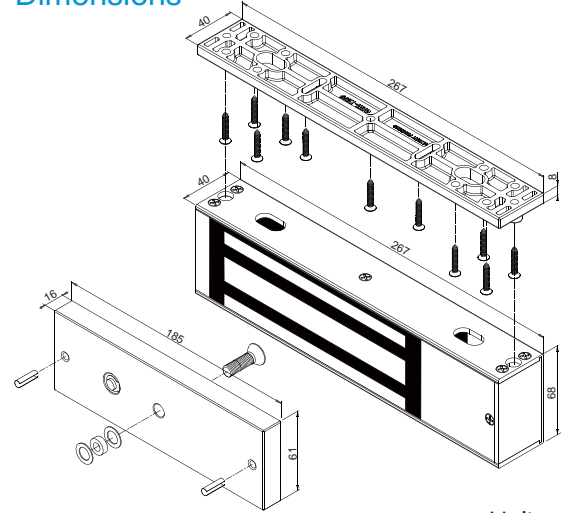

Unit: mm

● New style mounting plate (patented)

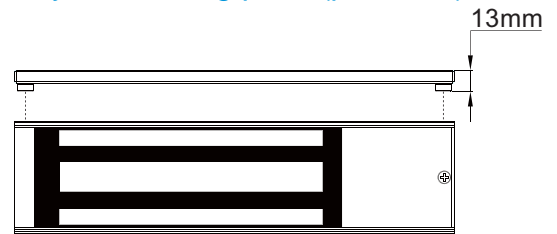

13mm thickness to increase immobility and strength

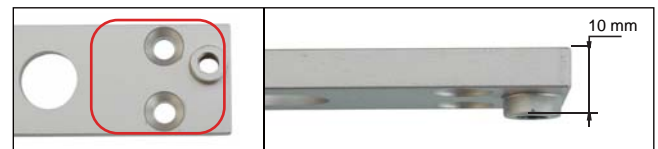

● Magnet Reversible on site

Magnet can be installed in direct or reversible direction installation

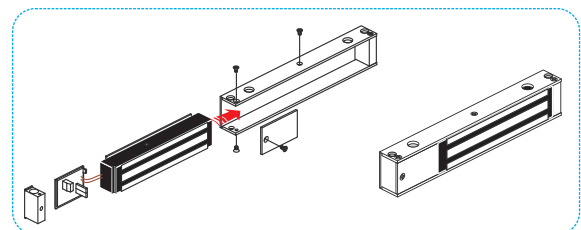
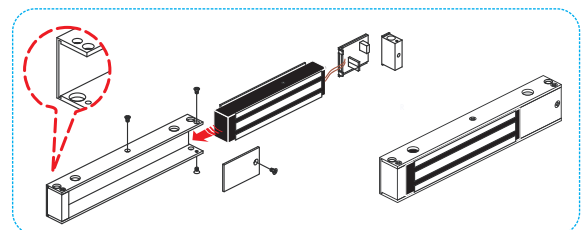

(Only for GEM-1200)

Optional Features



xxxxx-M: Bond sensor output
Indicate the door locking status (locked / unlocked) with a visible LED light, which helps to identify from distance.

Bond sensor output: SPDT rated : 0.5A/120VAC;1A/24VDC



xxxxx-BZ: Buzzer Alarm
Door Held Open Alarm is an auditory feedback for users. The alarm sounds when the door is open and that has exceeded a specified timelimit. VR timer is adjustable from 1 to 20 seconds.

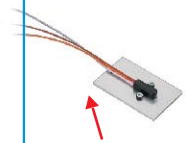

xxxxx-DS: Door Status
Door Status Sensor indicates the door position (open/closed).
Optional accessories (TLM-100MTS/TLM-200) offer higher security through remote monitoring.

Door status output: SPDT rated: 0.2A/12VDC



The armature plate is covered by a plastic housing.

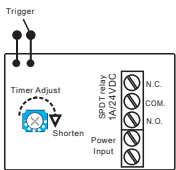

xxxxx-TD: Relock time delay
A built-in timer allows a relocking time delay which is adjustable from 1 to 80 seconds.

Standard Installation

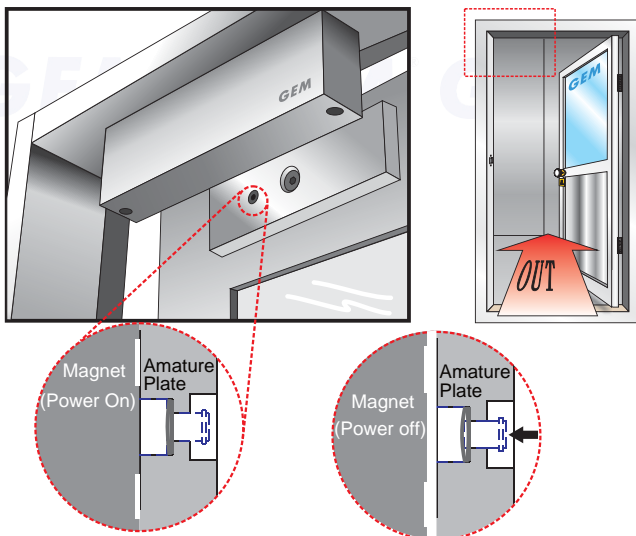

Anti-Residual Magnetism design

Our electromagnet locks feature Anti-Residual Magnetism (ARM) which ensures the door can be opened without any resistance from leftover magnetism imparted to the armature plate.

Optional Brackets

A appropriate bracket complements the magnetic lock. Brackets are selected according to the direction of door swing, the thickness of door frame and the materials of the doors.

Outswing doors: L-brackets are recommended for narrow frame doors.

When the door frame thickness (marked 'A') is less than 60 mm L-GEM-1200 bracket should be used to enable installation.

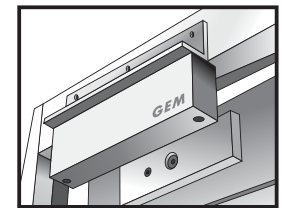
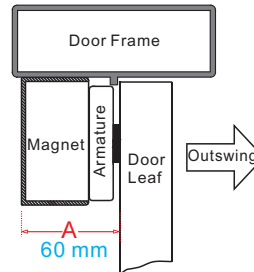
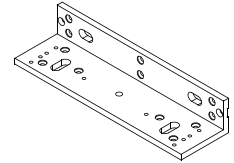

L-GEM-1200

The mounting plate should be screwed to the L-bracket prior to installing the L-bracket. After the L-bracket is installed the magnet can then be screwed to the L-bracket.

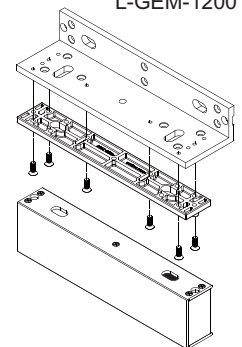

Inswing doors: LZ-brackets are recommended for doors that open inwards.

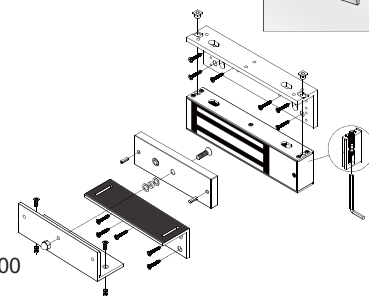
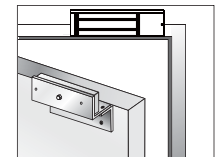

LZ-GEM-1200

Warranty

The product is warranted against defects in material and workmanship while used in normal service for a period of 5 years from the date of sale to the original customer. The GEM policy is one of continual development and improvement ; therefore GEM reserves the right to change specifications without notice.