

Session 10

Use of handheld electronic devices for census data collection

Macau S.A.R. of China
Statistics and Census Service

Outlines

- ▶ Overview in 2016 Population By-census
- ▶ Introduction of Mobile Questionnaire System
- ▶ Key Features of Mobile Questionnaire System
- ▶ Demonstration

Overview in 2016 population by-census

Overview in 2016 Population By-census

- ▶ Conducted over a period of 15 days
- ▶ Sampling fraction of one-seventh
- ▶ About 33,000 housing units
- ▶ About 800 enumerators



2016
中期人口統計
INTERCENSOS

Introduction of Mobile Questionnaire System

Introduction of Mobile Questionnaire System

- ▶ **First Generation**
 - Since 2009 to 2016
 - Only support offline mode
 - 2011 population census (long form)
- ▶ **Second Generation**
 - Since 2015
 - Support online and offline mode
 - 2016 population by-census

Introduction of Mobile Questionnaire System

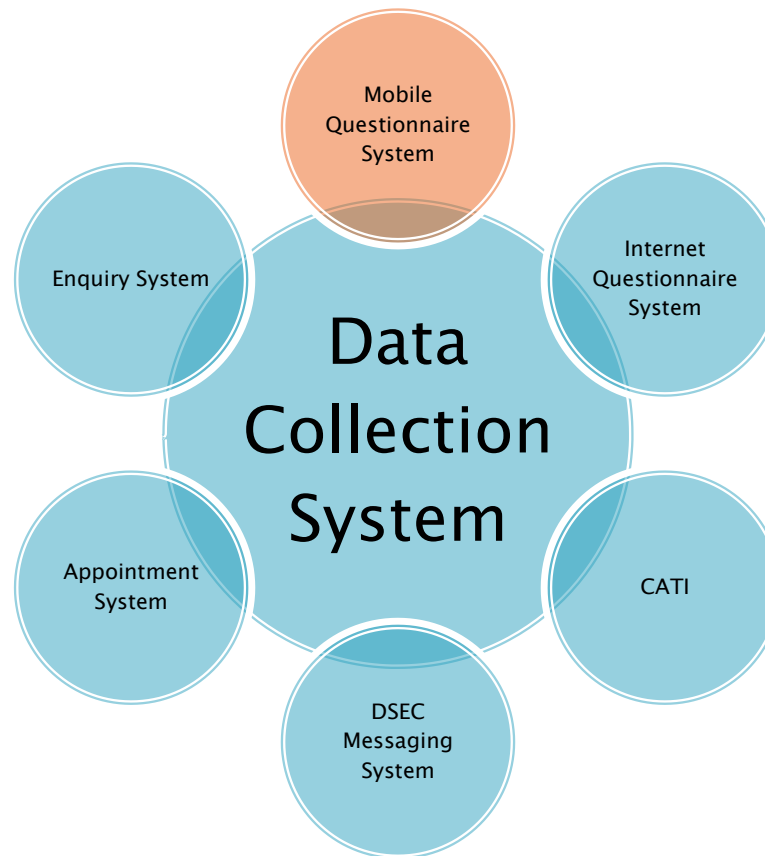

Introduction of Mobile Questionnaire System

- ▶ Used for face-to-face interview data collection
- ▶ Support online and offline mode
 - Can collect data without network
- ▶ Can locate the household unit by GIS
- ▶ Activate the Internet Questionnaire System
- ▶ Integrate with DSEC Messaging System
- ▶ Check-in/check-out mechanism
- ▶ Data encryption
- ▶ Multiple languages (questionnaire)

Introduction of Mobile Questionnaire System

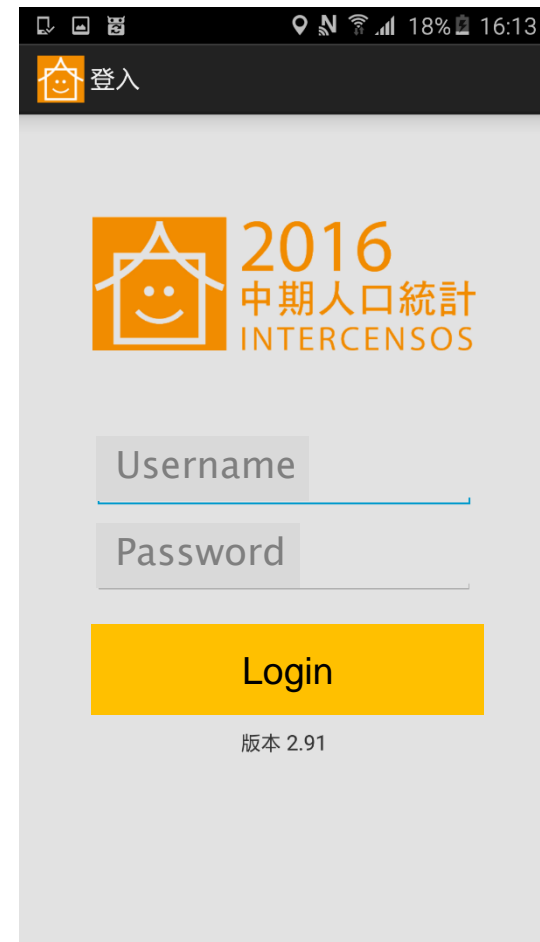
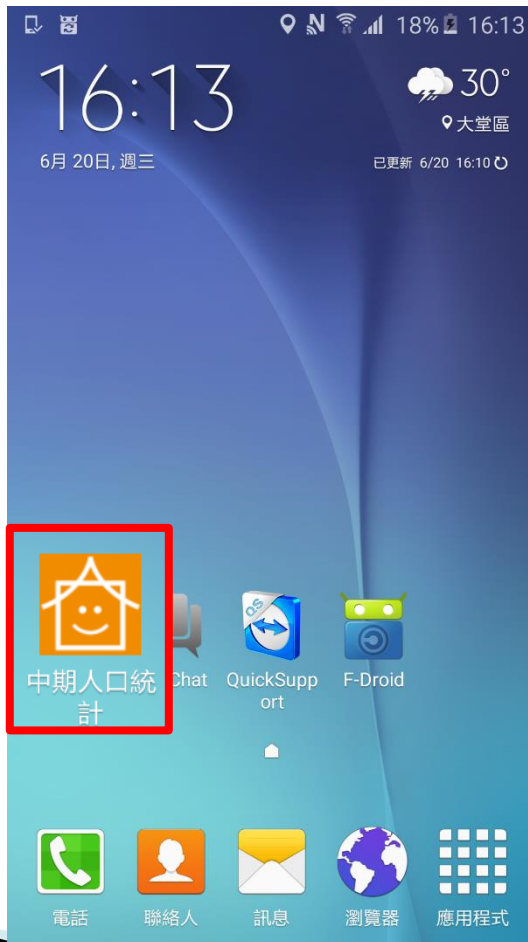

Key Features of Mobile Questionnaire System

Key Features of Mobile Questionnaire System

- Data collection
- Assignment location
- Questionnaire flow
- Validation
- Industry / Profession Coding System
 - Real time encode it by entering text
 - Using the vocabulary collected from the past surveys
 - 492 industry categories
 - 468 occupation categories

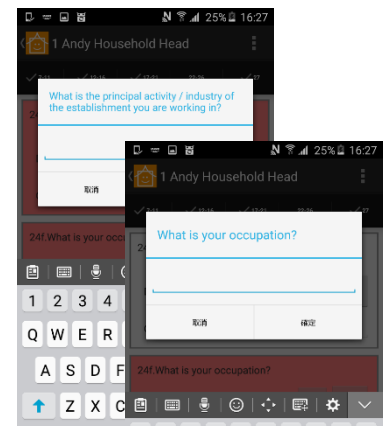

Demonstration

Thank You