



**REFRIGERATION SUPERSTORE**

*World's Largest Inventory*

*New & Used Walk-In/ Drive-In Coolers/ Freezers/ Refrigeration Systems*

1423 Planeview Drive, Oshkosh, WI 54904 Tel (920) 231-1711 Fax (920) 231-1701 www.barrinc.com

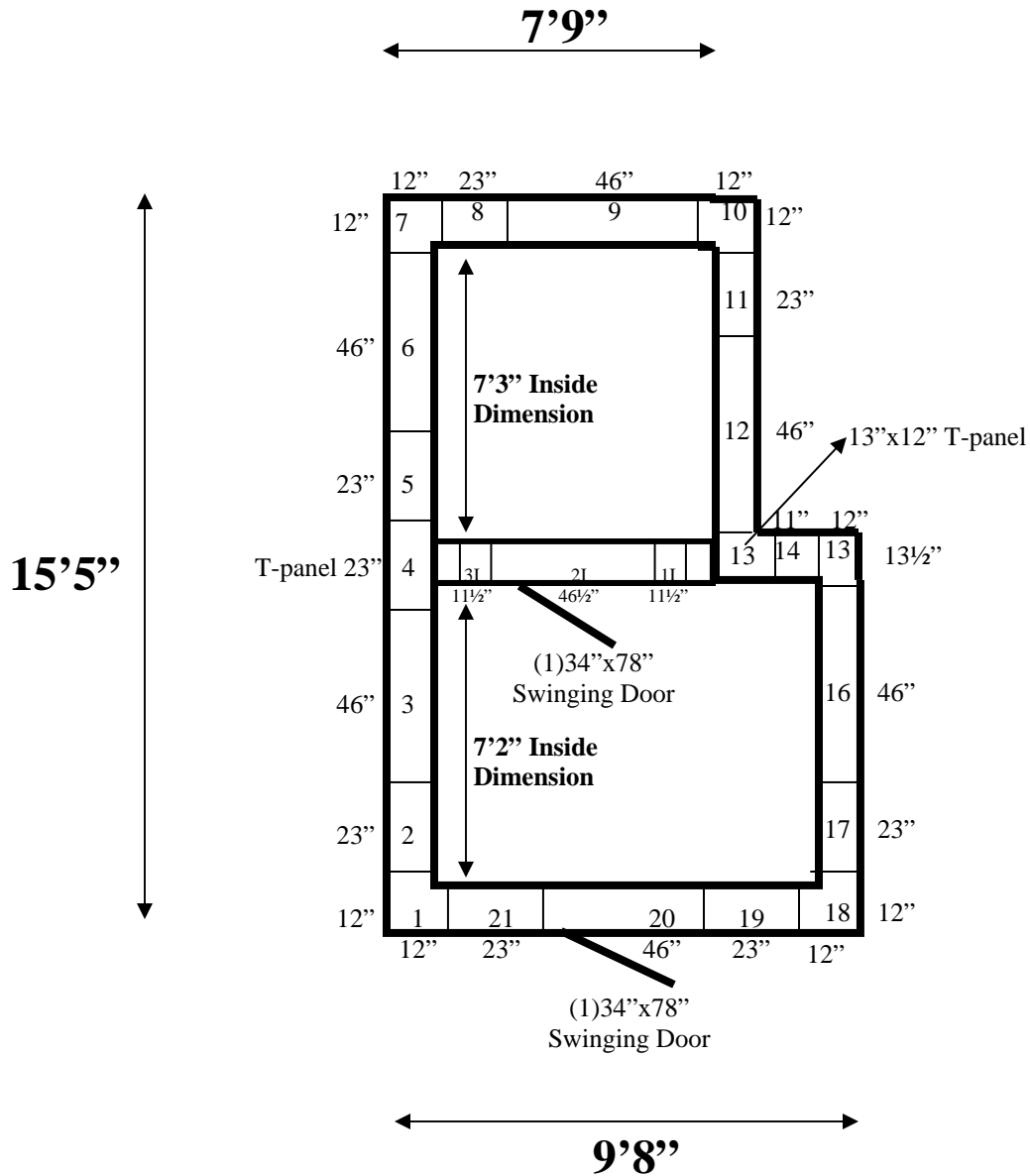

Interior ramp included.

**9'8" x 15'5" x 7'7" H  
Combination Walk-In Cooler/ Walk-In Freezer  
Wall Panels Diagram**

77-10  
red



**REFRIGERATION SUPERSTORE**

*World's Largest Inventory*

*New & Used Walk-In/ Drive-In Coolers/ Freezers/ Refrigeration Systems*

1423 Planeview Drive, Oshkosh, WI 54904 Tel (920) 231-1711 Fax (920) 231-1701 www.barrinc.com

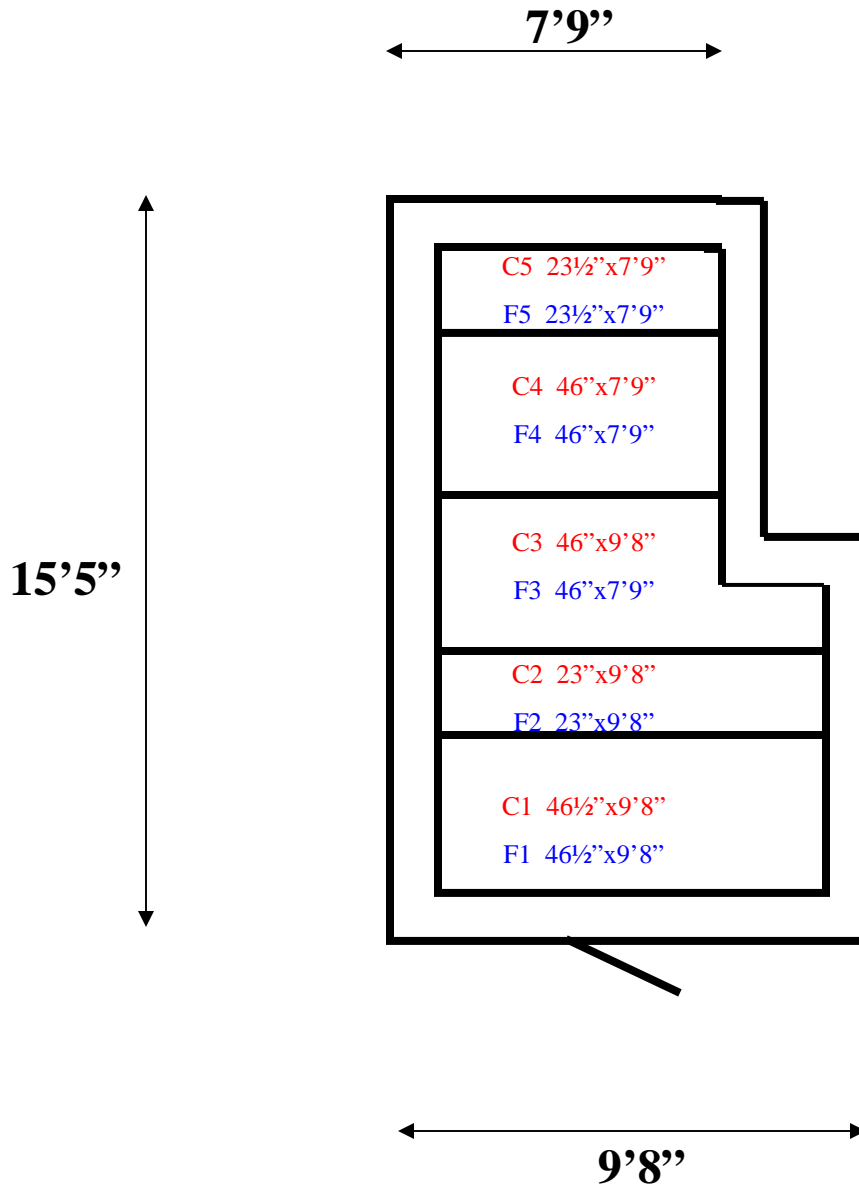

\*Ceiling & Floor panels layout the same.

**9'8" x 15'5" x 7'7" H  
Combination Walk-In Cooler/ Walk-In Freezer  
Ceiling & Floor Panels Diagram**



**REFRIGERATION SUPERSTORE**

*World's Largest Inventory*

*New & Used Walk-In/ Drive-In Coolers/ Freezers/ Refrigeration Systems*

1423 Planeview Drive, Oshkosh, WI 54904 Tel (920) 231-1711 Fax (920) 231-1701 www.barrinc.com



**9'8" x 15'5" x 7'7" H  
Combination Walk-In Cooler/ Walk-In Freezer**

77-10  
red



**REFRIGERATION SUPERSTORE**

*World's Largest Inventory*

*New & Used Walk-In/ Drive-In Coolers/ Freezers/ Refrigeration Systems*

1423 Planeview Drive, Oshkosh, WI 54904 Tel (920) 231-1711 Fax (920) 231-1701 [www.barrinc.com](http://www.barrinc.com)



**9'8" x 15'5" x 7'7" H**  
**Combination Walk-In Cooler/ Walk-In Freezer**

77-10  
red