

# CASSONE

## OFFICE CONTAINER OC10 1 OFFICE

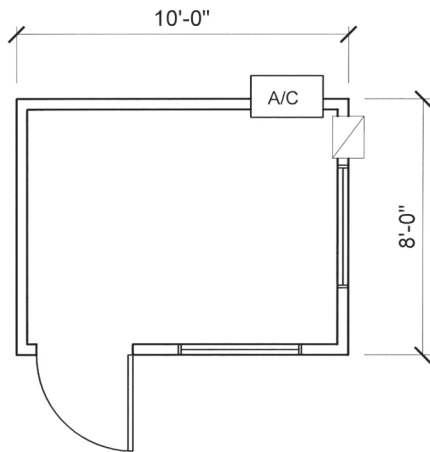

ADDITIONAL FLOOR PLANS ARE AVAILABLE. FLOOR PLANS AND SPECIFICATIONS MAY VARY FROM THOSE SHOWN ABOVE AND ARE SUBJECT TO AVAILABILITY.

NOTES: \_\_\_\_\_  
\_\_\_\_\_  
\_\_\_\_\_  
\_\_\_\_\_

### CUSTOMER APPROVAL

Customer Signature \_\_\_\_\_ Date \_\_\_\_\_

Print Name \_\_\_\_\_



### OC10 1 OFFICE FEATURES

#### SIZE

- 8' x 10' Box

#### INTERIOR

- 1 Office
- VCG Interior Walls
- Vinyl Floors

#### ELECTRIC

- Fluorescent Ceiling Lights
- 100 Amp Breaker Panel

#### WINDOWS AND DOORS

- 46" x 27" Sliding Windows
- Steel Exterior Door

#### HEATING AND COOLING

- 1 Thru Wall AC Units
- Electric Baseboard Heat

#### EXTERIOR

- Reinforced Corrugated Steel
- Security Package Available

1.800.640.8844 or 631.585.7800

1900 Lakeland Avenue, Ronkonkoma, New York 11779  
FAX: 631.585.7895 ■ WBE & DBE CERTIFIED



WWW.CASSONE.COM