

CASSONE

GUARD BOOTHS

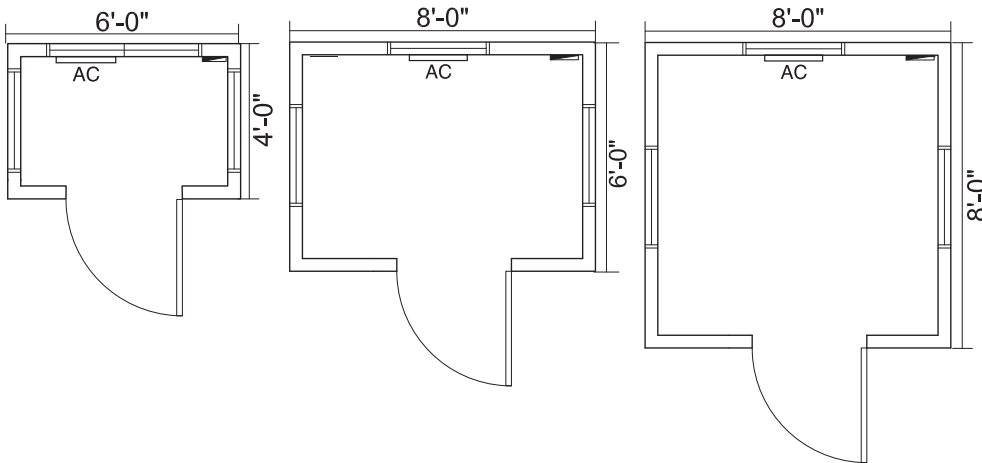

ADDITIONAL FLOOR PLANS ARE AVAILABLE. FLOOR PLANS AND SPECIFICATIONS MAY VARY FROM THOSE SHOWN ABOVE AND ARE SUBJECT TO AVAILABILITY.

NOTES: _____

CUSTOMER APPROVAL

Customer Signature _____ Date _____

Print Name _____



GUARD BOOTH FEATURES

SIZE

- 4' x 6', 6' x 8' and 8' x 8'

INTERIOR

- Panel Walls
- Epoxy Floors
- Optional Desktop Available

ELECTRIC

- LED Strip Light
- 60 Amp Panel

WINDOWS AND DOORS

- 4' x 6' - 30" x 27" Sliding Windows
- 6' x 8' - 46" x 27" Sliding Windows
- 8' x 8' - 46" x 27" Sliding Windows
- Steel Exterior Door

HEATING AND COOLING

- Electric Baseboard Heat
- Thru Wall A/C

EXTERIOR

- Smart Panel

1.800.640.8844 or 631.585.7800

1900 Lakeland Avenue, Ronkonkoma, New York 11779
FAX: 631.585.7895 ■ WBE & DBE CERTIFIED



WWW.CASSONE.COM