



86215



86324



WELD-ON HUBS

V-SERIES

P/N	BORE TYPE	BORE SIZE	WEIGHT
86188	Round	1/2"	0.40
86189	Round	9/16"	0.38
86190	Round	5/8"	0.32
86191	Round	11/16"	0.34
86192	Round	3/4"	0.30
86193	Round	13/16"	0.28
86194	Round	7/8"	0.26

Standard Package = 1 piece

W-SERIES

P/N	BORE TYPE	BORE SIZE	WEIGHT
86200	Stock	1/2"	0.86
86208	Round	1/2"	0.90
86209	Round	9/16"	0.88
86210	Round	5/8"	0.84
86211	Round	11/16"	0.80
86212	Round	3/4"	0.78
86213	Round	13/16"	0.76
86214	Round	7/8"	0.72
86215	Round	15/16"	0.68
86216	Round	1"	0.64
86217	Round	1-1/16"	0.60
86218	Round	1-1/8"	0.55
86219	Round	1-3/16"	0.52
86220	Round	1-1/4"	0.46
86224	Hexagon	7/8"	0.70
86226	Hexagon	1"	0.62
86228	Hexagon	1-1/8"	0.52
86231	6 Spline	1-1/8"	0.62
86232	6 Spline	1-3/8"	0.46
86233	21 Spline	1-3/8"	0.42
86252	Square	3/4"	0.72
86254	Square	7/8"	0.66
86256	Square	1"	1.00

Standard Package = 1 piece

V Series

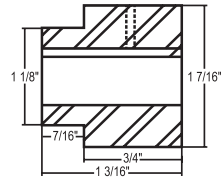

W Series

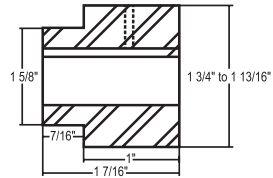

X Series

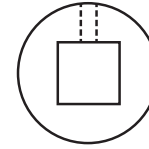
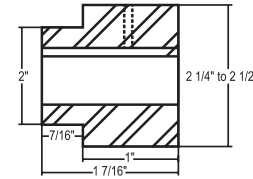

Square Bore
with Set Screws

X-SERIES

P/N	BORE TYPE	BORE SIZE	WEIGHT
86300	Stock	5/8"	1.36
86310	Round	5/8"	1.62
86311	Round	11/16"	1.54
86312	Round	3/4"	1.30
86313	Round	13/16"	1.48
86314	Round	7/8"	1.44
86315	Round	15/16"	1.40
86316	Round	1"	1.38
86317	Round	1-1/16"	1.38
86318	Round	1-1/8"	1.28
86319	Round	1-3/16"	1.24
86320	Round	1-1/4"	1.18
86321	Round	1-5/16"	1.18
86322	Round	1-3/8"	1.14
86323	Round	1-7/16"	1.05
86324	Round	1-1/2"	1.00
86334	Hexagon	7/8"	1.48
86336	Hexagon	1"	1.40
86338	Hexagon	1-1/8"	1.30
86341	6 Spline	1-1/8"	1.38
86342	6 Spline	1-3/8"	1.24
86343	21 Spline	1-3/8"	1.20
86352	Square	3/4"	1.50
86354	Square	7/8"	1.44
86356	Square	1"	1.32
86358	Square	1-1/8"	1.19
86359	Square	1-3/16"	1.14
86360	Square	1-1/4"	1.08

Standard Package = 1 piece

HUBS, SPROCKETS & PULLEYS



SPROCKETS



86023

35 Chain

P/N	NUMBER OF TEETH	OUTSIDE DIAMETER	FITS HUB SERIES	WEIGHT
86015	15	2"	V	0.06
86016	16	2-1/8"	V	0.08
86017	17	2-1/4"	V	0.10
86018	18	2-3/8"	V	0.12
86019	19	2-1/2"	V	0.12
86020	20	2-5/8"	V	0.16
86021	21	2-3/4"	V	0.18
86022	22	2-13/16"	W	0.14
86023	23	2-15/16"	W	0.16
86024	24	3-1/16"	W	0.20
86025	25	3-3/16"	W	0.22
86026	26	3-5/16"	W	0.26
86027	27	3-7/16"	W	0.28
86028	28	3-9/16"	W	0.32
86029	29	3-11/16"	W	0.34
86030	30	3-13/16"	W	0.36
86032	32	4-1/16"	W	0.38
86035	35	4-5/16"	W	0.52
86036	36	4-1/2"	W	0.56
86040	40	4-15/16"	W	0.72
86045	45	5-9/16"	W	0.84
86048	48	5-15/16"	W	1.12
86060	60	7-5/16"	W	1.78
86072	72	8-3/4"	W	2.46
86084	84	10-1/4"	W	3.28
86096	96	11-5/8"	W	4.32

Standard Package = 1 piece



86460

40 Chain

P/N	NUMBER OF TEETH	OUTSIDE DIAMETER	FITS HUB SERIES	WEIGHT
86412	12	2-3/16"	V	0.12
86413	13	2-1/4"	V	0.16
86414	14	2-7/16"	V	0.20
86415	15	2-5/8"	V	0.24
86416	16	2-13/16"	W	0.20
86417	17	3"	W	0.26
86418	18	3-1/8"	W	0.30
86419	19	3-5/16"	W	0.35
86420	20	3-7/16"	X	0.32
86421	21	3-5/8"	X	0.40
86422	22	3-3/4"	X	0.46
86423	23	4"	X	0.48
86424	24	4-1/16"	X	0.58
86425	25	4-3/16"	X	0.66
86426	26	4-3/8"	X	0.72
86427	27	4-1/2"	X	0.80
86428	28	4-11/16"	X	0.90
86429	29	4-3/4"	X	0.96
86430	30	5-1/16"	X	1.02
86432	32	5-3/8"	X	1.20
86435	35	5-11/16"	X	1.60
86436	36	6"	X	1.56
86440	40	6-5/8"	X	2.00
86442	42	7"	X	2.30
86445	45	7-3/8"	X	2.66
86448	48	7-7/8"	X	3.06
86454	54	8-7/8"	X	4.00
86460	60	9-13/16"	X	5.20
86472	72	11-3/16"	X	7.34
86480	80	12-15/16"	X	9.41
86496	96	15-1/2"	X	13.92

Standard Package = 1 piece

SPROCKETS

50 Chain

86560



P/N	NUMBER OF TEETH	OUTSIDE DIAMETER	FITS HUB SERIES	WEIGHT
86510	10	2-1/4"	V	0.14
86511	11	2-1/2"	V	0.22
86512	12	2-3/4"	W	0.18
86513	13	2-7/8"	W	0.24
86514	14	3-1/16"	W	0.32
86515	15	3-1/4"	W	0.40
86516	16	3-7/16"	W	0.48
86517	17	3-11/16"	X	0.46
86518	18	3-7/8"	X	0.56
86519	19	4-1/8"	X	0.68
86520	20	4-3/8"	X	0.80
86521	21	4-9/16"	X	0.90
86522	22	4-3/4"	X	1.00
86523	23	4-15/16"	X	1.12
86524	24	5-1/8"	X	1.24
86525	25	5-3/8"	X	1.42
86526	26	5-1/2"	X	1.54
86527	27	5-11/16"	X	1.62
86528	28	5-7/8"	X	1.84
86529	29	6-1/8"	X	1.90
86530	30	6-5/16"	X	2.14
86531	31	6-1/5"	X	2.30
86532	32	6-3/4"	X	2.52
86533	33	6-7/8"	X	2.64
86534	34	7-1/16"	X	2.84
86535	35	7-1/4"	X	2.98
86536	36	7-9/16"	X	3.28
86537	37	7-11/16"	X	3.40
86538	38	7-15/16"	X	3.62
86539	39	8-1/8"	X	3.84
86540	40	8-5/16"	X	4.22
86541	41	8-1/2"	X	4.24
86542	42	8-11/16"	X	4.52
86543	43	8-7/8"	X	4.90
86544	44	9-1/16"	X	4.82
86545	45	9-5/16"	X	5.12
86548	48	9-7/8"	X	5.78
86550	50	10-1/4"	X	6.56
86554	54	11-1/16"	X	7.36
86560	60	12-5/16"	X	9.44
86572	72	14-5/8"	X	14.34
86580	80	16-1/4"	X	16.90
86596	96	19-7/16"	X	24.78

Standard Package = 1 piece

60 Chain

86623



P/N	NUMBER OF TEETH	OUTSIDE DIAMETER	FITS HUB SERIES	WEIGHT
86609	9	2-1/2"	V	0.28
86610	10	2-3/4"	V	0.38
86611	11	3"	W	0.32
86612	12	3-1/4"	W	0.46
86613	13	3-1/2"	W	0.60
86614	14	3-3/4"	W	0.74
86615	15	4"	X	0.78
86616	16	4-1/4"	X	0.94
86617	17	4-1/2"	X	1.10
86618	18	4-11/16"	X	1.30
86619	19	5"	X	1.46
86620	20	5-1/8"	X	1.70
86621	21	5-1/2"	X	1.94
86622	22	5-11/16"	X	2.16
86623	23	5-15/16"	X	2.30
86624	24	6-1/8"	X	2.66
86625	25	6-3/8"	X	2.96
86626	26	6-5/8"	X	3.20
86627	27	6-7/8"	X	3.42
86628	28	7-1/8"	X	3.85
86629	29	7-3/8"	X	4.12
86630	30	7-5/8"	X	4.46
86631	31	7-3/4"	X	4.72
86632	32	8"	X	5.04
86633	33	8-5/16"	X	5.30
86634	34	8-9/16"	X	5.76
86635	35	8-3/4"	X	6.20
86636	36	9"	X	6.50
86638	38	9-7/8"	X	7.16
86640	40	9-15/16"	X	8.06
86642	42	10-1/2"	X	8.78
86645	45	11-3/16"	X	10.24
86648	48	11-7/8"	X	12.06
86654	54	12-3/8"	X	15.42
86660	60	14-3/4"	X	19.36
86672	72	17-5/8"	X	27.92
86680	80	19-1/2"	X	34.64

Standard Package = 1 piece

HUBS, SPROCKETS & PULLEYS



SPROCKETS



86823

80 Chain

P/N	NUMBER OF TEETH	OUTSIDE DIAMETER	FITS HUB SERIES	WEIGHT
86809	9	3-1/4"	W	0.58
86810	10	3-5/8"	W	0.80
86811	11	4"	W	1.40
86812	12	4-3/8"	X	1.14
86813	13	4-5/8"	X	1.42
86814	14	5"	X	1.72
86815	15	5-1/4"	X	2.12
86816	16	5-5/8"	X	2.42
86817	17	6"	X	2.76
86818	18	6-5/16"	X	3.24
86819	19	6-9/16"	X	3.72
86820	20	6-15/16"	X	3.86
86821	21	7-1/4"	X	4.64
86822	22	7-9/16"	X	5.26
86823	23	7-7/8"	X	5.80
86824	24	8-3/16"	X	6.38
86825	25	8-1/2"	X	6.78
86826	26	8-13/16"	X	7.54
86827	27	9-3/16"	X	8.24
86828	28	9-3/8"	X	9.08
86829	29	9-3/4"	X	9.72
86830	30	10-1/8"	X	10.36
86832	32	10-13/16"	X	11.72
86833	33	11-1/8"	X	12.16
86834	34	11-3/8"	X	13.38
86835	35	11-5/8"	X	14.20
86836	36	12"	X	15.04
86840	40	13-5/16"	X	18.60
86845	45	14-7/8"	X	23.80
86848	48	15-7/8"	X	27.38
86860	60	19-5/8"	X	43.08

Standard Package = 1 piece

IDLER SPROCKETS



86124

P/N	CHAIN SIZE	NUMBER OF TEETH	BORE	WEIGHT
86108	40	17	1/2"	0.42
86110	40	17	5/8"	0.42
86112	50	13	1/2"	0.42
86114	50	13	5/8"	0.40
86116	50	15	1/2"	0.58
86118	50	15	5/8"	0.56
86120	50	17	1/2"	0.74
86122	50	17	5/8"	0.78
86124	60	11	1/2"	0.52
86126	60	11	5/8"	0.50
86128	60	13	1/2"	1.04
86130	60	13	5/8"	0.74
86132	60	15	1/2"	1.06
86134	60	15	5/8"	1.04

Standard Package = 1 piece



86716

PULLEYS

A&B BELTS

P/N	OUTSIDE DIAMETER	FITS HUB SERIES	WEIGHT
86702	2-1/2"	V	0.30
86704	3"	V	0.40
86706	3-1/2"	W	0.35
86708	4"	W	0.44
86710	4-1/2"	W	0.56
86712	5"	W	0.70
86714	5-1/2"	W	0.80
86716	6"	W	0.92
86718	6-1/2"	W	1.12
86720	7"	W	1.32
86722	8"	W	1.72
86724	9"	W	1.90
86726	10"	W	2.32
86728	11"	W	2.80
86730	12"	W	3.30
86732	14"	W	4.24
86734	16"	W	5.74

Standard Package = 1 piece

C BELTS

P/N	OUTSIDE DIAMETER	FITS HUB SERIES	WEIGHT
86736	4"	W	1.78
86738	6"	X	1.84
86740	8"	X	3.26
86742	10"	X	5.14
86744	12"	X	7.82

Standard Package = 1 piece

IDLER PULLEYS

FLAT TYPE



86745



86750

P/N	OUTSIDE DIAMETER	BORE SIZE	FLAT BORE WIDTH	WEIGHT
86745	4"	1/2"	1"	1.08
86746	4"	5/8"	1"	1.08
86750	1-7/8"	3/8"	3/4"	0.25
86752	2-1/4"	3/8"	1"	0.40
86754	2-3/4"	5/8"	7/8"	0.55
86756	3-1/4"	5/8"	3/4"	0.65
86758	3-1/2"	5/8"	3/4"	0.65
86760	4"	5/8"	3/4"	0.83
86762	4"	5/8"	1-1/2"	0.88

Standard Package = 1 piece



86764

V TYPE

P/N	OUTSIDE DIAMETER	BORE SIZE	GROOVE WIDTH	WEIGHT
86764	2-5/8"	3/8"	1/2"	0.25
86766	3"	5/8"	1/2"	0.35
86768	3"	5/8"	5/8"	0.40
86770	3-1/2"	5/8"	5/8"	0.60
86772	3-3/4"	5/8"	5/8"	0.70
86774	4"	5/8"	5/8"	0.75
86776	4-1/2"	5/8"	5/8"	0.85
86778	5"	5/8"	5/8"	1.10

Standard Package = 1 piece