

# Tudor Canopy



**Features**

- \* Tile effect finish
- \* Herringbone tongue & groove
- \* Attractive tile edge
- \* Choice of tile colour
- \* Optional leg brackets
- \* Easy to fit



A very attractive canopy with a lot of detail making this a beautiful addition to any home.

The Roof is available in various browns, greys or terracotta. The front has a tongue & groove finish on the underside of the vaulted soffit

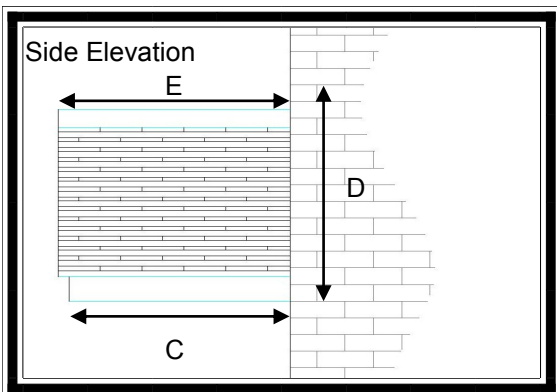
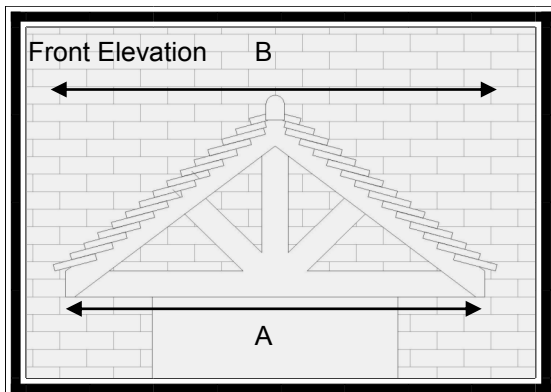

For sizes and dimension of canopies available refer to table below.

Dimensions

A	B	C	Roof Pitch	D	E
1500	1580	550	36	780(incl 70mmflashing)	600
1500	1580	800	36	780(incl 70mmflashing)	850
2000	2080	550	30	780(incl 70mmflashing)	600
2000	2080	800	30	780(incl 70mmflashing)	850