

D
C
1
2
V
(
□
□
□
□
□
D
C
2
4
4
V
□
)□
2
m
A
(
Y
-
1
3
N
O
)
□
□
2
m
A
(
Y
-
1
3
N
C
)

□ □□□ 2 □□ □□ □□□□ : Power-to-open & □□ - □□ - □□□ □□ □□, □□□ & anti-deformation.It □□□□ □, □□ □, PVC □ □ □□ □□ □□□□.



ACM-Y130 NO / NC □ □□□ □□□□□□ □□ □□□□. □ □□ □□□ □□□□ : □□ □□ □□ □□ □□ □□□□ □□ □□□□ □□ □□□□. □□□□ □□ □□ □□ □□ □□□□ □□ □□ □□□□. □□ □□□ □□ □□□ □□□□.

□ □□□□□ □□ □□ □□□□ (NC / NO) □□ □□ □ □□

03 Low temperature design

less heat is safe and reliable.



04 Low Power Design

Rated Operating Voltage: DC 12V
Current: 240mA(Fail-secure) /
120mA(Fail-safe)

05 High-quality Aluminum Case

Made of high-quality aluminum for high hardness,
corrosion resistance & anti-deformation.



- 此模块采用高品质铝材制造，ACM Goldbridge 模块采用 2 英寸铝材制造。
- 此 ACM Goldbridge 模块采用高品质铝材制造。
- 此模块采用高品质铝材制造。



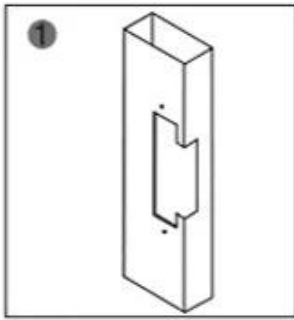

1 Cutting according to the size of the electric lock

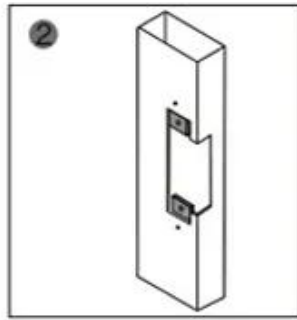

2 Insert extension plate

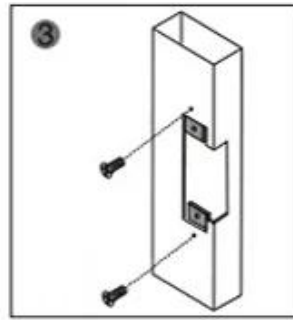

3 Fix extension plate

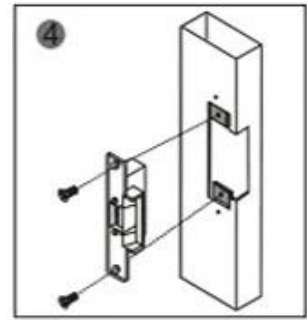

4 After installed, power on and test it

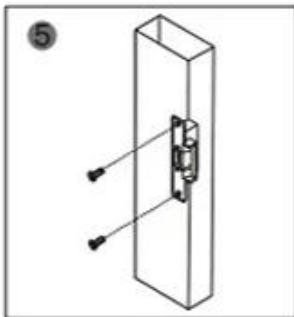

5 Fix strike lock



6 Finish

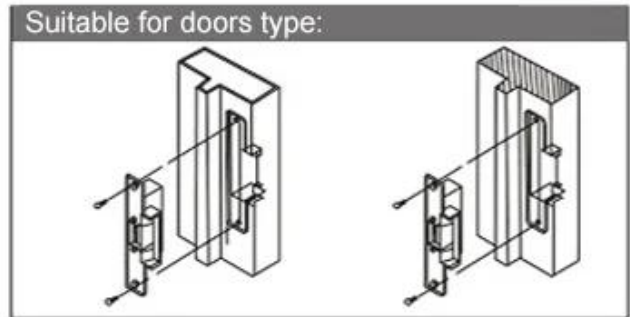

Suitable for doors type:

Metal door frame

Wooden door frame

□□ & □□

□□ □□

□□□ DHL, □□□, TNT, UPS, EMS, SEA □ By By AIR□□ □□□ □□□ □□□□ □□□□.

□□

□□ □□ □□ : □□ □ 1unit, □□ □ 50pcs,

□□ □□ : 54.5 * 20 * 30.5cm, □□□ : 20kg. □□□ □ 50 □□ □□□



You may need





ACM-Y130

□□ □□ □□ □□□□ (NC / NO) □□ □, □□ □,
PVC □

ACM-Y131

□□□□ □, □□ □, PVC □□ % s □□□□ □□ □□□
(NC / NO)

ACM-Y132

280kg (600lbs) □□ □□□□ □□ □□ : □□ □, □□
□, □□ □, □□ □.





ACM-Y280

280kg / 600lbs

ACM-Y100S

NO / NCPower

NO / NCPower

ACM-Y066

Smart Lock (130x98x41mm)

130x98x41mm

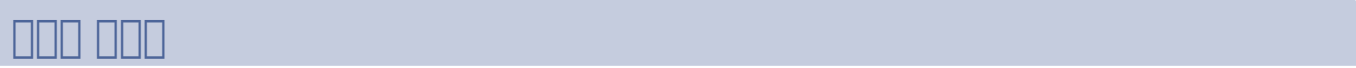

- 1, 24 hours service
- 2, OEM / ODM service
- 3, OEM / ODM service
- 4, fashin desing, & service, etc
- 5, service :
 - 1), 24 hours service
 - 2), OEM / ODM service
 - 3), 2 ~ 3 years warranty
- 6, service : 1 ~ 5 years, 7 ~ 30 years
- 7, service : T / T, Western Union, Paypal.
- 8, service : DHL, FEDEX, TNT, UPS, EMS, SEA AIR etc

