

### NOTE

3RD GENERATION PUMPS CAN BE IDENTIFIED BY THE DETACHABLE PLASTIC ELECTRICAL BOX ON TOP OF THE MOTOR, OIL DRAIN VALVE ON THE SIDE OF THE OIL BOX & A SINGLE-PIECE ROTOR INSIDE THE PUMP MECHANISM.

### KITS

KIT BILL OF MATERIALS CAN BE FOUND LISTED ON THE 'KIT COMPONENTS' PAGES IMMEDIATELY FOLLOWING CORRESPONDING PUMP PAGES.

#### MINOR REPAIR KITS

MINOR REPAIR KITS INCLUDE O-RINGS, GASKETS, SHAFT SEALS, KEYS, VALVES, DRIP PADS, COUPLING, SPRINGS, VALVES, WASHERS & OTHER COMPONENTS FOR MINOR OVERHAUL.

| MODEL(S) | PART NUMBER |
|----------|-------------|
| ALL      | 0125749     |



#### MAJOR REPAIR KITS

MAJOR REPAIR KITS INCLUDE ALL COMPONENTS OF MINOR REPAIR KITS PLUS VANES NEEDED FOR MAJOR OVERHAUL.

| MODEL(S) | PART NUMBER |
|----------|-------------|
| M 4 C    | M4CAMRK     |
| M 6 C    | M6CMRK      |
| M 8 C    | M8CBMRK     |



### FEATURED SPARES

ALL AVAILABLE SPARES FOR THIS SERIES CAN BE FOUND LISTED ON THE 'INDIVIDUAL SPARES' PAGES AT THE END OF THIS SECTION.

#### VANES

| MODEL(S) |           | PART NUMBER |
|----------|-----------|-------------|
| M 4 C    | (INTAKE)  | 616051      |
| M 4 C    | (EXHAUST) | 616052      |
| M 6 C    | (INTAKE)  | 616050      |
| M 6 C    | (EXHAUST) | 616053      |
| M 8 C    | (INTAKE)  | 616049      |
| M 8 C    | (EXHAUST) | 616052      |



#### GASKETS

| MODEL(S) |              | PART NUMBER |
|----------|--------------|-------------|
| ALL      | (CASE)       | 660199      |
| ALL      | (SHAFT SEAL) | 410643      |



#### RECOMMENDED OILS

| TYPE  | PART NUMBER |
|---|-------------|
| PLUS ULTRA GRADE 19 (1L/1.06QT) GENERAL PURPOSE | PPUG19001   |
| PLUS GOLD (1L/1.06QT) FULLY SYNTHETIC           | PPGOLD001   |
| PLUS FF (1L/1.06QT) FLUSHING FLUID              | PPFF001     |



### KIT COMPONENTS

| PART NUMBER | ITEM DESCRIPTION               | ALL - 3RD               | M4C - 3RD               | M6C - 3RD              | M8C - 3RD               |
|-------------|--------------------------------|-------------------------|-------------------------|------------------------|-------------------------|
|             |                                | MINOR REPAIR<br>0125749 | MAJOR REPAIR<br>M4CAMRK | MAJOR REPAIR<br>M6CMRK | MAJOR REPAIR<br>M8CBMRK |
| 616215      | ASSY,SEAL,SHAFT,17MM           | 1                       | 1                       | 1                      | 1                       |
| 660199      | GASKET,CASE                    | 1                       | 1                       | 1                      | 1                       |
| 616385      | GASKET,MODULE                  | 1                       | 1                       | 1                      | 1                       |
| 410643      | GASKET,SHAFT SEAL              | 1                       | 1                       | 1                      | 1                       |
| 413175      | GASKET,WASHER,NYLON            | 1                       | 1                       | 1                      | 1                       |
| 620014      | KEY,WOODRUFF,STEEL,#202        | 1                       | 1                       | 1                      | 1                       |
| 412732      | KEY,WOODRUFF,STEEL,#403        | 1                       | 1                       | 1                      | 1                       |
| 616030      | KNOB,GAS BALLAST               | 1                       | 1                       | 1                      | 1                       |
| 620118      | O'RING,SHAPED,#013             | 2                       | 2                       | 2                      | 2                       |
| 660225      | O'RING,SHAPED,RING,VITON       | 1                       | 1                       | 1                      | 1                       |
| 660194      | O'RING,VITON,158.42 X 2.62 MM  | 1                       | 1                       | 1                      | 1                       |
| 612130A     | O'RING,VITON,17.12 X 2.62 MM   | 1                       | 1                       | 1                      | 1                       |
| 412963      | O'RING,VITON,2.57 X 1.78 MM    | 2                       | 2                       | 2                      | 2                       |
| 660212      | O'RING,VITON,23.47 X 2.62 MM   | 2                       | 2                       | 2                      | 2                       |
| 660200      | O'RING,VITON,28.17 X 3.53 MM   | 1                       | 1                       | 1                      | 1                       |
| 612157A     | O'RING,VITON,3.68 X 1.78 MM    | 1                       | 1                       | 1                      | 1                       |
| 413005      | O'RING,VITON,4.47 X 1.78 MM    | 1                       | 1                       | 1                      | 1                       |
| 660204      | O'RING,VITON,58.42 X 2.62 MM   | 1                       | 1                       | 1                      | 1                       |
| 660197      | O'RING,VITON,6.07 X 1.78 MM    | 2                       | 2                       | 2                      | 2                       |
| 619282A     | O'RING,VITON,7.65 X 1.78 MM    | 1                       | 1                       | 1                      | 1                       |
| 660207      | O'RING,VITON,71.12 X 2.62 MM   | 1                       | 1                       | 1                      | 1                       |
| 619526      | O'RING,VITON,75.87 X 2.62 MM   | 1                       | 1                       | 1                      | 1                       |
| 620274      | ORFICE,HOSE BARB,.014"         | 1                       | 1                       | 1                      | 1                       |
| 616084      | PAD,DRIP,FELT                  | 1                       | 1                       | 1                      | 1                       |
| 413390      | SEAL,SHAFT,3/4"                | 1                       | 1                       | 1                      | 1                       |
| 412962      | SEAL,SHAFT,3/8"                | 1                       | 1                       | 1                      | 1                       |
| 616002      | SEAT,DRAIN VALVE,TEFLON        | 2                       | 2                       | 2                      | 2                       |
| 616038      | SPIDER,COUPLER,BUNA,BLACK      | 1                       | 1                       | 1                      | 1                       |
| 616059      | SPRING,EXHAUST VALVE,COMP,S/S  | 1                       | 1                       | 1                      | 1                       |
| 612204A     | SPRING,GAS BALLAST,COMP,S/S    | 1                       | 1                       | 1                      | 1                       |
| 619426      | SPRING,PLUNGER,COMPRESSION,S/S | 1                       | 1                       | 1                      | 1                       |
| 412996      | SPRING,VANE,COMPRESSION,S/S    | 4                       | 4                       | 4                      | 4                       |
| 616057      | VALVE,BY-PASS POPPET,INTERSTG. | 1                       | 1                       | 1                      | 1                       |
| 612118A     | VALVE,GAS BALLAST,VITON        | 1                       | 1                       | 1                      | 1                       |
| 616058      | VALVE,POPPET,EXHAUST           | 1                       | 1                       | 1                      | 1                       |
| 660117      | VALVE,PURGE,STOPPER            | 1                       | 1                       | 1                      | 1                       |
| 616052      | VANE,EXHAUST,GX                |                         | 2                       |                        | 2                       |
| 616053      | VANE,EXHAUST,GX                |                         |                         | 2                      |                         |
| 616049      | VANE,INTAKE,GX                 |                         |                         |                        | 2                       |
| 616050      | VANE,INTAKE,GX                 |                         |                         | 2                      |                         |
| 616051      | VANE,INTAKE,GX                 |                         | 2                       |                        |                         |

### NOTE

2ND GENERATION PUMPS CAN BE IDENTIFIED BY THE SQUARE METAL ELECTRICAL BOX COVER ON TOP OF THE MOTOR, OIL DRAIN VALVE AT THE CENTER OF THE OIL BOX & A SINGLE-PIECE ROTOR INSIDE THE PUMP MECHANISM.

### KITS

KIT BILL OF MATERIALS CAN BE FOUND LISTED ON THE 'KIT COMPONENTS' PAGES IMMEDIATELY FOLLOWING CORRESPONDING PUMP PAGES.

#### MINOR REPAIR KITS

MINOR REPAIR KITS INCLUDE O-RINGS, GASKETS, SHAFT SEALS, KEYS, VALVES, DRIP PADS, COUPLING, SPRINGS, WASHERS & OTHER COMPONENTS FOR MINOR OVERHAUL.

| MODEL(S) | PART NUMBER |
|----------|-------------|
| M 2/4 C  | 0125717A    |
| M 8/12 C | 0125717B    |



#### MAJOR REPAIR KITS

MAJOR REPAIR KITS INCLUDE ALL COMPONENTS OF MINOR REPAIR KITS PLUS VANES FOR MAJOR OVERHAUL.

| MODEL(S) | PART NUMBER |
|----------|-------------|
| M 2 C    | M2CMRK      |
| M 4 C    | M4CMRK      |
| M 8 C    | M8CAMRK     |
| M 12 C   | M12CAMRK    |



### FEATURED SPARES

ALL AVAILABLE SPARES FOR THIS SERIES CAN BE FOUND LISTED ON THE 'INDIVIDUAL SPARES' PAGES AT THE END OF THIS SECTION.

#### VANES

| MODEL(S) |           | PART NUMBER |
|----------|-----------|-------------|
| M 2/4 C  | (INTAKE)  | 612178A     |
| M 2/4 C  | (EXHAUST) | 612179A     |
| M 8 C    | (INTAKE)  | 619538B     |
| M 8 C    | (EXHAUST) | 619615A     |
| M 12 C   | (INTAKE)  | 619616B     |
| M 12 C   | (EXHAUST) | 619615A     |



#### GASKETS

| MODEL(S) |              | PART NUMBER |
|----------|--------------|-------------|
| M 2/4 C  | (CASE)       | 612149B     |
| M 8/12 C | (CASE)       | 619609B     |
| M 12 C   | (SHAFT SEAL) | 410643      |



#### RECOMMENDED OILS

| TYPE  | PART NUMBER |
|---|-------------|
| PLUS ULTRA GRADE 19 (1L/1.06QT) GENERAL PURPOSE | PPUG19001   |
| PLUS GOLD (1L/1.06QT) FULLY SYNTHETIC           | PPGOLD001   |
| PLUS FF (1L/1.06QT) FLUSHING FLUID              | PPFF001     |



### KIT COMPONENTS

| PART NUMBER | ITEM DESCRIPTION              | M2C/4C<br>MINOR<br>0125717A | M2C - 2ND<br>MAJOR<br>M2CMRK | M4C - 2ND<br>MAJOR<br>M4CMRK | M8C/12C<br>MINOR<br>0125717B | M8C - 2ND<br>MAJOR<br>M8CAMRK | M12C - 2ND<br>MAJOR<br>M12CAMRK |
|-------------|-------------------------------|-----------------------------|------------------------------|------------------------------|------------------------------|-------------------------------|---------------------------------|
| 612149B     | GASKET,CASE                   | 1                           | 1                            | 1                            |                              |                               |                                 |
| 619609B     | GASKET,PUMP,BEADED            |                             |                              |                              | 1                            | 1                             | 1                               |
| 410624      | KEY,WOODRUFF,CUT              |                             |                              |                              | 1                            | 1                             | 1                               |
| 411401D-01  | KIT,SHAFT SEAL,.750"          |                             |                              |                              | 1                            | 1                             | 1                               |
| 620118      | O'RING,SHAPED,#013            |                             |                              |                              | 2                            | 2                             | 2                               |
| 612231      | O'RING,SHAPED,RING,VITON      | 1                           | 1                            | 1                            | 1                            | 1                             | 1                               |
| 612162A     | O'RING,VITON,14 X 1.78 MM     | 1                           | 1                            | 1                            |                              |                               |                                 |
| 612130A     | O'RING,VITON,17.12 X 2.62 MM  | 2                           | 2                            | 2                            | 1                            | 1                             | 1                               |
| 612159A     | O'RING,VITON,18.72 X 2.62 MM  | 1                           | 1                            | 1                            |                              |                               |                                 |
| 612155A     | O'RING,VITON,21.95 X 1.78 MM  | 1                           | 1                            | 1                            |                              |                               |                                 |
| 619284A     | O'RING,VITON,24.99 X 3.53 MM  |                             |                              |                              | 1                            | 1                             | 1                               |
| 620211      | O'RING,VITON,26.70 X 1.78 MM  |                             |                              |                              | 1                            | 1                             | 1                               |
| 612157A     | O'RING,VITON,3.68 X 1.78 MM   |                             |                              |                              | 1                            | 1                             | 1                               |
| 413005      | O'RING,VITON,4.47 X 1.78 MM   | 2                           | 2                            | 2                            | 1                            | 1                             | 1                               |
| 619527      | O'RING,VITON,52.07 X 2.62 MM  |                             |                              |                              | 1                            | 1                             | 1                               |
| 612128A     | O'RING,VITON,64.77 X 2.62 MM  | 2                           | 2                            | 2                            |                              |                               |                                 |
| 619282A     | O'RING,VITON,7.65 X 1.78 MM   | 1                           | 1                            | 1                            | 1                            | 1                             | 1                               |
| 619526      | O'RING,VITON,75.87 X 2.62 MM  |                             |                              |                              | 1                            | 1                             | 1                               |
| 611178A     | ORIFICE,BRASS,.010"           | 1                           | 1                            | 1                            |                              |                               |                                 |
| 619742      | PAD,DRIP,FELT                 |                             |                              |                              | 1                            | 1                             | 1                               |
| 619743      | PAD,DRIP,FELT                 | 1                           | 1                            | 1                            |                              |                               |                                 |
| 413390      | SEAL,SHAFT,3/4"               |                             |                              |                              | 1                            | 1                             | 1                               |
| 412988      | SEAL,SHAFT,5/8"               | 2                           | 2                            | 2                            |                              |                               |                                 |
| 413073      | SLEEVE,COUPLING               |                             |                              |                              | 1                            | 1                             | 1                               |
| 412694      | SPIDER,COUPLING,BUNA,BLACK    | 1                           | 1                            | 1                            |                              |                               |                                 |
| 619561A     | SPRING,EXHAUST VALVE,COMP,S/S |                             |                              |                              | 1                            | 1                             | 1                               |
| 612204A     | SPRING,GAS BALLAST,COMP,S/S   | 1                           | 1                            | 1                            | 1                            | 1                             | 1                               |
| 619582A     | SPRING,VALVE BYPASS,COMP,S/S  |                             |                              |                              | 2                            | 2                             | 2                               |
| 612119A     | SPRING,VALVE,COMPRESSION,S/S  | 2                           | 2                            | 2                            |                              |                               |                                 |
| 611128A     | VALVE,BACKER                  | 1                           | 1                            | 1                            |                              |                               |                                 |
| 619560A     | VALVE,BY-PASS,EXHAUST         |                             |                              |                              | 3                            | 3                             | 3                               |
| 612118A     | VALVE,GAS BALLAST,VITON       | 2                           | 2                            | 2                            | 1                            | 1                             | 1                               |
| 611123A     | VALVE,INTAKE                  | 1                           | 1                            | 1                            |                              |                               |                                 |
| 612139A     | VALVE,ISOLATION DISK,BUNA     | 1                           | 1                            | 1                            |                              |                               |                                 |
| 660117      | VALVE,PURGE,STOPPER           | 1                           | 1                            | 1                            |                              |                               |                                 |
| 612179A     | VANE,EXHAUST,GX               |                             | 2                            | 2                            |                              |                               |                                 |
| 619615A     | VANE,EXHAUST,GX               |                             |                              |                              |                              | 2                             | 2                               |
| 612178A     | VANE,INTAKE,GX                |                             | 2                            | 2                            |                              |                               |                                 |
| 619538B     | VANE,INTAKE,GX                |                             |                              |                              |                              | 2                             |                                 |
| 619616B     | VANE,INTAKE,GX                |                             |                              |                              |                              |                               | 2                               |



### NOTE

1ST GENERATION PUMPS CAN BE IDENTIFIED BY THE ROUND METAL ELECTRICAL BOX COVER & A TWO-PIECE ROTOR INSIDE THE PUMP MECHANISM.

### KITS

KIT BILL OF MATERIALS CAN BE FOUND LISTED ON THE 'KIT COMPONENTS' PAGES IMMEDIATELY FOLLOWING CORRESPONDING PUMP PAGES.

#### MINOR REPAIR KITS

MINOR REPAIR KITS INCLUDE O-RINGS, GASKETS, SHAFT SEALS, KEYS, VALVES, DRIP PADS, COUPLING, SPRINGS, WASHERS & OTHER COMPONENTS FOR MINOR OVERHAUL.

| MODEL(S) | PART NUMBER |
|----------|-------------|
| M 8/12 C | 619932      |
| M 16 C   | 0125717C    |

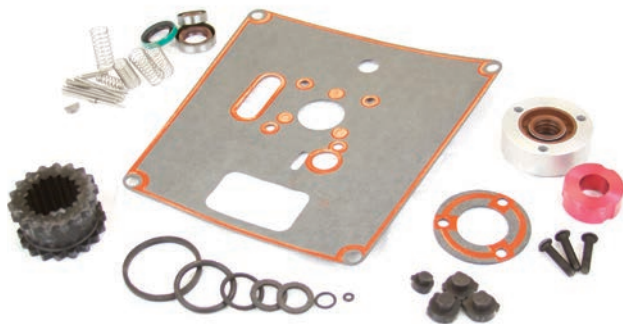

#### MAJOR REPAIR KITS

MAJOR REPAIR KITS INCLUDE ALL COMPONENTS OF MINOR REPAIR KITS PLUS VANES FOR MAJOR OVERHAUL.

| MODEL(S) | PART NUMBER |
|----------|-------------|
| M 8 C    | M8CMRK      |
| M 12 C   | M12CMRK     |
| M 16 C   | M16CMRK     |



### FEATURED SPARES

ALL AVAILABLE SPARES FOR THIS SERIES CAN BE FOUND LISTED ON THE 'INDIVIDUAL SPARES' PAGES AT THE END OF THIS SECTION.

#### VANES

| MODEL(S) |           | PART NUMBER |
|----------|-----------|-------------|
| M 8 C    | (INTAKE)  | 413479      |
| M 8 C    | (EXHAUST) | 413327      |
| M 12 C   | (INTAKE)  | 413329      |
| M 12 C   | (EXHAUST) | 413327      |
| M 16 C   | (INTAKE)  | 619571B     |
| M 16 C   | (EXHAUST) | 619570A     |



#### GASKETS

| MODEL(S) |              | PART NUMBER |
|----------|--------------|-------------|
| M 8/12 C | (CASE)       | 619637B     |
| M 16 C   | (CASE)       | 619609B     |
| ALL      | (SHAFT SEAL) | 410643      |



#### RECOMMENDED OILS

| TYPE   | PART NUMBER |
|--|-------------|
| PLUS ULTRA GRADE 19 (1L/1.06QT)<br>GENERAL PURPOSE | PPUG19001   |
| PLUS GOLD (1L/1.06QT)<br>FULLY SYNTHETIC           | PPGOLD001   |
| PLUS FF (1L/1.06QT)<br>FLUSHING FLUID              | PPFF001     |



### KIT COMPONENTS

| PART NUMBER | ITEM DESCRIPTION               | M8C/12C<br>MINOR<br>619932 | M8C - 1ST<br>MAJOR<br>M8CMRK | M12C - 1ST<br>MAJOR<br>M12CMRK | M16C - 1ST<br>MINOR<br>0125717C | M16 - 1ST<br>MAJOR<br>M16CMRK |
|-------------|--------------------------------|----------------------------|------------------------------|--------------------------------|---------------------------------|-------------------------------|
| 619637B     | GASKET,PUMP                    | 1                          | 1                            | 1                              |                                 |                               |
| 619609B     | GASKET,PUMP,BEADED             |                            |                              |                                | 1                               | 1                             |
| 619418B     | GASKET,SPECIAL,FOR REPAIR KIT  |                            |                              |                                | 1                               | 1                             |
| 619916      | GASKET,SPECIAL,FOR REPAIR KIT  |                            |                              |                                | 1                               | 1                             |
| 413175      | GASKET,WASHER,NYLON            |                            |                              |                                | 1                               | 1                             |
| 612229A     | GLASS,SIGHT,OIL                |                            |                              |                                | 1                               | 1                             |
| 412969      | HOLDER,SPRING                  | 1                          | 1                            | 1                              |                                 |                               |
| 412732      | KEY,WOODRUFF,STEEL,#403        | 1                          | 1                            | 1                              |                                 |                               |
| 411401E-01  | KIT,SHAFT SEAL,.625"           | 1                          | 1                            | 1                              |                                 |                               |
| 411401D-01  | KIT,SHAFT SEAL,.750"           |                            |                              |                                | 1                               | 1                             |
| 620118      | O'RING,SHAPED,#013             |                            |                              |                                | 2                               | 2                             |
| 612231      | O'RING,SHAPED,RING,VITON       | 1                          | 1                            | 1                              | 1                               | 1                             |
| 612130A     | O'RING,VITON,17.12 X 2.62 MM   | 1                          | 1                            | 1                              | 1                               | 1                             |
| 412963      | O'RING,VITON,2.57 X 1.78 MM    | 1                          | 1                            | 1                              |                                 |                               |
| 619284A     | O'RING,VITON,24.99 X 3.53 MM   | 1                          | 1                            | 1                              |                                 |                               |
| 660200      | O'RING,VITON,28.17 X 3.53 MM   |                            |                              |                                | 1                               | 1                             |
| 612157A     | O'RING,VITON,3.68 X 1.78 MM    |                            |                              |                                | 1                               | 1                             |
| 413005      | O'RING,VITON,4.47 X 1.78 MM    |                            |                              |                                | 1                               | 1                             |
| 619379      | O'RING,VITON,55.25 X 2.62 MM   |                            |                              |                                | 1                               | 1                             |
| 619282A     | O'RING,VITON,7.65 X 1.78 MM    | 1                          | 1                            | 1                              | 1                               | 1                             |
| 619378      | O'RING,VITON,82.22 X 2.62 MM   |                            |                              |                                | 1                               | 1                             |
| 619742      | PAD,DRIP,FELT                  |                            |                              |                                | 1                               | 1                             |
| 616091      | PLUNGER,OIL FEED,EXHAUST       |                            |                              |                                | 1                               | 1                             |
| 412977      | SEAL,SHAFT,.625",BUNA          | 1                          | 1                            | 1                              |                                 |                               |
| 413390      | SEAL,SHAFT,3/4"                |                            |                              |                                | 1                               | 1                             |
| 412962      | SEAL,SHAFT,3/8"                | 1                          | 1                            | 1                              | 1                               | 1                             |
| 412988      | SEAL,SHAFT,5/8"                | 1                          | 1                            | 1                              |                                 |                               |
| 413073      | SLEEVE,COUPLING                | 1                          | 1                            | 1                              | 1                               | 1                             |
| 619385A     | SPRING,BYPASS VALVE,COMP.,S/S  | 3                          | 3                            | 3                              |                                 |                               |
| 619561A     | SPRING,EXHAUST VALVE,COMP.,S/S |                            |                              |                                | 1                               | 1                             |
| 612204A     | SPRING,GAS BALLAST,COMP.,S/S   | 1                          | 1                            | 1                              | 1                               | 1                             |
| 619388A     | SPRING,RELIEF,COMPRESSION,S/S  | 1                          | 1                            | 1                              |                                 |                               |
| 619582A     | SPRING,VALVE BYPASS,COMP.,S/S  |                            |                              |                                | 2                               | 2                             |
| 412972      | SPRING,VANE,COMP.,PLT. STL.    | 2                          | 2                            | 2                              |                                 |                               |
| 412996      | SPRING,VANE,COMPRESSION,S/S    | 4                          | 4                            | 4                              | 5                               | 5                             |
| 619560A     | VALVE,BY-PASS,EXHAUST          |                            |                              |                                | 3                               | 3                             |
| 619371A     | VALVE,BYPASS,C-0599            | 3                          | 3                            | 3                              |                                 |                               |
| 612118A     | VALVE,GAS BALLAST,VITON        | 1                          | 1                            | 1                              | 1                               | 1                             |
| 413327      | VANE,EXHAUST,GX                |                            | 2                            | 2                              |                                 |                               |
| 619570A     | VANE,EXHAUST,GX                |                            |                              |                                |                                 | 2                             |
| 413329      | VANE,INTAKE,GX                 |                            |                              | 2                              |                                 |                               |
| 413479      | VANE,INTAKE,GX                 |                            | 2                            |                                |                                 |                               |
| 619571B     | VANE,INTAKE,GX                 |                            |                              |                                |                                 | 2                             |
| 660103      | WASHER,RUBBER,VITON            | 2                          | 2                            | 2                              |                                 |                               |
| 412678      | WASHER,THRUST                  |                            |                              |                                | 1                               | 1                             |

**INDIVIDUAL SPARES**

**KITS**

|          |                               |             |
|----------|-------------------------------|-------------|
| 0125749  | KIT,MINOR,REPAIR              | M4C,M6C,M8C |
| M12CAMRK | KIT MAJOR REPAIR GX NEW STYLE | M12C        |
| M12CMRK  | KIT MAJOR REPAIR GX OLD STYLE | M12C        |
| M16CAMRK | KIT MAJOR REPAIR GX           | M16C        |
| M2CAMRK  | KIT MAJOR REPAIR GX           | M2C         |
| M4CAMRK  | KIT,MAJOR,REPAIR,GX,NEW STYLE | M4C         |
| M4CMRK   | KIT,MAJOR,REPAIR,GX,OLD STYLE | M4C         |
| M6CAMRK  | KIT,MAJOR,REPAIR,GX           | M6C         |
| M8CAMRK  | KIT MAJOR REPAIR GX 2ND STYLE | M8C         |
| M8CBMRK  | KIT MAJOR REPAIR GX NEW STYLE | M8C         |
| M8CMRK   | KIT MAJOR REPAIR GX OLD STYLE | M8C         |



*THIS PAGE IS  
INTENTIONALLY LEFT BLANK*