

2 RV pump with 1-phase motor parts list

RV pump with 1-phase motor parts list

Figure 1 - Exploded view of the RV pump with 1-phase motor

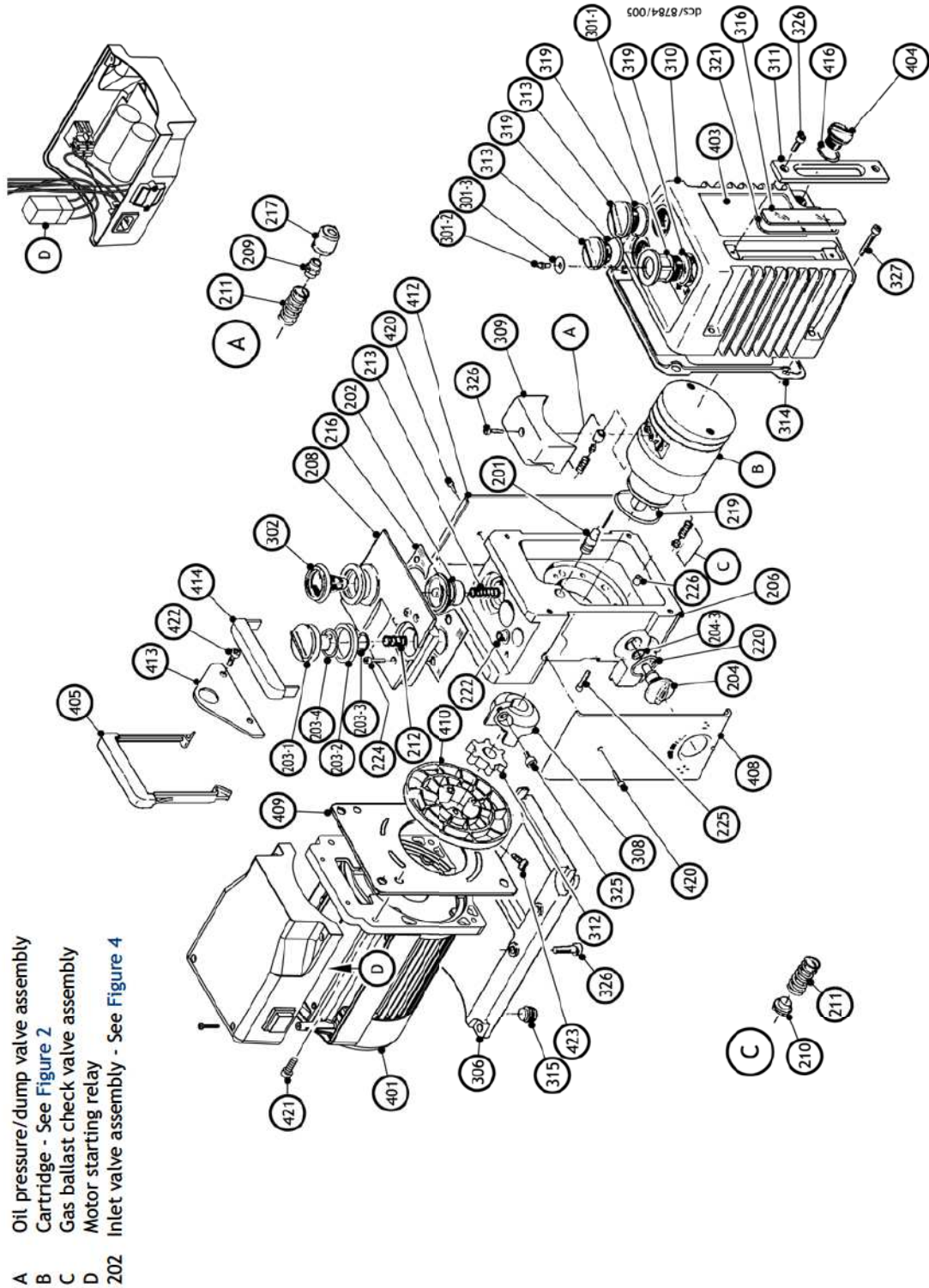

- A Oil pressure/dump valve assembly
- B Cartridge - See Figure 2
- C Gas ballast check valve assembly
- D Motor starting relay
- 202 Inlet valve assembly - See Figure 4

RV pump with 1-phase motor parts list

Table 2 - Parts list

Ref	Description	Fig	Qty	Kit No.(s)	Item Number
101	HV stator RV3	2	1	6	A652-01-700
101	HV stator RV5	2	1	7	A653-01-700
101	HV stator RV8	2	1	8	A654-01-700
101	HV stator RV12	2	1	9	A655-01-700
102	HV rotor RV3/RV5	2	1	6, 7	A652-01-701
102	HV rotor RV8	2	1	8	A654-01-701
102	HV rotor RV12	2	1	9	A655-01-701
103	LV stator RV3/RV5	2	1	6, 7	A652-01-702*
103	LV stator RV8/RV12	2	1	8, 9	A654-01-702*
104	LV rotor RV3/RV5	2	1	6, 7	A652-01-703
104	LV rotor RV8/RV12	2	1	8, 9	A654-01-703
105	Oil pump stator	2	1	20	*
106	Oil pump stator	2	1	20	A652-01-705
107	End Plate	2	1	6 - 9	A652-01-704
108	Oldham coupling (H.V.-L.V.)	2	1	6 - 9	A652-01-026
109	Shaft-seal sleeve	2	1	6 - 9, 13	
110	Seal carrier	2	1	6 - 9, 12	
111	Reed valve	2	1	6 - 9	A652-01-029
115	Oil pump blade	2	1	2 - 9, 20	
116	HV blade	2	2	2 - 9	
117	LV blade	2	2	2 - 9	
118	Reed valve clamp	2	1	6 - 9	A210-35-129
119	Oldham coupling (LV-oil pump)	2	1	6 - 9	A259-08-127
120	Printed gasket (seal carrier)	2	1	1, 6 - 9, 12	A271-60-008
123	Shaft seal (inner): 25 x 35 x 7	2	1	1, 6 - 9	H021-09-155
124	Shaft seal (outer): 20 x 30 x 5	2	1	1, 6 - 9, 12	H021-09-154
125	O-ring: 14.6 i.d. x 2.4 section (rotor sleeve)	2	1	6 - 9, 13	
129	Screw: cap-head M6 x 20 (seal carrier securing)	2	3	6 - 9	
130	Screw: cap-head M6 x 40 (end cover securing and LV to HV securing)	2	4	6 - 9	
201	Air bleed assembly	1	1	1	A652-01-005
202	Inlet valve assembly	1	1	10	
202-1	Valve cover	4	1	10	
202-2	Piston	4	1	10	
202-3	Valve pad	4	1	10	
202-4	Bush	4	1	10	
202-5	'U' seal	4	1	1, 6 - 10	
202-6	O-ring: 49.5 i.d. x 3.0 section	4	1	1, 6 - 10	23724-071

* On pumps with serial number 97 21 29 224 and earlier all items marked thus (LV Stator and Oil Pump Stator) must be replaced at the same time. On pumps with later serial numbers parts may be replaced individually. If you fail to observe this practice, the pump will not operate.