

MAKE A STATEMENT

Holiday Parties



Whether you're looking to host an elegant gala or a fun-filled holiday party, allow us to host your event in our one-of-a-kind venue. Cocktails on the canal? An awards banquet in our Great Hall? The possibilities are endless!

DETAILS

- To book your event, a 50% facility rental deposit is required along with a signed contract. A check, American Express, MasterCard or Visa are accepted forms of payment.
- Your booking is confirmed upon receiving both signed agreements and deposits for the Indiana State Museum and Kahn's Catering.
- We offer 6-hour rentals beginning at 5:30 p.m. To extend the time at the end of your event, the fee is \$400 per hour.
- Parking is available in the White River State Park garage. There are two options to choose from:
 1. Guests pay discounted rate
 2. Client prepays for parkingSpaces are not guaranteed. No refunds.
- A/V equipment and special lighting available for additional fee.
- A certificate of insurance is required for all rental events at the Indiana State Museum.
- The museum at times could be considered under structural or cosmetic construction. Structural and/or cosmetic changes to the facility and its grounds include but are not limited to gallery closures, improvements to landscape, installation of art, etc. In the best efforts of the facility, plans will be communicated as early as possible to the client.
- Security is included.
- In-house tables and chairs included in rental.
- Discounts may be available. Check with your event manager for details.

HOW IT WORKS

1. Confirm your date and space for your event with your ISM event planner.
2. Your ISM event planner will send you contracts for ISM and Kahn's Catering to lock in your date and spaces.
3. Once you have signed your agreements and paid your deposits, it is time to start planning your event!

SOCIAL



@ISMRentals



Indiana State Museum Facility Rentals



@ISMRentals

CONTACT

Erica Leigh-Ann Montgomery

Director of Facility Rentals and Retail Operations

c: 317.619.2705

e: emontgomery@indianamuseum.org

Beth Breymier

Manager, Sales and Events

c: 317.409.8217

e: bbreymier@indianamuseum.org

Melissa Velasquez

Event Planner

e: mvelasquez1@indianamuseum.org

For more information, please contact eventplanning@indianamuseum.org.
[indianamuseum.org/host-an-event](https://www.indianamuseum.org/host-an-event)

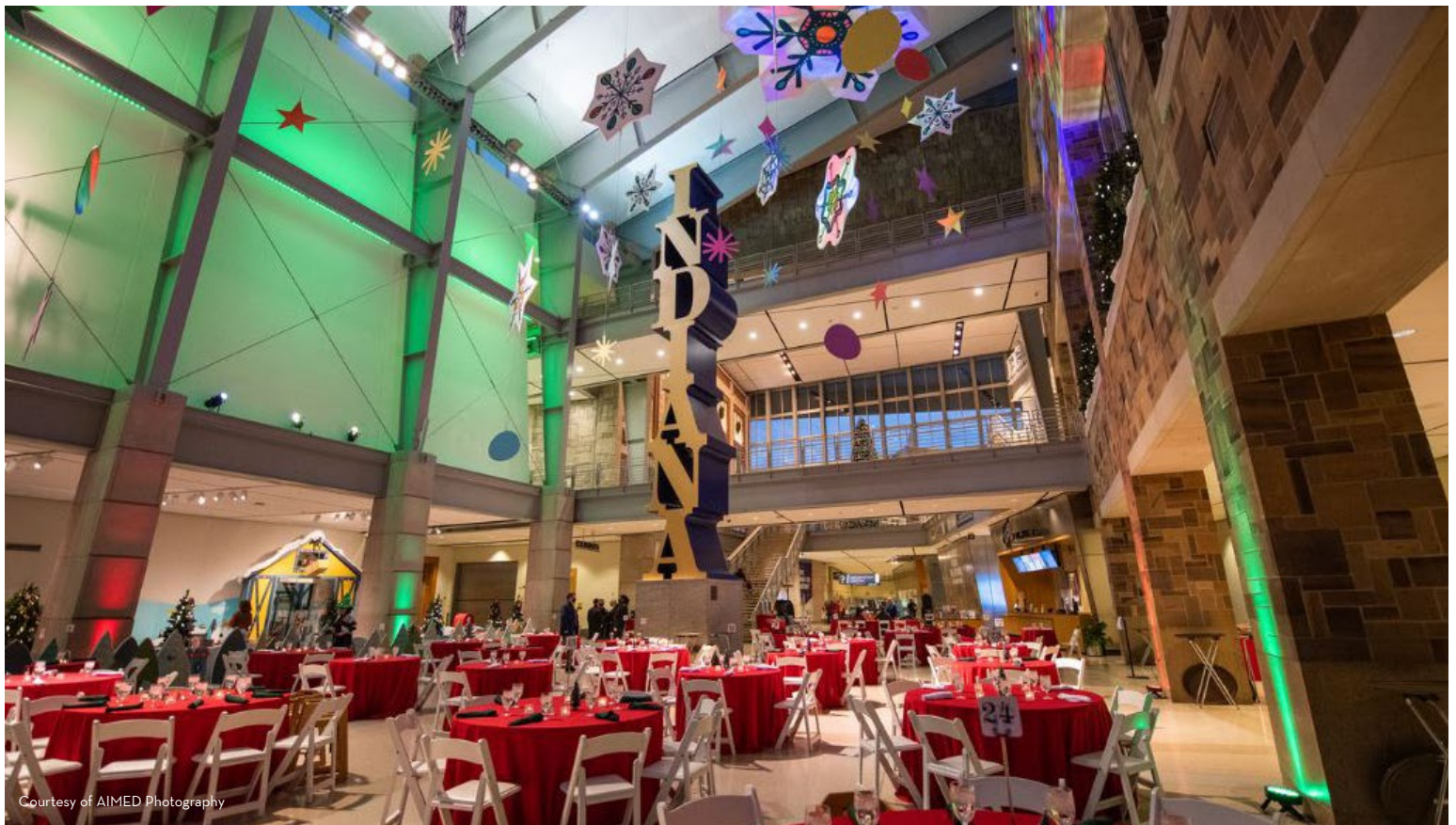

Courtesy of AIMED Photography

GOVERNOR FRANK & JUDY O'BANNON GREAT HALL AND BALL FAMILY TERRACE

The iconic INDIANA obelisk graces the center of the Great Hall, lending elegance and unmistakable Hoosier presence to your event. With the canal flowing outside and the breathtaking architecture indoors, this is the ideal space for a memorable event. The adjacent Ball Family Terrace is included in rental of the Great Hall and provides guests with spectacular views of the canal, Military Park and the downtown Indianapolis skyline.

CAPACITY

Accommodates 250 for a seated dinner with dancing, 300 for a seated dinner without dancing, 500 for cocktail reception

PRICING

| | Sun.-Thurs. | Friday | Saturday |
|------------------|-------------|---------|----------|
| Holiday Rates | \$4,000 | \$4,000 | \$4,000 |
| Food & Bev. Min. | \$5,000 | \$7,500 | \$10,000 |

ADDITIONAL ADD-ON ITEMS

- Celebration Crossing Experience (Includes Santa & Train) = \$500 per hour (2-hour minimum)
- Level 1 Galleries = \$400 per hour (2-hour minimum)
- Level 2 Galleries = \$300 per hour (2-hour minimum)