

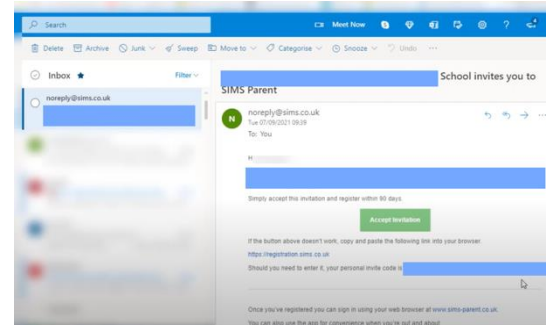

# Registering for SIMS Parent

**Step 1:** You will require an invitation code (sent to the email address provided in the Data Capture Form) to register first.



- This email will also contain the web link taking you to the SIMS Registration Site <https://registration.sims.co.uk>  
Once registered, the login in web link is <https://www.sims-parent.co.uk>

**Step 2:** During registration you should only use the Use External Account Option, scrolling past the “Enter email address” or “Username” on 2 occasions.

**Step 3:** When registering, choose 1 of the External Account Options such as Google, Microsoft (inc Hotmail) and Social Media. SIMS Parent does not use your account to post content; it simply uses it as your common login username and password. I.e. If you choose Google, it will be your usual Gmail email address and password.

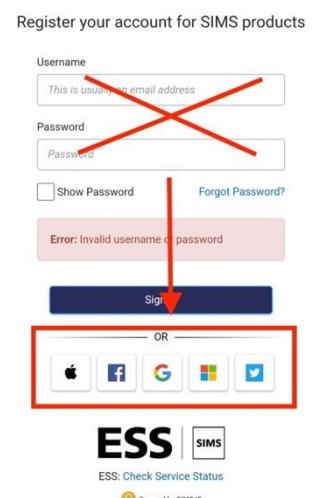
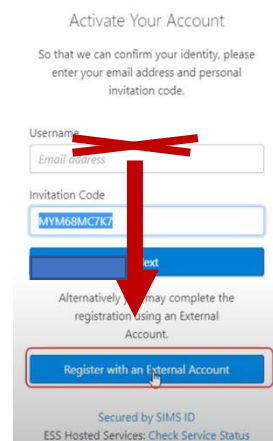

**Step 4:** The Security Question is usually the DOB of the **Eldest child** at LGS in the format of **dd/mm/yyyy**

- If you forget your password, it will be your External Account Organisation that you will contact.
- **Step 5:** Once Registered, check your External Account Inbox, Spam or Junk folder for a Verification email. You might need to click “Verify Account” to complete the registration process.



Video Tutorial

# Accessing SIMS Parent

## Setting up the SIMS Parent App

**Step 1:** Go to the Google Play store or the Apple store and search for SIMS Parent

**Step 2:** Install the App

**Step 3:** Open the App



Google Playstore



Apple App store



**Step 4:** After the welcome screen you might get the Sign In page. If so then click on the Sign In button which will take you back to the page that you saw during registration. On the Choose Account Type page select the option you registered with and login using your credentials

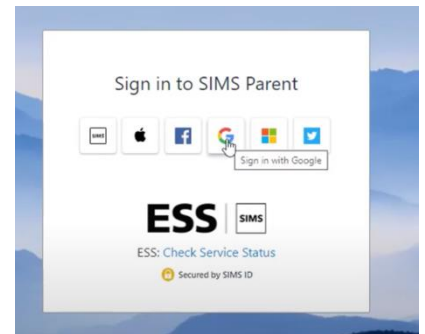

**Step 5:** The Parent App welcome screen opens.

From here you can view reports, request updates to contact information, view timetables and see attendance information.

## Signing into SIMS Parent via web browser

**Step 1:** The web version of the Parent App which can be accessed from <https://www.sims-parent.co.uk>

**Step 2:** Click on the Sign In button

**Step 3:** On the Choose Account Type page select the option you registered with and login using your credentials

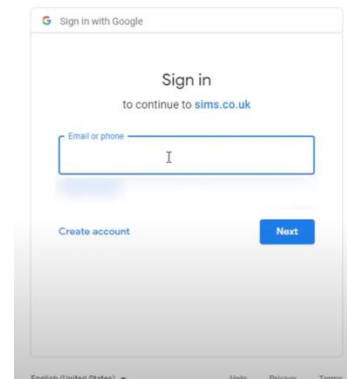

From here you can view reports, request updates to contact information, view timetables and see attendance information.

