

# Function Room Three



A versatile and functional room that can be used for meetings, workshops, or breakout space.



SUPPORTED BY



AFFILIATED WITH



Registered Number 1368325 | Charity Registration Number 275961

**| Different every day**

# Function Room Three

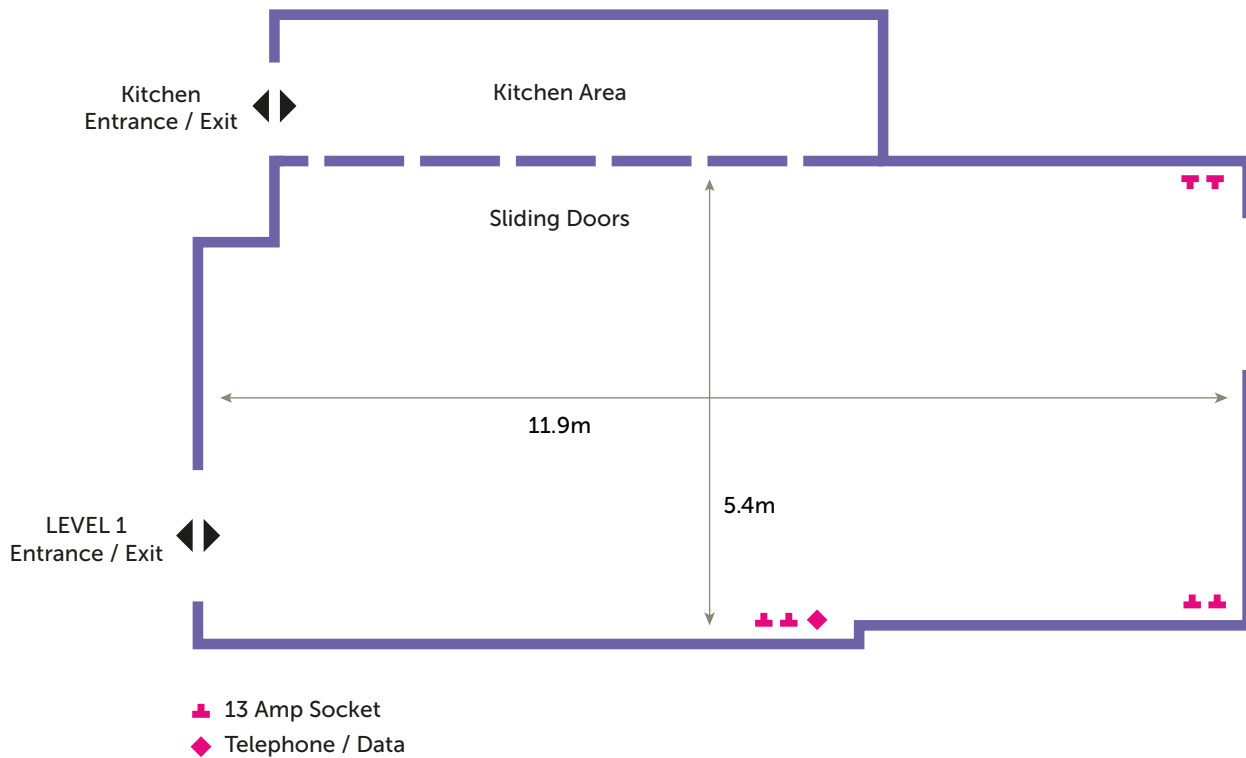

Full technical specification in request

## LEVEL

Level in building **1**

## TYPE OF ROOM /SPACE

Meetings  
Rehearsals  
Receptions

## DIMENSIONS (M)

Total square area [sq m] **64.26**  
 Max length **11.9m**  
 Maximum width **5.4m**

## CAPACITIES

Boardroom **15**  
 U-shaped **15**  
 Classroom **20**  
 Theatre style **40**  
 Drinks reception (no tables) **60**  
 Drinks reception (tables) **50**  
 Max (no furniture) **70**

## LIGHTING

Natural Light **Yes**  
 Blackout possible **Partial**  
 Dimmable lighting **Yes**

## POWER

13 amp sockets **4**

## TECH

50 inch LED display screen  
 In ceiling PA System  
 VGA, HDMI presenting capability  
 Infrared hearing loop system  
 2 microphones  
 Extra Equipment available  
 Dedicated conference wifi

## ACCESS

Direct street level load in **Ramped**  
 Direct lorry level load in **No**  
 Min load in aperture **1.5m x2.4m**  
 Wheelchair access **Yes**  
 Disabled toilets **Yes**  
 Lift to foyers **Yes x 2**  
 Toilet facilities (in room) **No**  
 Toilet facilities (in suite of rooms) **Yes**

For details about hiring this space, please contact our Corporate Development Executive on **01202 781319** or email [lucy.funnell@lighthousepoole.co.uk](mailto:lucy.funnell@lighthousepoole.co.uk)

SUPPORTED BY



AFFILIATED WITH



Registered Number 1368325 | Charity Registration Number 275961

**| Different every day**

# Function Room Three



For details about hiring this space, please contact our Corporate Development Executive on **01202 781319** or email [lucy.funnell@lighthousepoole.co.uk](mailto:lucy.funnell@lighthousepoole.co.uk)