

PolyCare®



**PolyCare®**

The Service Plan That Fits  
Product Brochure

## Dear Valued Customer,

We at Polytec believe that customer satisfaction goes hand in hand with the ultimate measurement experience, outstanding customer service and well trained users who are able to use their equipment to its fullest extent. With this in mind we have created two new programs **PolyCare®** and **Up2date**. Please read more in this brochure and our website or call one of our solution specialists.

Yours sincerely,



Michael Frech  
President



### What is PolyCare® and what are its benefits?

Optical systems such as Laser Vibrometers and White Light Interferometers should be maintained, cleaned and calibrated on a regular basis. For your convenience we offer an on-site service when your Polytec system is due, which means almost no downtime, eliminating the need to ship your equipment to one of our service centers. Your system will be automatically included in **PolyCare®** after your next System Maintenance & Calibration.

**PolyCare®** offers two major benefits: First, you will receive all necessary repairs\* at no cost for 2 years ensuring that your system is working properly and second, your system will qualify for our software update program **Up2date**.

### What is Up2date?

**Up2date** is a new program for all users of systems that run Polytec software. As long as the system is covered by **PolyCare®** it qualifies for Up2date and can receive Polytec software at no charge.

### This requires only 2 simple steps on your side:

**Step 1:** System is covered under PolyCare®.

**Step 2:** Attend one of our qualified trainings every other year.

## PolyCare® comes with many benefits.



### **PolyCare® & PolyCare® Plus**

As long as we maintain and calibrate your system on a regular basis\* there is no need to allocate additional budget for most unforeseen repairs\* because you are automatically covered by our PolyCare® program. Sign up for Poly-Care Plus and we will extend that coverage to also include parts associated with wear & tear.



### **Up2date**

Every system under PolyCare® or PolyCare® Plus qualifies for Up2date after you have attended one of our qualified trainings. With this, you will receive the latest Polytec Software, as long as your Data Management System (DMS) fulfills the current system requirements\*. As a part of the Up2date, a special DMS replacement package is available.



### **Polytec Certified**

As long as the system is under PolyCare® and PolyCare® Plus it is considered "Polytec Certified" and when the time comes, you will qualify for a higher trade-in value.



## PolyCare® – Peace of Mind

- As long as the system is maintained and calibrated in an ongoing 2 year cycle, the PolyCare® coverage can be extended, up to 7 years of age.
- Contact us to learn if your system qualifies for PolyCare®.

1

## PolyCare® Plus – Even More

- PolyCare® Plus includes all components of PolyCare®, plus all wear & tear parts such as the laser & power supply.

1+

## Up2date – Get the Most out of Your Polytec Equipment

- Systems covered by PolyCare® or PolyCare® Plus qualify for our industry-unique Up2date program. By attending just ONE training session every other year your Polytec Software will be kept up-to-date.
- Special DMS replacement pricing.

2

## Pre-paid Programs

- Complete pre-paid programs are available.

P

➔ Phone +1 949-943-3033  
[www.polytec.com/polycare](http://www.polytec.com/polycare)

Please call us to talk to one of our solution specialists regarding pricing and to find out if your system qualifies.



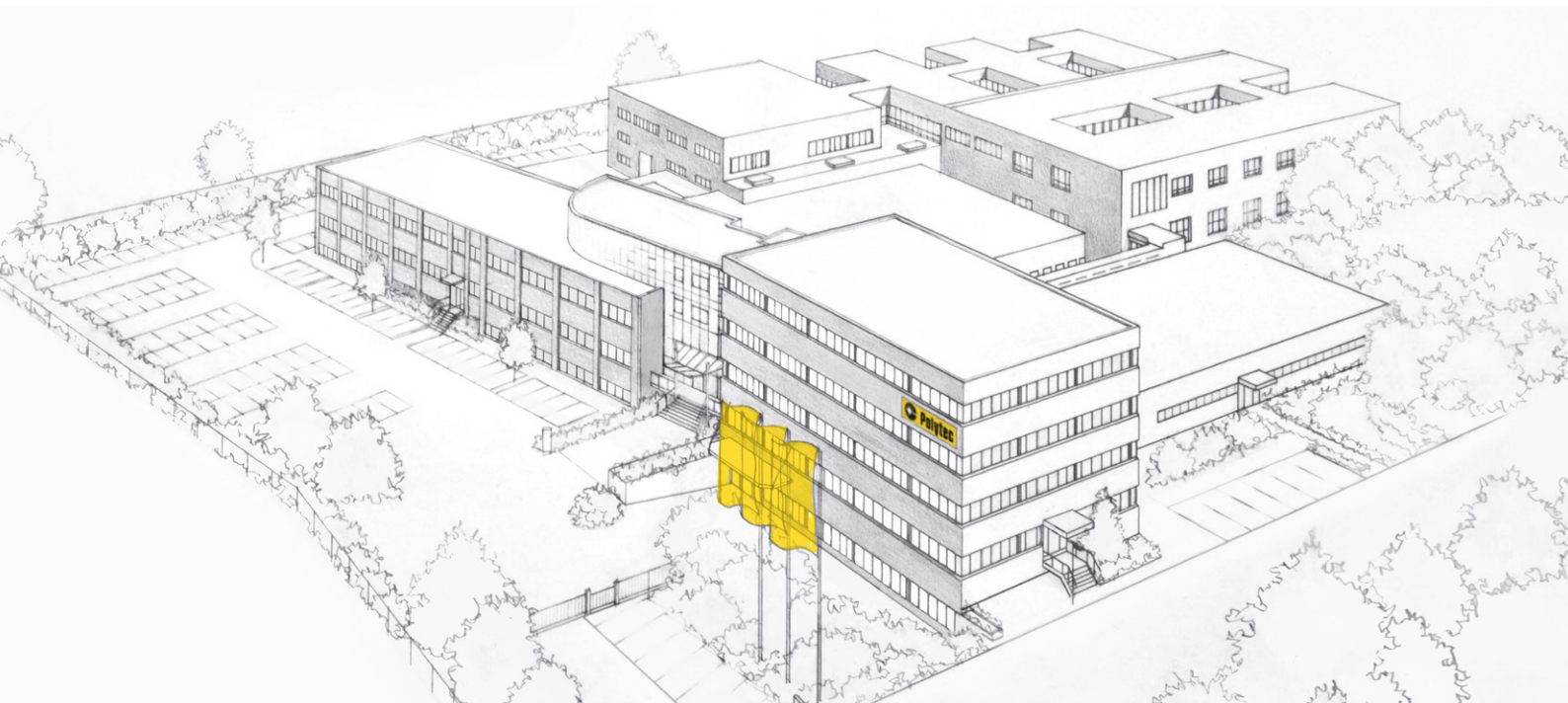

**Polytec, Inc. (USA)**  
North American  
Headquarters  
16400 Bake Parkway  
Suites 150 & 200  
Irvine, CA 92618  
Tel. +1 949 943-3033  
info@polytec.com

**Central Office**  
1046 Baker Road  
Dexter, MI 48130  
Tel. +1 734 253-9428

**East Coast Office**  
1 Cabot Road  
Suites 101 & 102  
Hudson, MA 01749  
Tel. +1 508 417-1040