

CONTACT INFORMATION

| | | | |
|-----------------------------|---------------------|------------------------|--------------|
| _____ | | _____ | |
| DISTRIBUTOR NAME | | DISTRIBUTOR PHONE | |
| _____ | | _____ | |
| DISTRIBUTOR CONTACT NAME | | DISTRIBUTOR ADDRESS | |
| _____ | | _____ | |
| DEALER/BUILDER NAME | | DEALER/BUILDER PHONE | |
| _____ | | _____ | |
| DEALER/BUILDER CONTACT NAME | | DEALER/BUILDER ADDRESS | |
| _____ | | _____ | |
| _____ | _____ | _____ | _____ |
| EMAIL | REFERENCE NUMBER/PO | EST BUILD DATE | CURRENT DATE |
| _____ | | | |
| SIGNATURE | | | |

BYOS2 DESIGN CONSIDERATION

- In your design, provision must be made for future removal of the slide from the substrate if necessary. Flange/gasket connections must be accessible for inspection and maintenance, including but not limited to retightening of fasteners as the slide can move slightly both vertically and horizontally based on the slider's weight and velocity.
- Do not construct objects or formations along or over the slide pathway that obstruct the pathway for sliders or cause potential harm to the head, arms or legs. Minimum recommended head clearance above the slide pathway is 7 feet.
- Minimum BYOS2 water envelope is 7' wide (centered on slide) x 13.5' long x 4.5' deep.
- All BYOS2 products are for in-ground pool installation and use only. S.R.Smith expressly disclaims any and all warranties and liability arising from the installation or use of its BYOS2 products in a non-pool or above-ground pool application or setting.
- S.R.Smith will provide you with a slide system which matches the pathway and spatial requirements you request as closely as possible. It is important to note however, that S.R.Smith does not approve or accept liability for BYOS2 designs. All designs should be reviewed and approved by a licensed Civil or Structural Engineer in your state, and when necessary or required, inspected/approved by the applicable local governing agency.

INSTALLATION TYPE

Residential Commercial

DRAWING

Provide us with a top view drawing of your slide with length and dimensions.

Note: Height, slope and actual length of slide will be adjusted as close to your design as possible. Actual designs may vary.

DIMENSIONS

_____ Entry height above deck
 _____ Exit height above deck
 _____ Estimated centerline length of runway

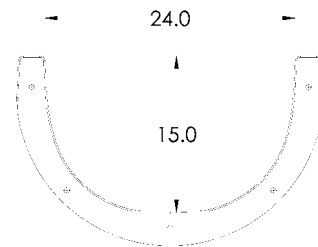

COLOR SELECTION

STANDARD COLORS



SPECIAL ORDER COLORS*

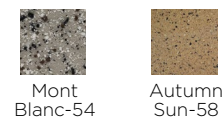

BYOS2 LIABILITY DISCLAIMER

This BYOS2 product provides the customer the opportunity to design a one-of-a-kind slide, unique to the customer's design and specifications. When purchasing this BYOS2 product, the customer acknowledges and agrees that he or she has designed and created the specifications for this product. S.R. Smith makes no claims, representations, or warranties, whether express or implied, for this product when built or used to customer's design and specifications, or this product's safety, reliability, durability or performance when built or used to customer's design and specifications. In no event shall S.R. Smith be liable for any direct, indirect, punitive, incidental, special or consequential damages arising out of or connected with customer's use or misuse of this product.