

Weld On Lifting Points

Weld on lifting points can be welded on any carbon steel surface as a lifting point, or to be used as a fixed anchor point for spreader beam attachment. Weld on lifting points are also commonly used as an anchor point for load restraint application.

- 180 pivot function
- Welding Instructions included with each unit

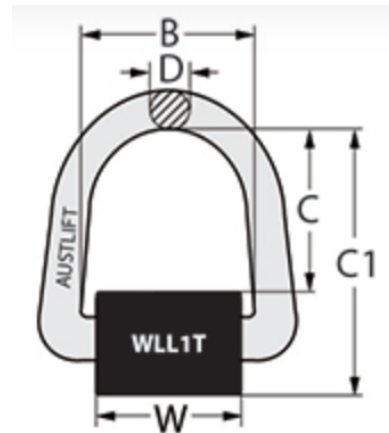
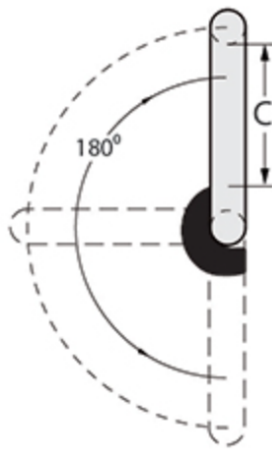
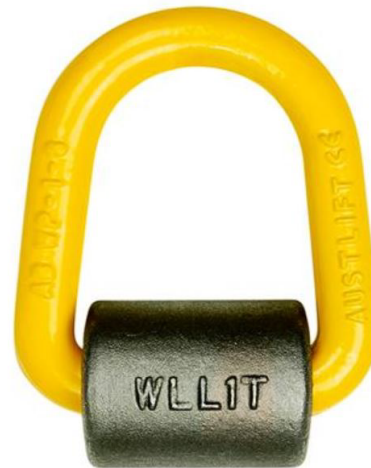

Part No.	WLL (tonnes)	B (mm)	D (mm)	C (mm)	C1 (mm)	W (mm)	Weight (kg)
161101	1t	55	14	35	95.7	50	0.55
161102	3t	64	17	50	99	58	0.9
161103	5t	70	22	70	137	64	1.8
161104	8t	69	26.5	86	144	66.5	2.5

HEAD OFFICE

A. 4 Christensen Rd, Yatala Q 4207
T. 07 3801 6565
W. stenhouselifting.com.au
E. sales@stenhouselifting.com.au

YATALA 07 3801 6565
MARYBOROUGH 07 4122 1193
WACOL 07 3728 4545

