

Low Noise, Water Heater Boosting Pump

Large flow rate, high pressure

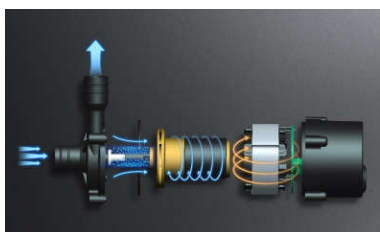

More Stable Flow Rate

High efficiency motor and rotor design, 30% higher efficiency than competitors' with similar size



≤32dB(A), Ultra-quietness Like Breathing

With the same performance, noise is 5-10dB(A) lower



No Leakage, More Reliable

Static sealing design, imported Japanese PPE, strict testing, no leakage forever

TL-C01

Micro DC Brushless Pump

Pressure
2.5Mpa

1M \leq
45dB(A)

FDA

20000H

Standard Version Pump C



Standard Version Pump D



Standard Version Pump E



Selectable Pump A / Pump B / Bracket-X2



Typical Applications

- Water Heater Recirculating System
- “Zero cold water” water heater
- Heating System, Gas Boiler
- Boosting Applications
- HVAC System
- Electric Instant Water Heater
- Cooling Circulation System
- Carbonated Beverage Machine
- Chiller
- General Purpose Pumping

Specification

Model	Product Code	Rated Voltage (VDC)	Max Water Flow (L/min)	Max Water Head (M)	Max Current (A)	Max Power (W)	at Max Efficiency Point	
							Rated Spec. (L/min @ M)	Rated Power (W)
TL-C01-C	TL-C01-C12-2008	12	20	8	2.8	33.6	11,17 @ 4.98	29.64
	TL-C01-C24-2411	24	24	11	2	48	13.26 @ 6.54	46.56
TL-C01-D	TL-C01-D12-1908	12	19	8	3	36	11.03 @ 5.01	34.8
	TL-C01-D24-2211	24	22	11	2	48	11.24 @ 6.68	45.84
TL-C01-E	TL-C01-E12-2008	12	19	8	3	36	10.98 @ 5.22	36.24
	TL-C01-E24-2411	24	24	11	2	48	13.63 @ 6.98	49.2

Customization: 1. /PWM or /5V speed control 2. /FG (RPM) signal wire 3. /S Submersible, liquid \leq 50°C

- The data in the table is the measured performance when pure water is delivered at normal temperature.
- The maximum flow rate is the flow rate when water head is 0 meter, and the highest lift is the lift when water flow is 0 L/min.
- Rated power means the power at the optimum efficiency point.
- Working mode continuous running with 75°C, intermittent running with 100°C
- Noise \leq 45dB(A), the noise is measured from 1m in front of the pump.
- IP level: IP67
- Coil Insulation class: Class F
- Ambient temperature: -40°C ~50°C
- Liquid temperature: -40°C (no-frozen) ~100°C
- Do Not Run Pumps Dry. Pumps must be in a continuous flooded suction environment.

TL-C01

Micro DC Brushless Pump

Pressure
2.5Mpa

1M ≦
45dB

FDA

20000H

Curve

TL-C01-C / E Performance

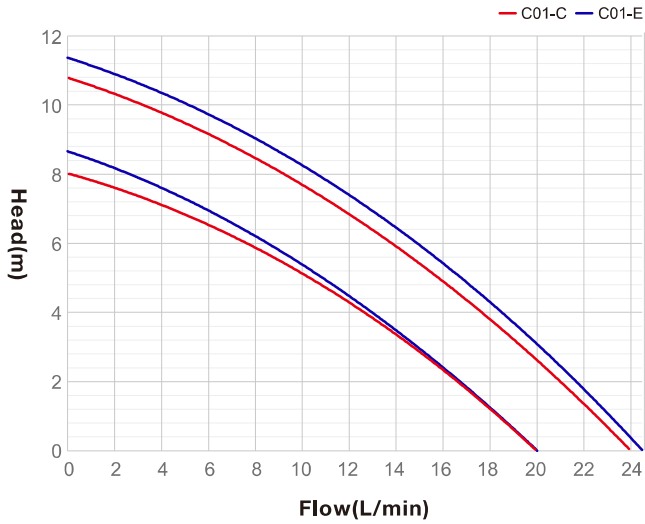

TL-C01-D Performance

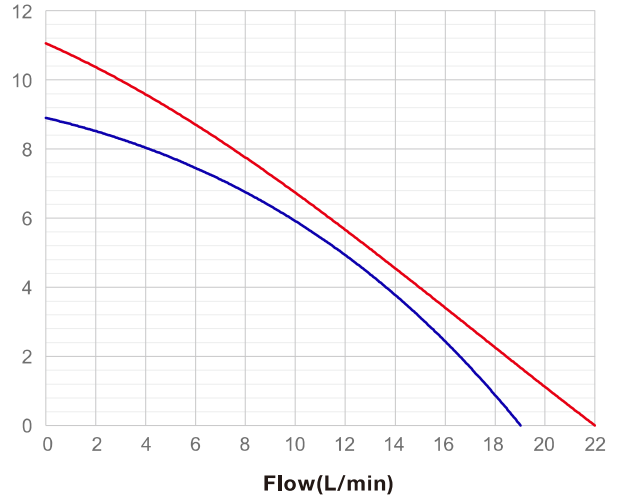

Dimension (mm)

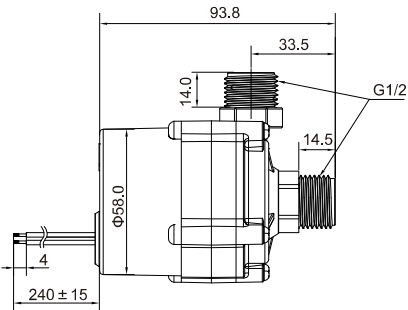

Standard Version Pump C

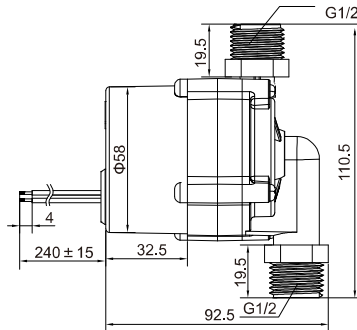

Standard Version Pump D

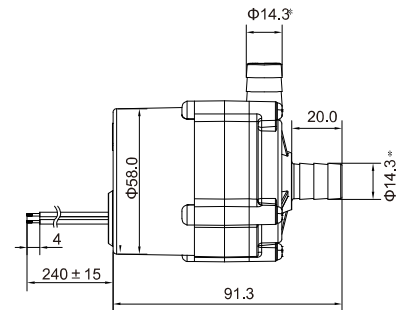

Standard Version Pump E

Selectable Pump A / Pump B / Bracket-X2

