



PD032032

Gearbox Specifications

Outer diameter	32mm	Bearing	Porous bearing	Rolling bearing
Material	Plastic	Axial endplay	≤0.3mm	≤0.3mm
Direction of rotation	cw & ccw	Radial loading on output shaft	≤50N	≤100N
Gear backlash	≤3° Customizable	Operating temperature range	-20 ~ +75°C	

Gearbox Stages

	2	3	4
Reduction ratio	16 / 23 / 33	67 / 94 / 133 / 188	272 / 383 / 541 / 764 / 1078
Max rated torque of gearbox (gf.cm)	30000	30000	30000
Instant torque of gearbox (gf.cm)	80000	80000	80000
Gearbox efficiency (%)	73	65	58
Gearbox length L1 (mm)	35.7	45.7	55.7

Technical Drawing

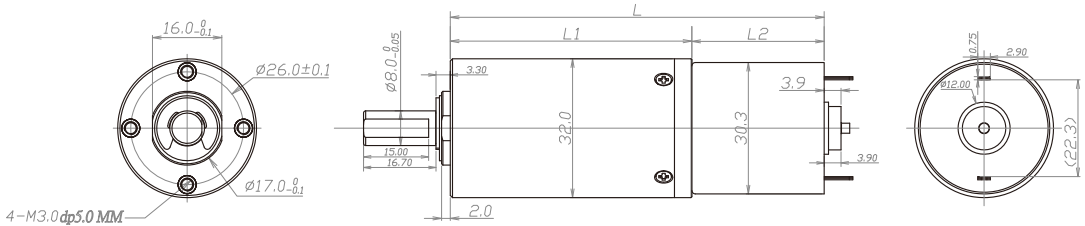

Motor Specifications

Motor type (optional)	Brushed DC motor, Brushless DC motor	Input speed	≤12000rpm
Voltage (optional)	3-24V	Current	300mA max

Parameter (values at 24V & 7700rpm) The following data is for reference only.

Model	Rated Speed	Max Speed	Max Rated Torque	Max Instant Torque	Reduction Ratio	Gearbox Length	Overall Length
	rpm	rpm	gf.cm	gf.cm		mm	mm
PD032032-16	469	1875	30000	80000	16	35.7	78.2
PD032032-23	313	1250	30000	80000	23		
PD032032-33	227	909	30000	80000	33		
PD032032-67	112	448	30000	80000	67	45.7	88.2
PD032032-94	80	319	30000	80000	94		
PD032032-133	56	226	30000	80000	133		
PD032032-188	40	160	30000	80000	188		
PD032032-272	28	110	30000	80000	272	55.7	98.2
PD032032-383	20	78	30000	80000	383		
PD032032-541	14	56	30000	80000	541		
PD032032-764	10	39	30000	80000	764		
PD032032-1078	7	28	30000	80000	1078		

*Please contact us for customized products